

## Refuge Status: Construction-Related Closures

Check our Facebook page <https://www.facebook.com/SanFranciscoBayNWRComplex/> or the San Francisco Bay Wildlife Society Facebook page at <https://www.facebook.com/sanfranciscobaywildlifesociety/> for current information about upcoming online programs.

When you visit, remember to Recreate Responsibly:

- Know before you go.
- Explore locally.
- Leave no trace.

<https://www.fws.gov/refuges/visit/recreate-responsibly.html>

---

## Mountain View Pond A2W Access Route and Construction

Notice to visitors: Construction will begin on July 23, 2025; continuing to mid-January 2026 at Pond A2W and the City of Mountain View's Shoreline Park. Trail closures will be necessary as construction activities occur. A short section of the Bay Trail at the northeastern corner of the park highlighted in red (see Figure 1) will be closed from July 23, 2025 through mid-January 2026. A larger section of the Bay Trail along the southern levee of Pond A2W of the Don Edwards San Francisco Bay National Wildlife Refuge highlighted in orange (see Figure 1) will be closed September 2025 through mid-January 2026.

There is no formal trail detour, but several paved and unpaved alternate routes (shown in solid and dashed brown lines, respectively) are present and will remain open during construction to allow park users to bypass the construction area.

This project will implement a portion of the South Bay Salt Pond Restoration Project's Phase 2 action at Pond A2W within the Alviso-Mountain View Ponds. Additionally, the City of Mountain View will implement a project to add stormwater management features, erosion protection, and raise and improve a low spot in the existing Bay Trail. Construction crews will use the established access route and the previously stockpiled materials to complete the next stage of project construction. Construction will include building habitat enhancements, adding erosion protection, placing stormwater management features, installing bridges, and opening the ponds to tidal flow.

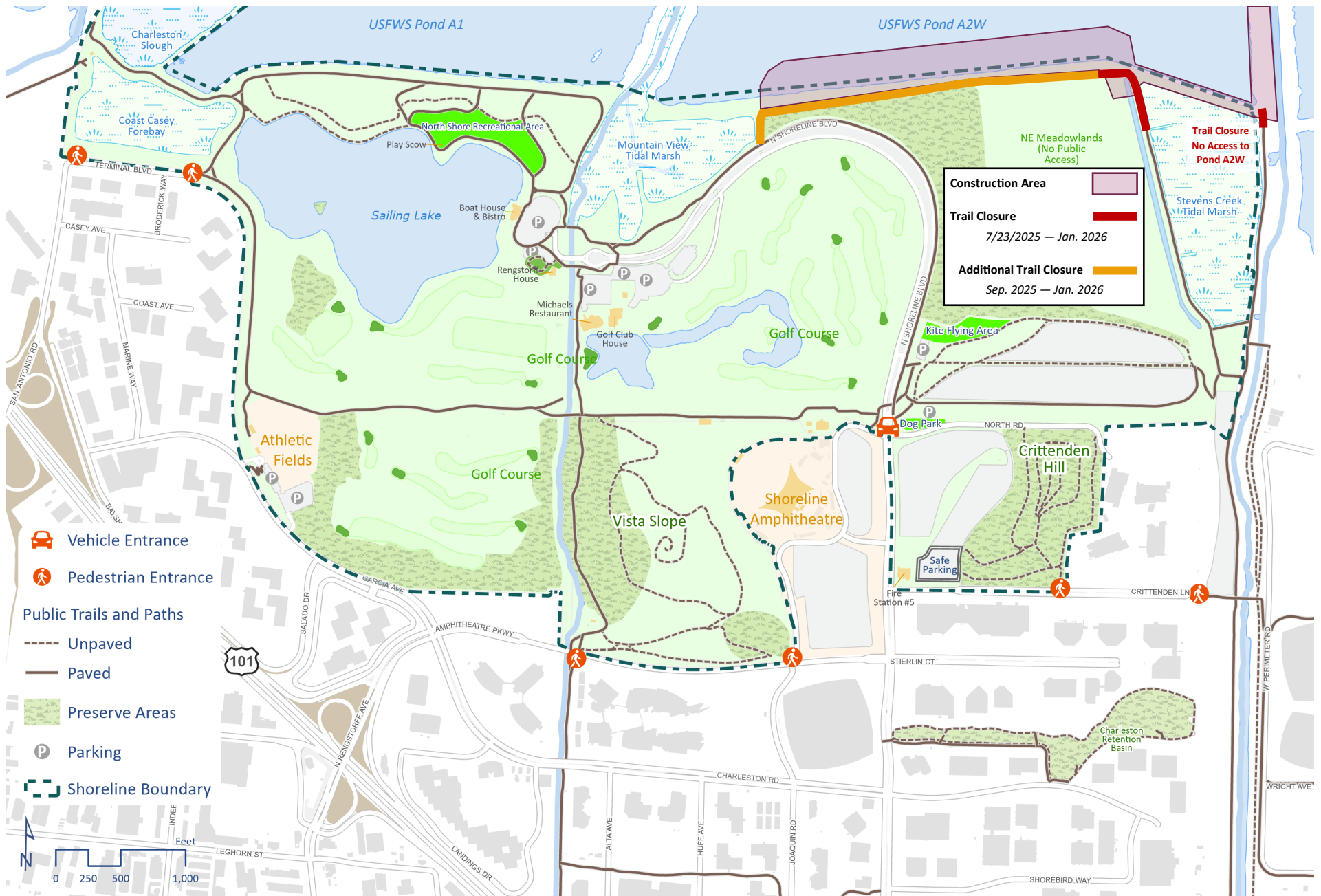

City of  
**Mountain View**

# SHORELINE AT MOUNTAIN VIEW

## UPCOMING BAY TRAIL CLOSURES



2025