



# United States Department of the Interior

## FISH AND WILDLIFE SERVICE

Sand Lake National Wildlife Refuge and Wetland Management District  
39650 Sand Lake Drive  
Columbia, SD 57433



August 1, 2025

Dear Potential Farming Cooperator,

Sand Lake WMD regularly utilizes farming to facilitate grassland restoration activities throughout the district. In 2025, we are soliciting bids to temporarily farm a parcel for a five-year contract from 2025 - 2030. The first of five crops will be planted in the spring of 2026, but site preparation may begin after September 10, 2025. The Nobel unit is approximately 197 acres and is located SE 1/4 Section 9 - 127 - 69. The unit was historically farmed but is currently in grassland that will be hayed prior to September 10, 2025.

The unit will be awarded to the highest successful bidder. The minimum bid that will be accepted is \$78/acre, based on the 2024 average cropland rental rates for McPherson County. The bid price will be made on a per acre basis and remain unchanged for the five year life of the agreement. 25% of the 5-year payment will be required at the time of seeding in the spring 2026 of the agreement and the remaining 75% is due at the termination of the agreement.

Deductions for chemical and/or mechanical breakout, land clearing, or rock picking will be granted at the start of the agreement. Site preparation deductions will be based on current NDSU Extension Custom Farm rates.

Neonicotinoid seed treatment is prohibited from use on refuge lands. Glyphosate tolerance is the only allowable GMO permitted to be planted on refuge lands. All crops and herbicides must be approved by the Refuge Manager prior to use. Due to the limited chemicals that can be used, the preferred rotation would be five consecutive years of non-neonicotinoid glyphosate tolerant soybeans.

Access to the unit is from 107<sup>th</sup> St. A site visit prior to bidding is strongly encouraged. Alternate access from adjacent private land is an option if viable. Unit is scheduled to be hayed in August, please don't drive through area prior to it being hayed.

Sealed bids must be received by Noon, Friday August 22, 2025. For additional information about this agricultural opportunity contact me at 605-546-8913.

Thank You

Nate Williams

District Manager

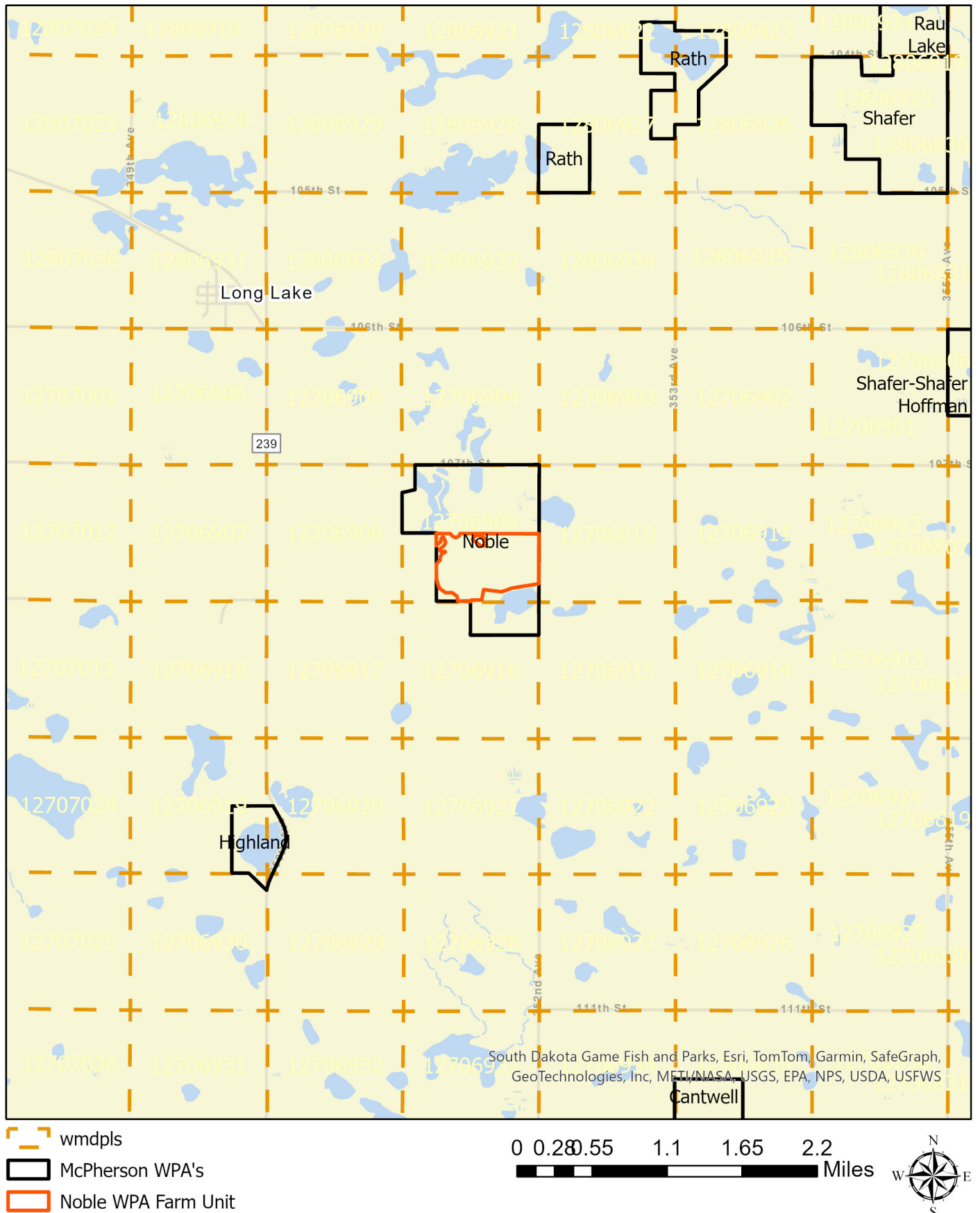





Noble WPA Farming Unit  
McPherson Co. South Dakota  
127-69-09



Legend

- wmdpls
- McPherson WPA's
- Noble WPA Farm Unit

2025 Farm Unit Acreage 197 acres

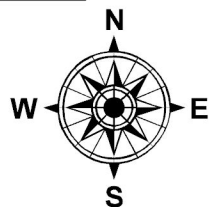



UNITED STATES DEPARTMENT OF THE INTERIOR  
FISH AND WILDLIFE SERVICE  
Sand Lake NATIONAL WILDLIFE REFUGE and WETLAND MANAGEMENT  
DISTRICT  
39650 SAND LAKE DR  
COLUMBIA SD, 57433  
605-546-8913

**Application and Bid for 2025 – 2030 Cooperative Agricultural Agreement**

**Only sealed bid sheets will be accepted through Noon, Friday August 22, 2025**

Name \_\_\_\_\_ Application Date \_\_\_\_\_  
Address \_\_\_\_\_ Telephone No. \_\_\_\_\_  
City, Zip Code \_\_\_\_\_

Sand Lake NWR is soliciting bids to temporarily farm a parcel for a five-year contract (2025-2030). The minimum bid that will be accepted is **\$78/acre**, based on the 2024 average cropland rental rates for McPherson County. The bid price will be made on a per acre basis and remain unchanged for the five year life of the agreement. 25% of the 5-year payment will be required at the time of seeding in year one of the agreement and the remaining 75% is due at the termination of the agreement.

The unit will be awarded to the highest successful bidder. Site preparation may begin after September 10, 2025. Deductions for chemical or mechanical breakout, land clearing, or rock picking in first year of agreement may be granted.

Neonicotinoid seed treatment is prohibited from use on refuge lands. Glyphosate tolerance is the only allowable GMO permitted to be planted on refuge lands.

All crops and herbicides must be approved by the Refuge Manager prior to use. Due to the limited chemicals that can be used, a preferred rotation would be five consecutive years of non-neonicotinoid glyphosate tolerant soybeans.

**Successful bidder(s) may be awarded one or both of the units based on bid and interest.**

Tract	Acres	Legal Description	\$Bid/Acre
Noble WPA	197	Sec 9 – 127 - 69	

Bidder's Signature \_\_\_\_\_ Date: \_\_\_\_\_