



REPLY TO
ATTENTION OF

DEPARTMENT OF THE ARMY
JACKSONVILLE DISTRICT CORPS OF ENGINEERS
1002 WEST 23RD STREET, SUITE 350
PANAMA CITY, FLORIDA 32405

November 1, 2017

Regulatory Division
North Permits Branch
Panama City Permits Section
SAJ-2006-01340(MOD-LSL)
Modification-2

Mr. Robert Cox
Mexico Beach Reef Association
118 North 14th Street
Mexico Beach, Florida 32410

Dear Mr. Cox:

The U.S. Army Corps of Engineers (Corps) has completed the review and evaluation of your modification request, received on November 10, 2015, in which you asked to revise the plans authorized by Department of the Army permit number SAJ-2006-01340, issued to City of Mexico Beach, dated November 21, 2001. By letter dated March 18, 2011, the permit was modified to expire on November 27, 2016. The project site is located at in the Gulf of Mexico between the City of Mexico Beach and Port St. Joe, Florida.

The proposed modification is to extend the expiration date to complete your proposed project. This authorization is hereby extended for 5 years from the date of this letter.

The impact of your proposal on navigation and the environment has been reviewed and found to be insignificant. The permit is hereby modified in accordance with your request. You should attach this letter to the permit. All other conditions of the permit remain in full force and effect.

If you have any questions concerning this permit modification, please contact the project manager Mrs. Lisa S. Lovvorn at the letterhead address, by telephone at 850-763-0717, extension 27, or by electronic mail at lisa.s.lovvorn@usace.army.mil.

Thank you for your cooperation with our permit program. The Corps' Jacksonville District Regulatory Division is committed to improving service to our customers. We strive to perform our duty in a friendly and timely manner while working to preserve our environment. We invite you to complete our automated Customer Service Survey at http://corpsmapu.usace.army.mil/cm_apex/f?p=regulatory_survey. Please be aware this Internet address is case sensitive; and, you will need to enter it exactly as it appears above. Your input is appreciated – favorable or otherwise.

BY AUTHORITY OF THE SECRETARY OF THE ARMY:

for Jason A. Kirk, P.E.
Colonel, U.S. Army
District Commander

Enclosures

Copy Furnished:
Mr. Clayton Studstill, Garlick Associates, Inc.

NOTIFICATION OF ADMINISTRATIVE APPEAL OPTIONS AND PROCESS AND REQUEST FOR APPEAL

Applicant: Mexico Beach Reef Association	File Number: SAJ-2006-01340	Date: 11/1/2017
Attached is:		See Section below
	INITIAL PROFFERED PERMIT (Standard Permit or Letter of permission)	A
	PROFFERED PERMIT (Standard Permit or Letter of permission)	B
	PERMIT DENIAL	C
	APPROVED JURISDICTIONAL DETERMINATION	D
	PRELIMINARY JURISDICTIONAL DETERMINATION	E

SECTION I - The following identifies your rights and options regarding an administrative appeal of the above decision. Additional information may be found at http://www.usace.army.mil/CECW/Pages/reg_materials.aspx or Corps regulations at 33 CFR Part 331.

A: INITIAL PROFFERED PERMIT: You may accept or object to the permit.

- **ACCEPT:** *If you received a Standard Permit, you may sign the permit document and return it to the district engineer for final authorization. If you received a Letter of Permission (LOP), you may accept the LOP and your work is authorized. Your signature on the Standard Permit or acceptance of the LOP means that you accept the permit in its entirety, and waive all rights to appeal the permit, including its terms and conditions, and approved jurisdictional determinations associated with the permit.*
- **OBJECT:** If you object to the permit (Standard or LOP) because of certain terms and conditions therein, you may request that the permit be modified accordingly. You must complete Section II of this form and return the form to the district engineer. Your objections must be received by the district engineer within 60 days of the date of this notice, or you will forfeit your right to appeal the permit in the future. Upon receipt of your letter, the district engineer will evaluate your objections and may: (a) modify the permit to address all of your concerns, (b) modify the permit to address some of your objections, or (c) not modify the permit having determined that the permit should be issued as previously written. After evaluating your objections, the district engineer will send you a proffered permit for your reconsideration, as indicated in Section B below.

B: PROFFERED PERMIT: You may accept or appeal the permit

- **ACCEPT:** *If you received a Standard Permit, you may sign the permit document and return it to the district engineer for final authorization. If you received a Letter of Permission (LOP), you may accept the LOP and your work is authorized. Your signature on the Standard Permit or acceptance of the LOP means that you accept the permit in its entirety, and waive all rights to appeal the permit, including its terms and conditions, and approved jurisdictional determinations associated with the permit.*
- **APPEAL:** If you choose to decline the proffered permit (Standard or LOP) because of certain terms and conditions therein, you may appeal the declined permit under the Corps of Engineers Administrative Appeal Process by completing Section II of this form and sending the form to the division engineer. This form must be received by the division engineer within 60 days of the date of this notice.

C: PERMIT DENIAL: You may appeal the denial of a permit under the Corps of Engineers Administrative Appeal Process by completing Section II of this form and sending the form to the division engineer. This form must be received by the division engineer within 60 days of the date of this notice.

D: APPROVED JURISDICTIONAL DETERMINATION: You may accept or appeal the approved JD or provide new information.

- **ACCEPT:** *You do not need to notify the Corps to accept an approved JD. Failure to notify the Corps within 60 days of the date of this notice, means that you accept the approved JD in its entirety, and waive all rights to appeal the approved JD.*
- **APPEAL:** If you disagree with the approved JD, you may appeal the approved JD under the Corps of Engineers Administrative Appeal Process by completing Section II of this form and sending the form to the division engineer. This form must be received by the division engineer within 60 days of the date of this notice.

E: PRELIMINARY JURISDICTIONAL DETERMINATION: You do not need to respond to the Corps regarding the preliminary JD. The Preliminary JD is not appealable. If you wish, you may request an approved JD (which may be appealed), by contacting the Corps district for further instruction. Also you may provide new information for further consideration by the Corps to reevaluate the JD.

SECTION II - REQUEST FOR APPEAL or OBJECTIONS TO AN INITIAL PROFFERED PERMIT

REASONS FOR APPEAL OR OBJECTIONS: (Describe your reasons for appealing the decision or your objections to an initial proffered permit in clear concise statements. You may attach additional information to this form to clarify where your reasons or objections are addressed in the administrative record.)

ADDITIONAL INFORMATION: The appeal is limited to a review of the administrative record, the Corps memorandum for the record of the appeal conference or meeting, and any supplemental information that the review officer has determined is needed to clarify the administrative record. Neither the appellant nor the Corps may add new information or analyses to the record. However, you may provide additional information to clarify the location of information that is already in the administrative record.

POINT OF CONTACT FOR QUESTIONS OR INFORMATION:

If you have questions regarding this decision and/or the appeal process you may contact:

Project Manager as noted in letter

If you only have questions regarding the appeal process you may also contact:

**Jason Steele
404-562-5137**

RIGHT OF ENTRY: Your signature below grants the right of entry to Corps of Engineers personnel, and any government consultants, to conduct investigations of the project site during the course of the appeal process. You will be provided a 15 day notice of any site investigation, and will have the opportunity to participate in all site investigations.

Signature of appellant or agent.

Date:

Telephone number:



**DEPARTMENT OF THE ARMY
 JACKSONVILLE DISTRICT CORPS OF ENGINEERS
 1002 WEST 23RD STREET, SUITE 350
 PANAMA CITY, FLORIDA 32405**

March 18, 2011

REPLY TO
 ATTENTION OF

North Permits Branch
 Panama City Section
 SAJ-2006-01340 (IP-MMW)
 Modification-1

Mexico Beach, City of
 118 North 14th Street
 Mexico Beach, Florida 32410

Dear Applicant:

The U.S. Army Corps of Engineers has completed the review and evaluation of your modification request received December 17, 2010 in which you asked to revise the plans authorized by Department of the Army permit number SAJ-2006-01340 (IP-MMW), for five one-square mile artificial reef areas, dated November 27, 2006.

The artificial reef sites are located offshore in the Gulf of Mexico, between the City of Mexico Beach and Port St. Joe, Florida.

LATITUDE & LONGITUDE:

	Latitude	Longitude
North Site		
Corner #1	29 47.250	-85 42.750
Corner #2	29 47.250	-85 41.600
Corner #3	29 46.250	-85 41.600
Corner #4	29 46.250	-85 42.750

	Latitude	Longitude
Bridge Span 11 Site		
Corner #1	29 45.000	-85 42.750
Corner #2	29 45.000	-85 41.600
Corner #3	29 44.000	-85 41.600
Corner #4	29 44.000	-85 42.750

South Site		
Corner #1	29 43.000	-85 41.600
Corner #2	29 43.000	-85 40.445
Corner #3	29 44.000	-85 40.445
Corner #4	29 44.000	-85 41.600

Bridge Rubble Site		
Corner #1	29 46.600	-85 37.000
Corner #2	29 46.600	-85 35.850
Corner #3	29 45.600	-85 35.850
Corner #4	29 45.600	-85 37.000

Tower Site		
Corner #1	29 44.200	-85 29.425
Corner #2	29 44.200	-85 28.275
Corner #3	29 43.200	-85 28.275
Corner #4	29 43.200	-85 29.425

The proposed modification is to extend the expiration date by five years. **This authorization is hereby extended until November 27, 2016.** The work must be completed in accordance with the enclosed drawings and attachments, and the following special conditions, which are incorporated in, and made a part of the permit.

1. Reporting Addresses: The Permittee shall reference this permit number, SAJ-2006-03140 (IP-MMW), on all correspondence. Unless specifically notified to the contrary, the Permittee shall use the following addresses for transmitting correspondence to the referenced agencies:

(a) U.S. Army Corps of Engineers (Corps)
Regulatory Division, Special Projects and Enforcement Branch
41 North Jefferson Street, Suite 301
Pensacola, Florida 32501
email: CESAJ-ComplyDocs@usace.army.mil

(b) National Oceanic and Atmospheric Administration (NOAA)
Office of Coast Survey, N/CS26, Sta. 7317
1315 East-West Highway
Silver Springs, MD, 20910-3282

(c) Commander, U.S. Coast Guard (USCG)
Eighth Coast Guard District
Hale Boggs Federal Building
500 Poydras Street
New Orleans, LA 70130-3310

(d) Florida Fish and Wildlife Conservation Commission (FWC)
Artificial Reef Program
620 S. Meridian Street, Box 4B2
Tallahassee, FL 32399.
fax: 850-922-0463
email: Jon.Dodrill@myfwc.com, bill.horn@myfwc.com,
and keith.mille@myfwc.com

2. Initial Agency Notification: The Permittee shall provide to the Corps, NOAA and USCG written notification of the planned deployment start date at least two weeks prior to the initial deployment on the authorized artificial reef site.

3. Authorized Reef Materials: No reef materials or module will weigh less than 500 pounds. Reef materials shall be clean and free from asphalt, petroleum, other hydrocarbons and toxic residues, loose free floating material or other deleterious substances. All

artificial reef materials and/or structures will be selected, designed, constructed and deployed to create, stable and durable marine habitat. The Permittee shall deploy only the following authorized reef materials:

- a. Prefabricated artificial reef modules composed of ferrous and/or aluminum-alloy metals $\frac{1}{4}$ " or more in thickness, concrete, rock or a combination of these materials.
- b. Natural rock boulders and other pre-cast concrete material, such as, culverts, stormwater junction boxes, power poles, railroad ties, jersey barriers, or other similar concrete material.
- c. Clean steel and concrete bridge or large building demolition materials such as slabs or pilings with all steel reinforcement rods severed as close to the concrete surface as possible but not to extend more than 6 inches to ensure the rod will not create a fishing tackle or diver ensnaring hazard.
- d. Heavy gauge ferrous & aluminum alloy metal material components or structures, $\frac{1}{4}$ " or more in thickness, such as utility poles, antenna towers.
- e. Heavy gauge ferrous & aluminum alloy metal hulled vessels which equal or exceed 60 ft. hull length prepared and deployed in accordance with all applicable U. S. Coast Guard, U.S. Environmental Protection Agency, Florida Fish and Wildlife Conservation Commission, or other applicable state or federal agency regulations or policies. The vessel shall not be deployed until all necessary inspections and clearances have been obtained or waived and a stability analysis has been completed demonstrating that the vessel will be stable during a 50-year storm event based on vessel and deployment site characteristics. The permittee shall follow the National guidance regarding preparation of vessels for deployment as artificial reefs which are available at:
<http://www.epa.gov/owow/oceans/habitat/artificialreefs/index.html>
The Permittee shall maintain a record of all inspections, clearances or waivers and provide to the Corps upon request.

4. Authorized Clearance: Except for the area known as the Tower Site, which has a charted obstruction at 20' clearance, the permittee shall maintain a minimum 40 foot vertical clearance above all deployed reef materials, measured at mean low water.

5. Marine Life Entrapment: Neither reef structure nor material or the method of design or deployment should pose a risk of entrapping fish, marine turtles, or marine mammals. Any observation of entrapped marine turtles or marine mammals on this artificial reef site must be reported immediately to the Corps and FWC.

6. Protection of Existing Resources: The Permittee shall not deploy artificial reef materials until an assessment of the bottom conditions have been accomplished by diver, submersible video camera, fathometer, depth/bottom sounder (e.g. "fish finder"), or side-scan sonar. The inspection of the deployment area may occur at the time of deployment, but no more than one year prior to deployment. The Permittee shall maintain a deployment buffer of at least 200 feet from any submerged beds of sea grasses, coral reefs, live bottom, areas supporting growth of sponges, sea fans, soft corals, and other sessile macroinvertebrates generally associated with rock outcrops, oyster reefs, scallop beds, clam beds, or areas where there are unique or unusual concentrations of bottom-dwelling marine organisms. If, during the inspection, evidence is observed of cultural/archaeological resources, such as sunken vessels, ballast, historic refuse piles, or careenage areas the Corps will be notified by the Permittee and the above referenced deployment buffer will be implemented. The Permittee shall maintain a record of the information gained during the inspection such that it can be provided upon request to the Corps.

7. Pre-Deployment Notification: No less than 14 days prior to deployment of material on an artificial reef, the Permittee shall transmit by electronic mail ("email") a complete and signed "*Florida Artificial Reef Materials Cargo Manifest and Pre-Deployment Notification*" form, provided in Attachment #1 of this permit, to the Corps and FWC to allow inspection of the proposed reef materials as deemed necessary by the agencies. Inspection is allowable at the staging area. By signing the Pre-Deployment Notification the Permittee certifies that all materials are free from asphalt, petroleum, other hydrocarbons and toxic residues. The Permittee shall not deploy material if notified by the Corps or FWC that the material is questionable. The material needs to be evaluated before it is released for deployment. Any material that is deemed unacceptable for reef material will be disposed in an approved upland disposal site.

Deployment of the material shall not occur until after the end of the 14-day inspection period. The Permittee shall ensure both a copy of the Corps permit and the signed "*Florida Artificial Reef Materials Cargo Manifest and Pre-Deployment Notification Form*" are maintained

aboard the deployment vessel at all times during loading, transit, and deployment.

8. Post-Deployment Placement Report/As-Built Drawing: No less than 30 days after deployment at the reef site, the Permittee shall transmit by email to the Corps and FWC a complete and signed "*Florida Artificial Reef Materials Placement Report and Post-Deployment Notification*" form provided in Attachment #2 of this permit. Please note, the Corps requires the latitude and longitude to be accurate within 5 meters horizontal distance on the post-deployment report. Attach to the report, an as-built drawing that contains the approximate deployment configurations and the height of the material after placement. Depth shall be verified utilizing fathometer, depth sounder, or similar device accurate to within 1 meter. Also, include information on the condition of the material at the time of deployment. The report and drawing shall be limited to a few pages per deployment. Representative photographs and/or video, if available, are encouraged to be submitted.

9. Ownership/Maintenance/Liability: By signing this permit, the Permittee certifies and acknowledges ownership of all artificial reef materials deployed on the reef, accepts responsibility for maintenance of the artificial reef, and possesses the ability to assume liability for all damages that may arise with respect to the artificial reef.

10. Assurance of Navigation and Maintenance: The Permittee understands and agrees that, if future operations by the United States require the removal, relocation, or other alteration, of the structures or work herein authorized, or if in the opinion of the Secretary of the Army or his authorized representative, said structure or work shall cause unreasonable obstruction to the free navigation of the navigable waters, the Permittee will be required, upon due notice from the Corps of Engineers, to remove, relocate, or alter the structural work or obstructions caused thereby, without expense to the United States. No claim shall be made against the United States on account of any such removal or alteration.

11. Sea Turtle/Sawfish/Sturgeon Guidelines: The Permittee shall comply with the National Marine Fisheries Service's "*Sea Turtle and Smalltooth Sawfish Construction Conditions*", which also applies to sturgeon, provided in Attachment #3 of this permit.

12. Manatee Conditions: The Permittee shall comply with the "*Standard Manatee Conditions for In-Water Work - July 2005*" provided in Attachment #4 of this permit.

13. Private Aids to Navigation: You must install and maintain, at your expense, any private aids to navigation applicable to your permitted activity, as required by the United States Coast Guard. Contact the Eighth Coast Guard District, Private Aids to Navigation Section, 500 Poydras St., Suite 1230, New Orleans, LA 70130. Phone: (504) 671-2328. D8OANPaton@D8.uscg.mil

The impact of your proposal on navigation and the environment has been reviewed and found to be insignificant. The permit is hereby modified in accordance with your request. You should attach this letter to the permit. All other conditions of the permit remain in full force and effect.

If you have any questions concerning permit modification, please contact the project manager Melinda Witgenstein at the letterhead address, by telephone at (850) 763-0717, extension 24, or by electronic mail at melinda.m.witgenstein@usace.army.mil.

Thank you for your cooperation with our permit program. The Corps Jacksonville District Regulatory Division is committed to improving service to our customers. We strive to perform our duty in a friendly and timely manner while working to preserve our environment. We invite you to take a few minutes to visit <http://per2.nwp.usace.army.mil/survey.html> and complete our automated Customer Service Survey. Your input is appreciated - favorable or otherwise. Please be aware this web address is case sensitive and should be entered as it appears above.

BY AUTHORITY OF THE SECRETARY OF THE ARMY:

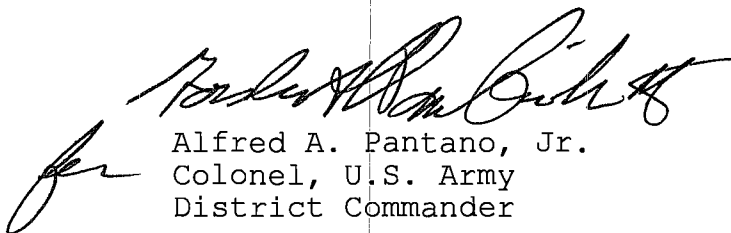
Alfred A. Pantano, Jr.
Colonel, U.S. Army
District Commander

Enclosure

Copies Furnished:
Garlick Environmental, Apalachicola
FWC, Tallahassee
CESAJ-RD-PE



**FLORIDA ARTIFICIAL REEF MATERIALS
CARGO MANIFEST AND PRE-DEPLOYMENT NOTIFICATION
(Issued pursuant to Ch. 370.25(6)(b), Florida Statutes)**



I, _____
Name of individual managing reef deployment (print) Signature Date

whose address is _____ (____) _____
Street City State Zip Code Phone

declare that I am staging and transporting the following artificial reef construction materials allowable pursuant to the U.S. Army Corps of Engineers Artificial Reef Permit referenced below and agree to comply with all permit conditions in the permit listed below and attached to this manifest. I understand this artificial reef site is open to public access and this authorization does not provide any rights or exclusive private use over those rights or uses to the general public.

The address of the land based reef materials staging area is: _____

Transporting Vessel Registration Number: _____

Vessel Owner: _____ Vessel Operator: _____

The following items are to be deployed as reef material (attach additional sheets when more than four locations):

MATERIAL TAG ID NUMBER(S), if applicable	Descriptions of material (number of pieces, type, dimension, weight)	GPS Coordinates degrees, minutes, decimal minutes (DD°MM.mmm')
		Lat: _____ ° _____ ' _____ ' Lon: _____ ° _____ ' _____ '
		Lat: _____ ° _____ ' _____ ' Lon: _____ ° _____ ' _____ '
		Lat: _____ ° _____ ' _____ ' Lon: _____ ° _____ ' _____ '
		Lat: _____ ° _____ ' _____ ' Lon: _____ ° _____ ' _____ '

A copy of the below referenced permit(s) and all associated conditions is attached to this manifest and shall be carried on board the vessel during loading, storing, or transporting artificial reef materials.

-- OFFICIAL USE ONLY --
(TO BE COMPLETED BY PERMIT HOLDER, OR AUTHORIZED ARTIFICIAL REEF INSPECTOR)

Permit Holder: _____
Name of U.S. Department of the Army, Corps of Engineers (ACOE) Permit Holder

ACOE permit number _____, permitted site name _____

issued on _____ and has an expiration date of _____

Local tracking number (if applicable): _____

_____ (Name of FWC authorized Artificial Reef Inspector, printed)

_____ (Signature) _____ (Date)

Mexico Beach, City of Five 1 square-mile reefs
SAJ-2006-01340 (IP-MMW)
Modification #1 - March 18, 2011
Attachment #1 - Pre-Deployment Notification
Sheet 1 of 2

EXPLANATION SHEET FOR THE ARTIFICIAL REEF MATERIALS CARGO MANIFEST FORM

The attached artificial reef cargo manifest has been developed in compliance with subsection 370.25 (6)(b), Florida Statutes, which states that:

"It is unlawful for any person to: store, possess or transport on or across state waters any materials reasonably suited for artificial reef construction and stored in such a manner providing ready access for use and placement as an artificial reef, unless a valid cargo manifest issued by the commission or a commission-certified inspector is onboard the transporting vessel. The manifest will serve as authorization to use a valid permitted site or land-based staging area, which will validate that the type of artificial reef construction material being transported is permissible for use at the permitted site, and will describe and quantify the artificial reef material being transported. The manifest will also include the latitude and longitude coordinates of the proposed deployment location, the valid permit number, and the copy off the permit conditions for the permitted site. The manifest must be available for inspection by any authorized law enforcement officer or commission employee."

This requirement for a cargo manifest became part of the statutory revision of the artificial reef program statute Section 370.25 Florida Statutes (F.S.), modified during the 2000 State of Florida Legislature. The statutory language allows a "commission certified inspector" to complete and approve the artificial reef materials cargo manifest. Therefore, we are providing the attached cargo manifest form to all local coastal government artificial reef coordinators and eligible non-profit corporations who may physically construct artificial reefs with the approval of the permit holders.

INSTRUCTIONS

A separate cargo manifest form is to be completed for each load to be transported offshore (i.e., one manifest per voyage). The manifest is to list all, and only, the reef materials onboard.

The top of the form is to be filled out by the reef builder with his/her contact information and the information about the proposed reef materials to be deployed written into the boxes. If several materials are identical but have different tag numbers, please write "SAME" in the box for the other materials. Also put "SAME" under additional coordinates if all materials are going to the same deployment site.

The shaded portion of the form at the bottom is to be filled out by the materials inspector. The cargo manifest must be completed by an entity representing the holder of the applicable artificial reef permit to assure that all materials meet the requirements of the permit.

Completion of the artificial reef materials cargo manifest is required for all construction activity

The requirement to complete this document is not intended to be an undue burden on entities wishing to legally construct artificial reefs within permitted sites, but is a tool to assist law enforcement personnel in preventing the illegal construction of artificial reefs without the knowledge of the permit holder or in areas outside of legally permitted sites. It is intended to allow law enforcement staff to determine whether or not a load of materials is legal under the permit conditions. Without a properly completed Manifest Form on board, reef builders will be returned to port pursuant to Chapter 370.25 (6) (b). It is necessary to send a copy of the Cargo Manifest Form to the FWC artificial reef section in Tallahassee. Documentation of the reef building activity should be maintained by the entity issuing the manifest in the event of any FWC inquiries.

Reminder: the placement of all public artificial reefs in state or adjacent federal waters requires the submittal of a Materials Placement Report to the FWC artificial reef program within 30 days of public deployment in accordance with s. 370.25 F.S.

exico Beach, City of Five 1 square-mile reefs
AJ-2006-01340 (IP-MMW)
modification #1 - March 18, 2011
attachment #1 - Pre-Deployment Notification
sheet 2 of 2



FLORIDA ARTIFICIAL REEF MATERIALS PLACEMENT REPORT AND POST-DEPLOYMENT NOTIFICATION



To Be Completed For Each Deployment Location or Date of Deployment

County or Municipality: _____

Date of Placement: _____

Grant No. FWC - _____
(if applicable)

U.S. Army Corps
Permit No.: _____

Total project cost: \$ _____

Funding Source(s) and Amount(s): FWC \$ _____ Local \$ _____ Other \$ _____

Name of Permitted Reef Site: _____

Location Name for This Deployment: _____

Latitude: _____ ° _____ ' North
(degrees, minutes, decimal minutes (DD°MM.mmm'))

Longitude: _____ ° _____ ' West
(degrees, minutes, decimal minutes (DD°MM.mmm'))

GPS Brand and Model Number: _____

Geographical Location: _____ at _____ degrees from _____
(nautical miles) (bearing) (reference inlet)

Water Depth: _____ feet - Maximum Material Height: _____ feet = Minimum Vertical Clearance: _____ feet

TYPE AND AMOUNT OF MATERIAL DEPLOYED AT THE LOCATION DESCRIBED ABOVE:
(ATTACH A PHOTOGRAPH OF THE MATERIAL ON THE BARGE IMMEDIATELY PRIOR TO DEPLOYMENT)

Primary Type of Material: _____ Number of Pieces: _____

Dimensions: _____

Secondary Type of Material: _____ Number of Pieces: _____

Dimensions: _____

TOTAL TONNAGE FOR THIS DEPLOYMENT: _____

I DO HEREBY CERTIFY THAT THE ABOVE INFORMATION IS TRUE AND CORRECT TO THE BEST OF MY KNOWLEDGE

Observer's Name: _____
(PLEASE PRINT)

Title: _____
(PLEASE PRINT)

Observer's Signature: _____

Date: _____

Observer's Remarks: _____

I DO HEREBY CERTIFY THAT THE ABOVE INFORMATION COMPLIES WITH THE ABOVE REFERENCED PERMIT COND

Permittee's Staff Name: _____
(PLEASE PRINT)

Title: _____
(PLEASE PRINT)

Permittee's Staff Signature: _____

Date: _____

Local Tracking number _____ FWC Tracking number _____ Entered by _____ on _____ date

Mexico Beach, City of Five 1 square-mile reefs
 SAJ-2006-01340 (IP-MMW)
 Modification #1 - March 18, 2011
 Attachment #2 - Post-Deployment Notification
 Sheet 1 of 2

FOR GRANT-FUNDED REEFS, the following data will be recorded at the staging area prior to and after the deployment. This formula represents an average, single rake barge and may not represent the exact tonnage of materials placed. USING THIS FORMULA FOR PAYMENT OF TRANSPORTATION COSTS SHOULD BE AGREED UPON IN ADVANCE WITH A CONTRACTOR.

Barge Length: _____ feet Barge Width: _____ feet Loaded Draft: _____ feet Unloaded Draft: _____ feet
(Length X Width X Loaded Draft X 0.93 X 65) = 2,000 = _____ (Loaded barge weight in tons)
(Length X Width X Unloaded Draft X 0.93 X 65) = 2,000 = _____ (Unloaded barge weight in tons)
TOTAL TONNAGE FOR THIS DEPLOYMENT = _____



UNITED STATES DEPARTMENT OF COMMERCE
National Oceanic and Atmospheric Administration
NATIONAL MARINE FISHERIES SERVICE
Southeast Regional Office
263 13th Avenue South
St. Petersburg, FL 33701

SEA TURTLE AND SMALLTOOTH SAWFISH CONSTRUCTION CONDITIONS

The permittee shall comply with the following protected species construction conditions:

- a. The permittee shall instruct all personnel associated with the project of the potential presence of these species and the need to avoid collisions with sea turtles and smalltooth sawfish. All construction personnel are responsible for observing water-related activities for the presence of these species.
- b. The permittee shall advise all construction personnel that there are civil and criminal penalties for harming, harassing, or killing sea turtles or smalltooth sawfish, which are protected under the Endangered Species Act of 1973.
- c. Siltation barriers shall be made of material in which a sea turtle or smalltooth sawfish cannot become entangled, be properly secured, and be regularly monitored to avoid protected species entrapment. Barriers may not block sea turtle or smalltooth sawfish entry to or exit from designated critical habitat without prior agreement from the National Marine Fisheries Service's Protected Resources Division, St. Petersburg, Florida.
- d. All vessels associated with the construction project shall operate at "no wake/idle" speeds at all times while in the construction area and while in water depths where the draft of the vessel provides less than a four-foot clearance from the bottom. All vessels will preferentially follow deep-water routes (e.g., marked channels) whenever possible.
- e. If a sea turtle or smalltooth sawfish is seen within 100 yards of the active daily construction/dredging operation or vessel movement, all appropriate precautions shall be implemented to ensure its protection. These precautions shall include cessation of operation of any moving equipment closer than 50 feet of a sea turtle or smalltooth sawfish. Operation of any mechanical construction equipment shall cease immediately if a sea turtle or smalltooth sawfish is seen within a 50-ft radius of the equipment. Activities may not resume until the protected species has departed the project area of its own volition.
- f. Any collision with and/or injury to a sea turtle or smalltooth sawfish shall be reported immediately to the National Marine Fisheries Service's Protected Resources Division (727-824-5312) and the local authorized sea turtle stranding/rescue organization.
- g. Any special construction conditions, required of your specific project, outside these general conditions, if applicable, will be addressed in the primary consultation.

Revised: March 23, 2006

O:\forms\Sea Turtle and Smalltooth Sawfish Construction Conditions.doc

Mexico Beach, City of Five 1 square-mile reefs
SAJ-2006-01340 (IP-MMW)
Modification #1 - March 18, 2011
Attachment #3 - Sea turtle and Smalltooth Sawfish
Construction Conditions
Sheet 1 of 1



STANDARD MANATEE CONDITIONS FOR IN-WATER WORK

2009

The permittee shall comply with the following conditions intended to protect manatees from direct project effects:

- a. All personnel associated with the project shall be instructed about the presence of manatees and manatee speed zones, and the need to avoid collisions with and injury to manatees. The permittee shall advise all construction personnel that there are civil and criminal penalties for harming, harassing, or killing manatees which are protected under the Marine Mammal Protection Act, the Endangered Species Act, and the Florida Manatee Sanctuary Act.
- b. All vessels associated with the construction project shall operate at "Idle Speed/No Wake" at all times while in the immediate area and while in water where the draft of the vessel provides less than a four-foot clearance from the bottom. All vessels will follow routes of deep water whenever possible.
- c. Siltation or turbidity barriers shall be made of material in which manatees cannot become entangled, shall be properly secured, and shall be regularly monitored to avoid manatee entanglement or entrapment. Barriers must not impede manatee movement.
- d. All on-site project personnel are responsible for observing water-related activities for the presence of manatee(s). All in-water operations, including vessels, must be shutdown if a manatee(s) comes within 50 feet of the operation. Activities will not resume until the manatee(s) has moved beyond the 50-foot radius of the project operation, or until 30 minutes elapses if the manatee(s) has not reappeared within 50 feet of the operation. Animals must not be herded away or harassed into leaving.
- e. Any collision with or injury to a manatee shall be reported immediately to the FWC Hotline at 1-888-404-FWCC. Collision and/or injury should also be reported to the U.S. Fish and Wildlife Service in Jacksonville (1-904-731-3336) for north Florida or Vero Beach (1-772-562-3909) for south Florida.
- f. Temporary signs concerning manatees shall be posted prior to and during all in-water project activities. All signs are to be removed by the permittee upon completion of the project. Awareness signs that have already been approved for this use by the Florida Fish and Wildlife Conservation Commission (FWC) must be used (see MyFWC.com). One sign which reads *Caution: Boaters* must be posted. A second sign measuring at least 8 1/2" by 11" explaining the requirements for "Idle Speed/No Wake" and the shut down of in-water operations must be posted in a location prominently visible to all personnel engaged in water-related activities.

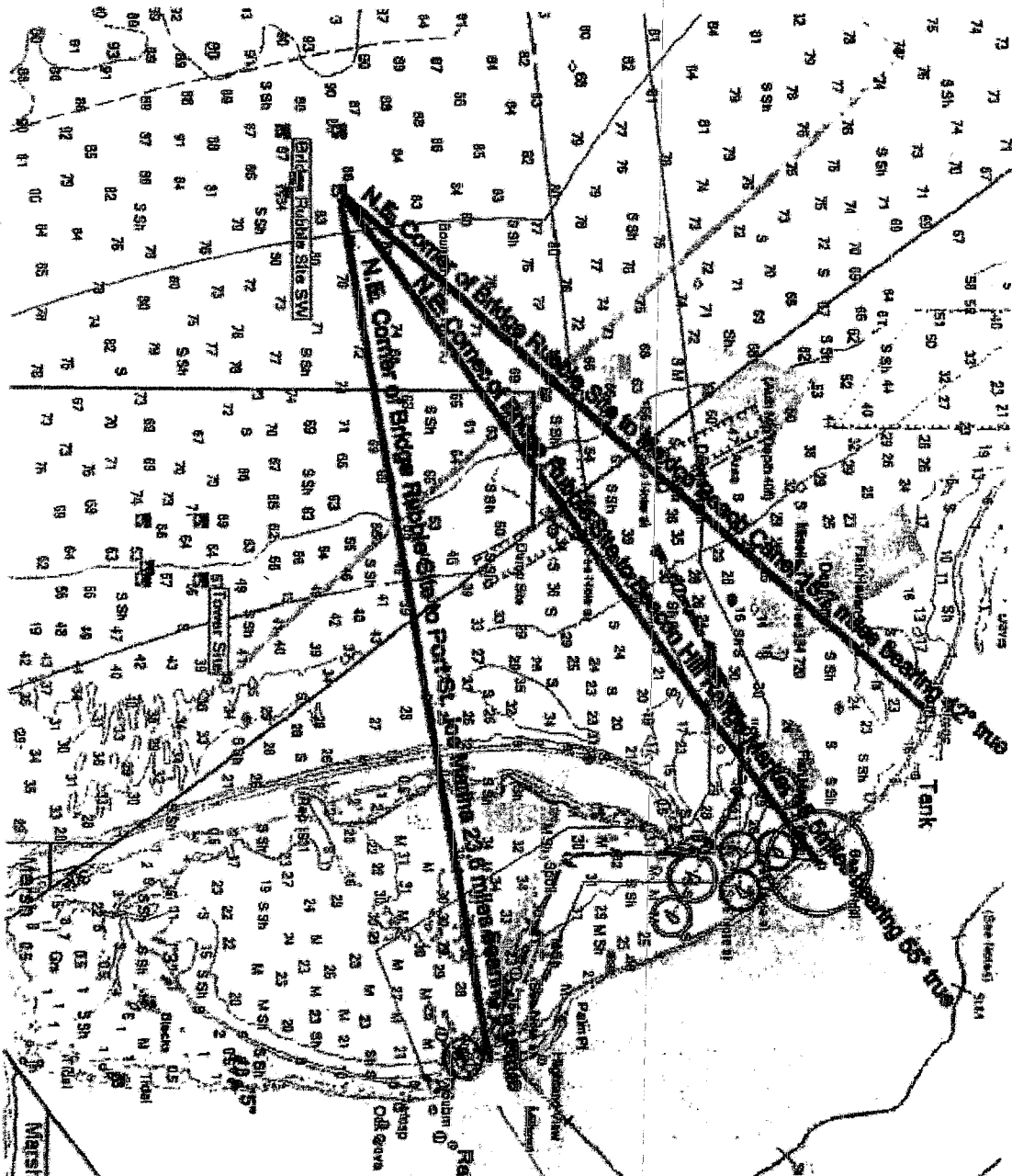

CHART NUMBER:
CHART NAME:

US11289
UNITED STATES GULF COAST FLORIDA ST. JOSEPH
AND ST. ANDREW BAYS

PUBLISHED IN:
PRINT DATE:
EDITION DATE:
REFERENCE ELLIPSOID:
WGS-84 LAT/LON DELTA:

USA
10/01/2001
10/01/2001
WGS-84
80 00 00.0 W 00 00 00.0 N

January 20, 2011 10:59:04 EDT
SAJ-2006-01340-IP-MMW-01

PREBLE-RISH INC
CONSULTING ENGINEERS AND SURVEYORS
CIVIL • SURVEYING • SITE PLANNING

10000 W. BOYD AVE. SUITE 100
FORT MYERS, FL 33907
888-888-7777
www.preble-rish.com

Bridge Rubble Site Location

MBARA Reef
City of Mexico
Mexico Bay
Bay County

Mexico Beach, City of/Five 1 square-mile reefs
SAJ-2006-01340 (IP-MMW)
Modification #1
January 20, 2011
Sheet 1 of 15

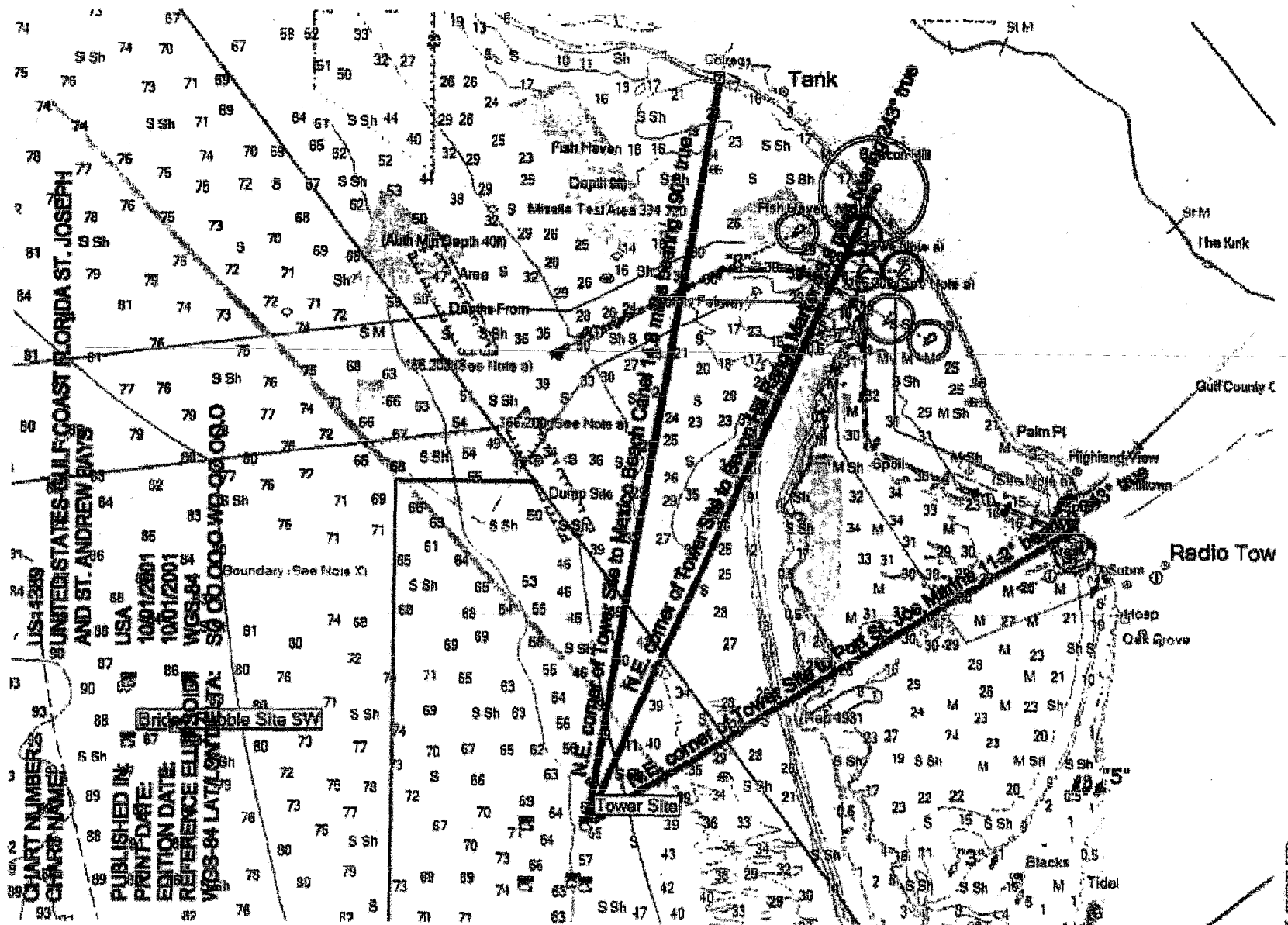

CHART NUMBER: 1389
 CHART NAME: UNITED STATES GULF COAST FLORIDA ST. JOSEPH AND ST. ANDREW BAYS

USA
 1001/2001
 1001/2001
 WGS 84
 WGS 84 LAT/LONG DATA: 30 00 00.00 W 089 00 00.00 S
 Bridge: Middle Site SW
 Boundary: See Note X

January 11, 2011 10:00 AM EDT
 2:00 PM EST
 2:00 PM CST
 2:00 PM MDT
 2:00 PM PDT
 2:00 PM AST
 2:00 PM AEST
 2:00 PM NZST
 2:00 PM SAST
 2:00 PM SMT
 2:00 PM SOT
 2:00 PM SOT
 2:00 PM SOT

PREBLE-RISH INC
 CONSULTING ENGINEERS AND SURVEYORS
 CIVIL • SURVEYING • SITE PLANNING

2000 W. 11th Street
 Suite 100
 Panama City, FL 32401
 Phone: 904.399.1111
 Fax: 904.399.1112
 Email: info@preble-rish.com
 Website: www.preble-rish.com

Tower Site Location
 MBARA
 City of M
 Mexico B
 Bay Co

Mexico Beach, City of Five 1 square-mile reefs
 SAJ-2006-01340 (IP-MMW)
 Modification #1
 January 20, 2011
 Sheet 2 of 15

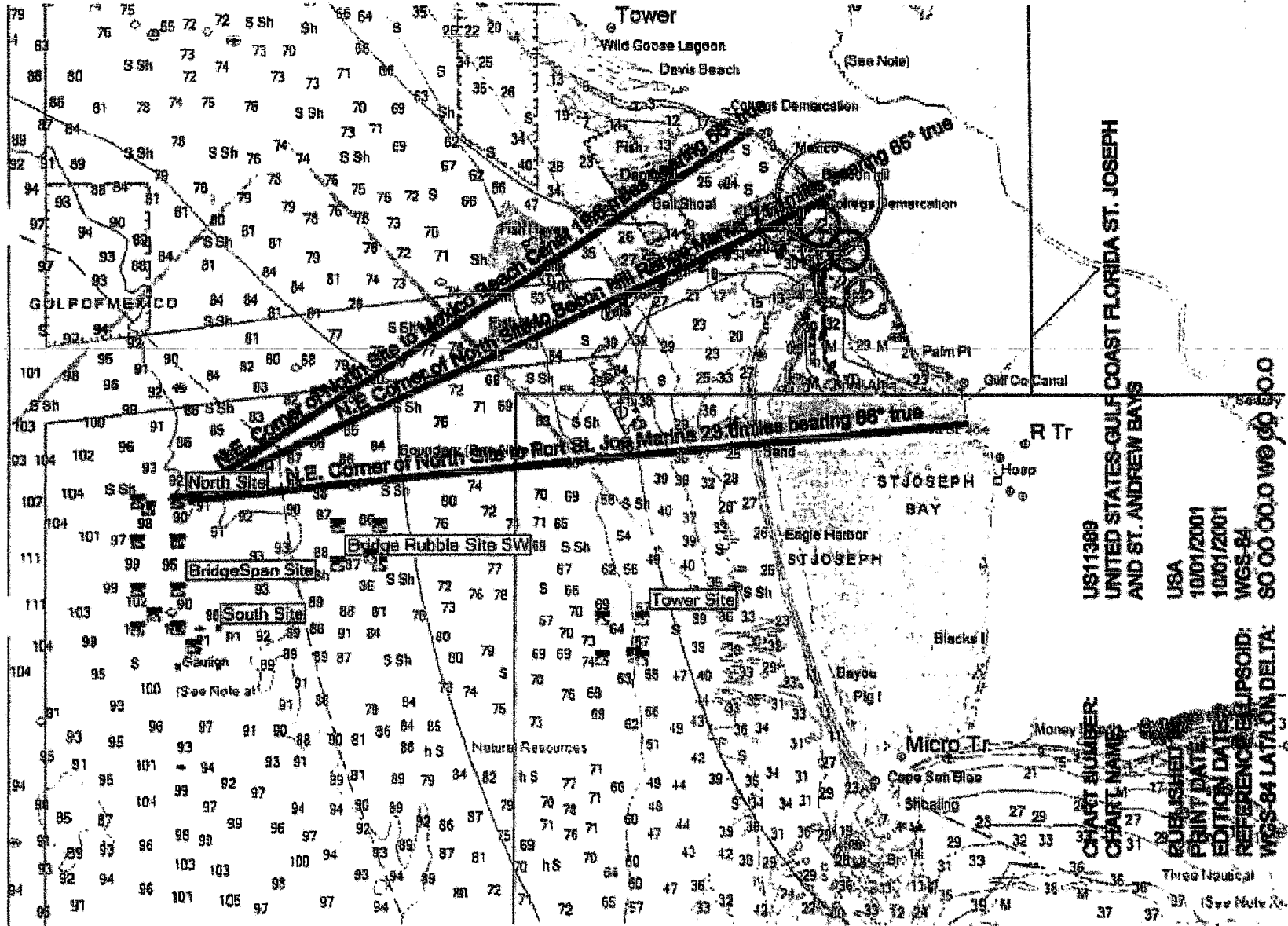

US11389
 UNITED STATES GULF COAST FLORIDA ST. JOSEPH
 AND ST. ANDREW BAYS

USA
 10/01/2001
 10/01/2001
 WGS-84
 30 00 00.0 W 09 00 00.0 N

CHART NUMBER:
 CHART NAME:
 PUBLISHED:
 PRINT DATE:
 EDITION DATE:
 REFERENCE ELLIPSOID:
 WGS-84 LAT/LON DELTA:
 Three Nautical
 (See Note X)

January 14, 2006 09:08 EDT
 20060114 09:08 EDT

PREBLE-RISH INC
 CONSULTING ENGINEERS AND SURVEYORS
 CIVIL • SURVEYING • SITE PLANNING

1000 W. 10th Street
 Suite 100
 Panama City, FL 32401
 Phone: 904.371.1111
 Fax: 904.371.1112
 Email: info@preble-rish.com

North Site
MIENRA
City of Mexico
Bay Cou

Mexico Beach, City of Five 1 square-mile reefs
 SAJ-2006-01340 (IP-MMW)
 Modification #1
 January 20, 2011
 Sheet 3 of 15

CHART NUMBER: US11389

CHART NAME: UNITED STATES GULF COAST FLORIDA ST. JOSEPH AND ST. ANDREW BAYS

PUBLISHED IN: USA

PRINT DATE: 10/01/2001

EDITION DATE: 10/01/2001

REFERENCE ELLIPSOID: WGS 84

WGS 84 LAT/LON DELTA: 00 00 00.0 WO 00 00.0

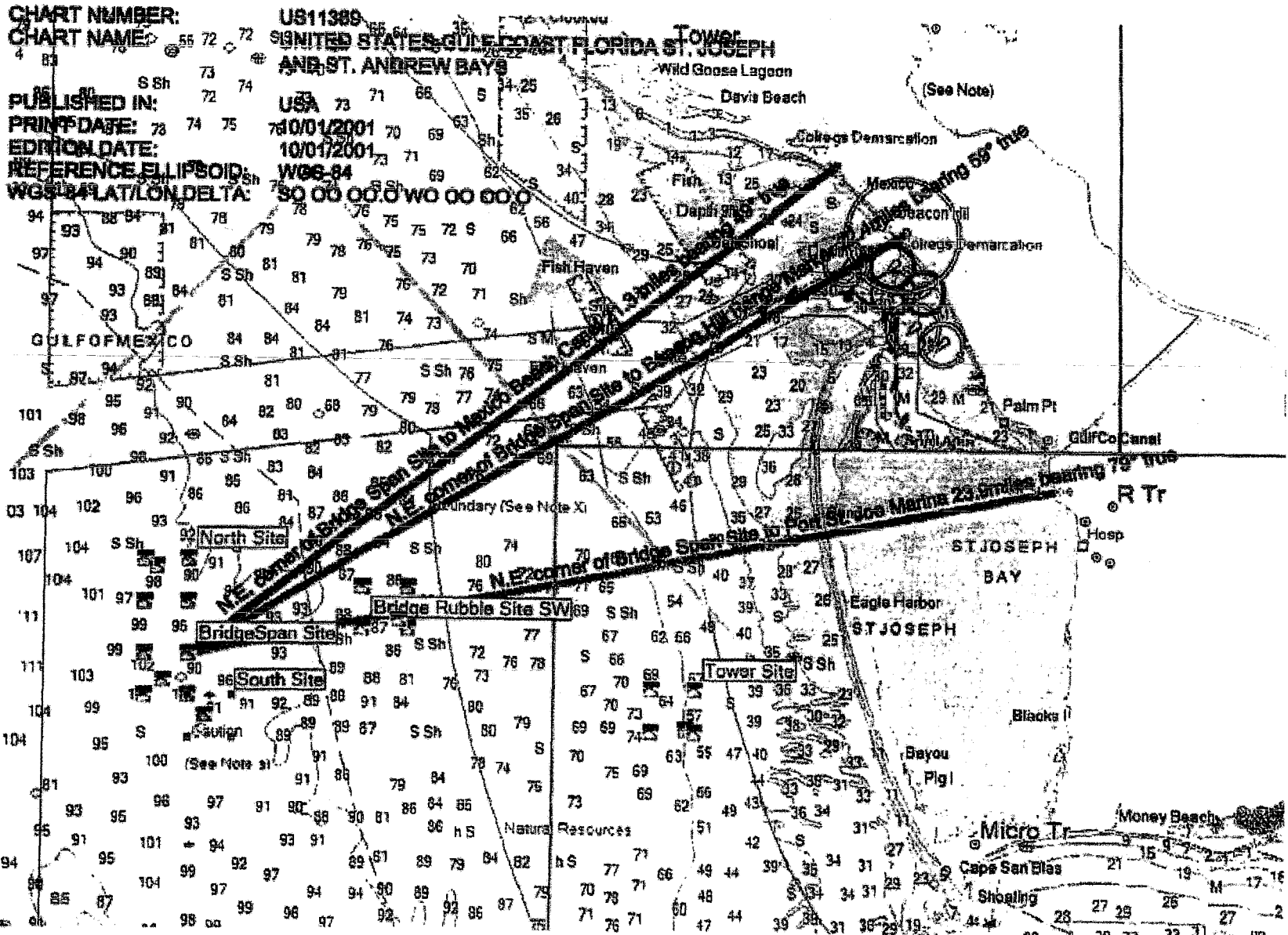

PREBLERISH INC
 CONSULTING ENGINEERS AND SURVEYORS
 CIVIL • SURVEYING • SITE PLANNING

2000 UNIVERSITY AVENUE
 SUITE 100
 MEMPHIS, TN 38117
 (901) 525-1100
 FAX (901) 525-1101
 WWW.PREBLERISH.COM

Bridge Span Site Location

MBARA I
 City of MI
 Meade
 Bay Club

Mexico Beach, City of/Five 1 square-mile reefs
 SAJ-2006-01340 (IP-MMW)
 Modification #1
 January 20, 2011
 Sheet 4 of 15

ARMY D. 2006 USACE ETD
 SACRAMENTO DISTRICT

CHART NUMBER: 70

CHART NAME: 76 55 72 72 S Sh

PUBLISHED IN: 73 70

PRINT DATE: 74

EDITION DATE: 73

REFERENCE ELLIPSOID: S Sh 76 74

WGS-84 LAT/LON DELTA: 78

US11389 41 24 18

UNITED STATES GULF COAST FLORIDA ST. JOSEPH AND ST. ANDREW BAYS 20

USA 66

10/01/2001 66

10/01/2001

S Sh 69 63 S 34 25

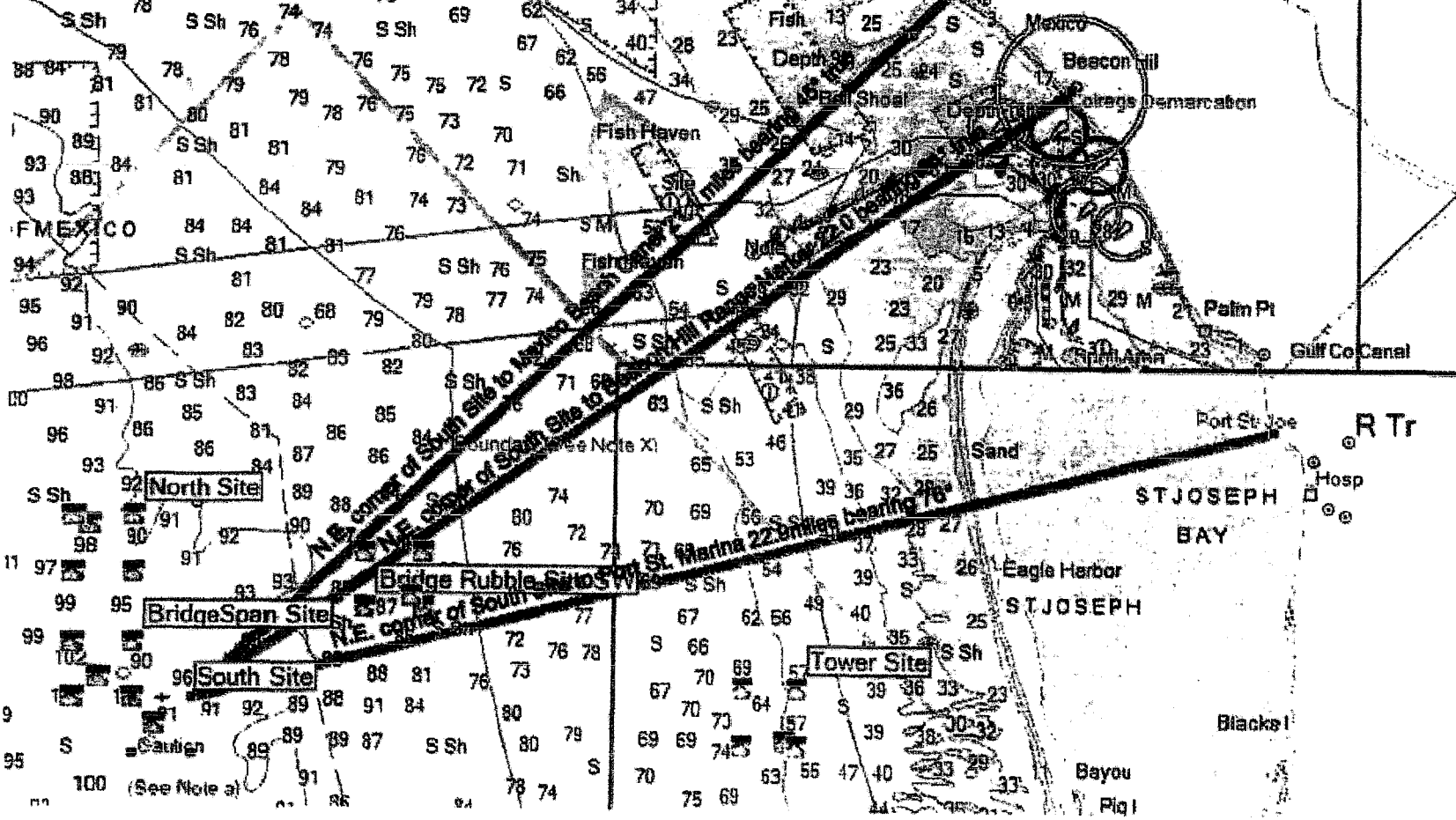

South Site Location

MEARA R
City of Mex
Mexico
Bay Count

Mexico Beach, City of Five 1 square-mile reefs
SAJ-2006-01340 (IP-MMW)
Modification #1

January 20, 2011
Sheet 5 of 15

January 11, 2011 08:54:18 EDT
C:\Users\j\Documents\MapInfo

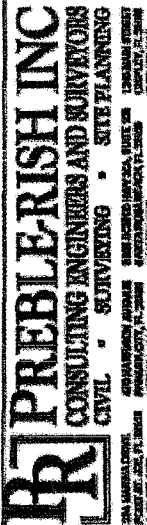
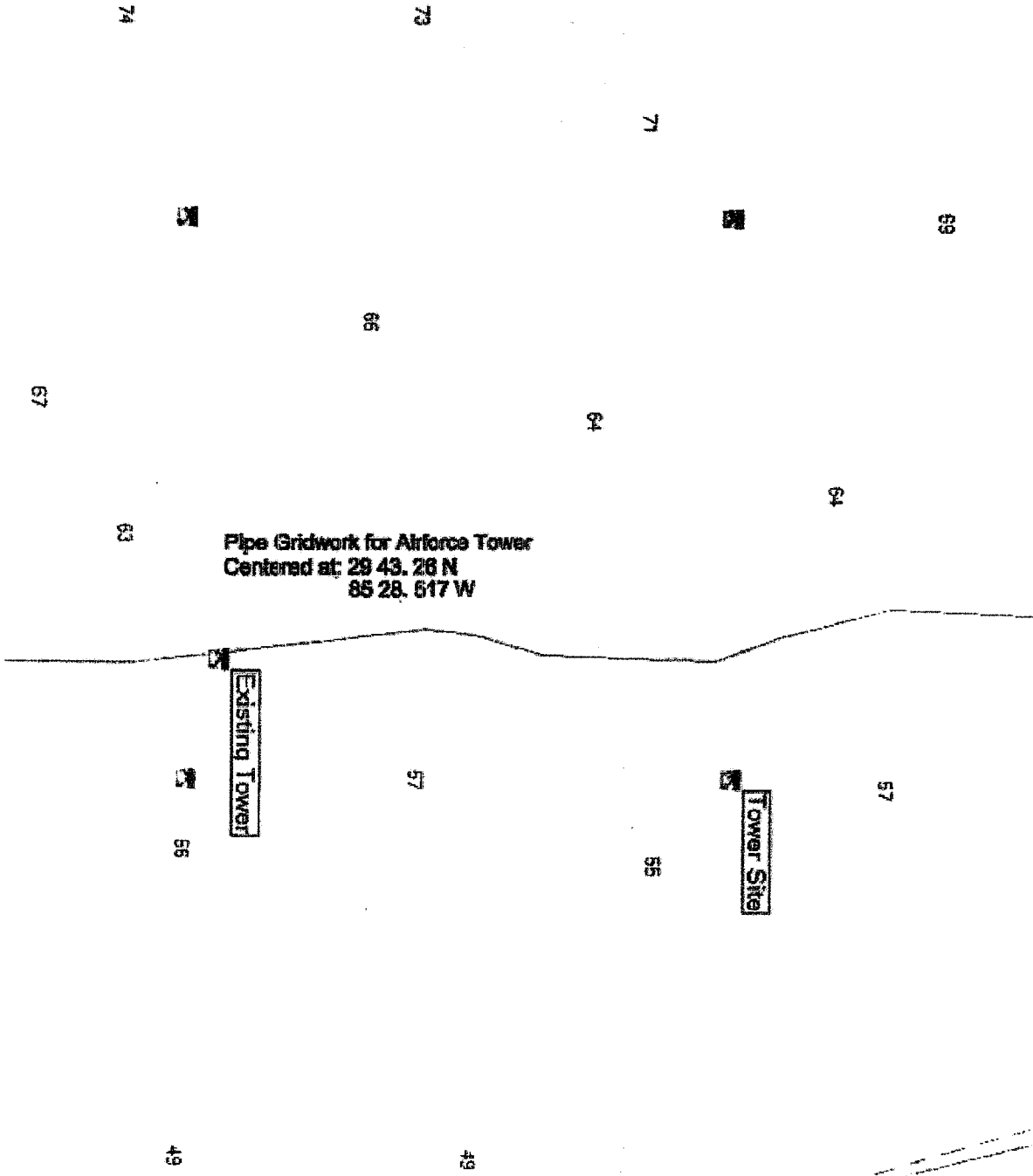

CHART NUMBER:
CHART NAME:

U.S. 1389
UNITED STATES-GULF COAST FLORIDA ST. JOSEPH
AND ST. ANDREW BAYS

PUBLISHED IN:
PRINT DATE:
EDITION DATE:
REFERENCE ELLIPSOID:
WGS-84 LAT/LON DELTA:

USA
10/01/2001
10/01/2001
WGS-84
SO 00 00.0 WO 00 00.0



January 11, 2006 (095043 EST)
S:\MREGG\DWG\01006\CHARTS.DWG

PREBLE-RISH INC
CONSULTING ENGINEERS AND SURVEYORS
CIVIL • SURVEYING • SITE PLANNING

204 MITCHELL BLVD
PORT ST. LUCIE, FL 34956
Phone: 887-7200

4711 HAWTHORN AVENUE
PANAMA CITY, FL 32401
Phone: 909-0811

2000 SCENIC HWY 206, SUITE 101
SANTA ROSA BEACH, FL 32480
Phone: 251-8308

104 EDMAN STREET
ORLEANS, FL 32950
Phone: 888-4118

Existing Tower Site Location

MBAF
City of
Me
Bay C

Mexico Beach, City of/Five 1 square-mile reefs
SAJ-2006-01340 (IP-MMW)
Modification #1
January 20, 2011
Sheet 6 of 15

CHART NUMBER: US11388
 CHART NAME: UNITED STATES-GULF COAST FLORIDA ST. JOSEPH AND ST. ANDREW BAYS

PUBLISHED IN: USA
 PRINT DATE: 10/01/2001
 EDITION DATE: 10/01/2001
 REFERENCE ELLIPSOID: WGS-84
 WGS-84 LAT/LON DELTA: SO 00 00.0 WO 00 00.0

3 5 5 1

Concrete rubble
 Centered at 29 48. 094 N
 85 42. 443W

88

92

Existing Reef

92

88

North Star

92

76

PREBLE-RISH INC
 CONSULTING ENGINEERS AND SURVEYORS
 CIVIL • SURVEYING • SITE PLANNING

2500 MARSHWAY BLVD. SUITE 201, MELBOURNE, FL 32909 (407) 257-1200
 4700 UNIVERSITY AVENUE SUITE 100, WEST PALM BEACH, FL 33411 (561) 832-0500
 2000 UNIVERSITY BLVD. SUITE 100, WEST PALM BEACH, FL 33411 (561) 832-0500
 1000 UNIVERSITY BLVD. SUITE 100, WEST PALM BEACH, FL 33411 (561) 832-0500

Existing Reef Site Location

MEARA R
 City of Mel
 Mexico
 Bay Coun

Mexico Beach, City of/Five 1 square-mile reefs
 SAJ-2006-01340 (IP-MMW)
 Modification #1
 January 20, 2011
 Sheet 7 of 15

CHART NUMBER:
CHART NAME:

US11399
UNITED STATES-GULF COAST FLORIDA ST. JOSEPH
AND ST. ANDREW BAYS

PUBLISHED IN:
PRINT DATE:
EDITION DATE:
REFERENCE ELLIPSOID:
WGS-84 LAT/LON DELTA:

USA
10/01/2001
10/01/2001
WGS-84
SO 00 00.0 WO 00 00.0

86

90

86

75

1 Concrete bridge deck
Centered at 29 46.354 N
85 36.087 W

Existing Rubble

Bridge Rubble Site NE

88

77

87

73

84

S Sh

88

83

PREBLE-RISH INC
CONSULTING ENGINEERS AND SURVEYORS
CIVIL • SURVIVING • SITE PLANNING

2000 UNIVERSITY DRIVE, SUITE 100, MIAMI, FL 33136
400 MARINE AVENUE, MIAMI BEACH, FL 33139
4000 WOODROW WILSON BLVD, SUITE 100, MIAMI BEACH, FL 33140
10000 WOODROW WILSON BLVD, SUITE 100, MIAMI BEACH, FL 33156

Existing Rubble Site Location

MBAR
City of
Me
Bay C

Mexico Beach, City of/Five 1 square-mile reefs
SAJ-2006-01340 (IP-MMW)
Modification #1
January 20, 2011
Sheet 8 of 15

CHART NUMBER:
CHART NAME:

US11389
UNITED STATES GULF COAST FLORIDA ST. JOSEPH
AND ST. ANDREW BAYS 96

PUBLISHED IN:
PRINT DATE:
EDITION DATE:
REFERENCE ELLIPSOID:
WGS-84 LAT/LON DELTA:

USA
10/01/2001
10/01/2001
WGS-84
60 00 00.0 WD 00 00.0

Alphane
Centered at: 29. 43. 625 N
85 40. 750 W

Existing plane

South Star



Caution

0.2 mi
0.2/0.200m

PREBLE-RISH INC
CONSULTING ENGINEERS AND SURVEYORS
CIVIL • SURVIVING • SITE PLANNING

2340 MARINE DRIVE
FORT MYERS, FL 33901
889.237.7225

200 INDUSTRIAL AVENUE
TAMPA, FL 33604
813.287.2271

3600 GOLF COURSE BLVD, SUITE 102
MIRAGE BEACH, FL 33449
561.241.2222

12630 WINDY STREET
CORTEZ, FL 32920
888.416.4112

Existing Plane Site Location

MBARA R
City of Mel
Medica
Bay Coun

Mexico Beach, City of/Five 1 square-mile reefs
SAJ-2006-01340 (IP-MMW)
Modification #1
January 20, 2011
Sheet 9 of 15

CHART NUMBER: US11389
 CHART NAME: UNITED STATES-GULF COAST FLORIDA ST. JOSEPH
 AND ST. ANDREW BAYS

PUBLISHED IN: USA
 PRINT DATE: 10/01/2001
 EDITION DATE: 10/01/2001
 REFERENCE ELLIPSOID: WGS-84
 WGS-84 LAT/LON DELTA: SO 00 00.0 WO 00 00.0

2 Bridge Span Sections
 Centered at: 29. 44. 366 N
 85 44. 847 W

Existing Bridge Span Sections

Bridge Span Site

January 20, 2011 10:00:41 EST
 SAJ-2006-01340-IP-MMW

PREBLE-RISH INC
 CONSULTING ENGINEERS AND SURVEYORS
 CIVIL • SURVEYING • SITE PLANNING

MEMPHIS OFFICE: 470 HUNTER AVENUE, MEMPHIS, TN 38103
 PANAMA CITY OFFICE: 470 HUNTER AVENUE, PANAMA CITY, FL 32381
 TAMPA OFFICE: 2005 N. W. 13TH AVENUE, TAMPA, FL 33609
 MIAMI OFFICE: 1800 HAM STREET, MIAMI, FL 33139

Existing Bridge Span Site Location:

- M Mexico Beach, City of/Five 1 square-mile reefs
- CU SAJ-2006-01340 (IP-MMW)
- Modification #1
- January 20, 2011
- Sheet 10 of 15

CHART NUMBER:
CHART NAME:

US113.
UNITED STATES GULF COAST FLORIDA ST. JOSEPH
AND ST. ANDREW BAYS

PUBLISHED IN:
PRINT DATE:
EDITION DATE:
REFERENCE ELLIPSOID:
WGS-84 LAT/LON DELTA:

USA
10/01/2001
10/01/2001
WGS-84
SO 00 00.0 WO 00 00.0

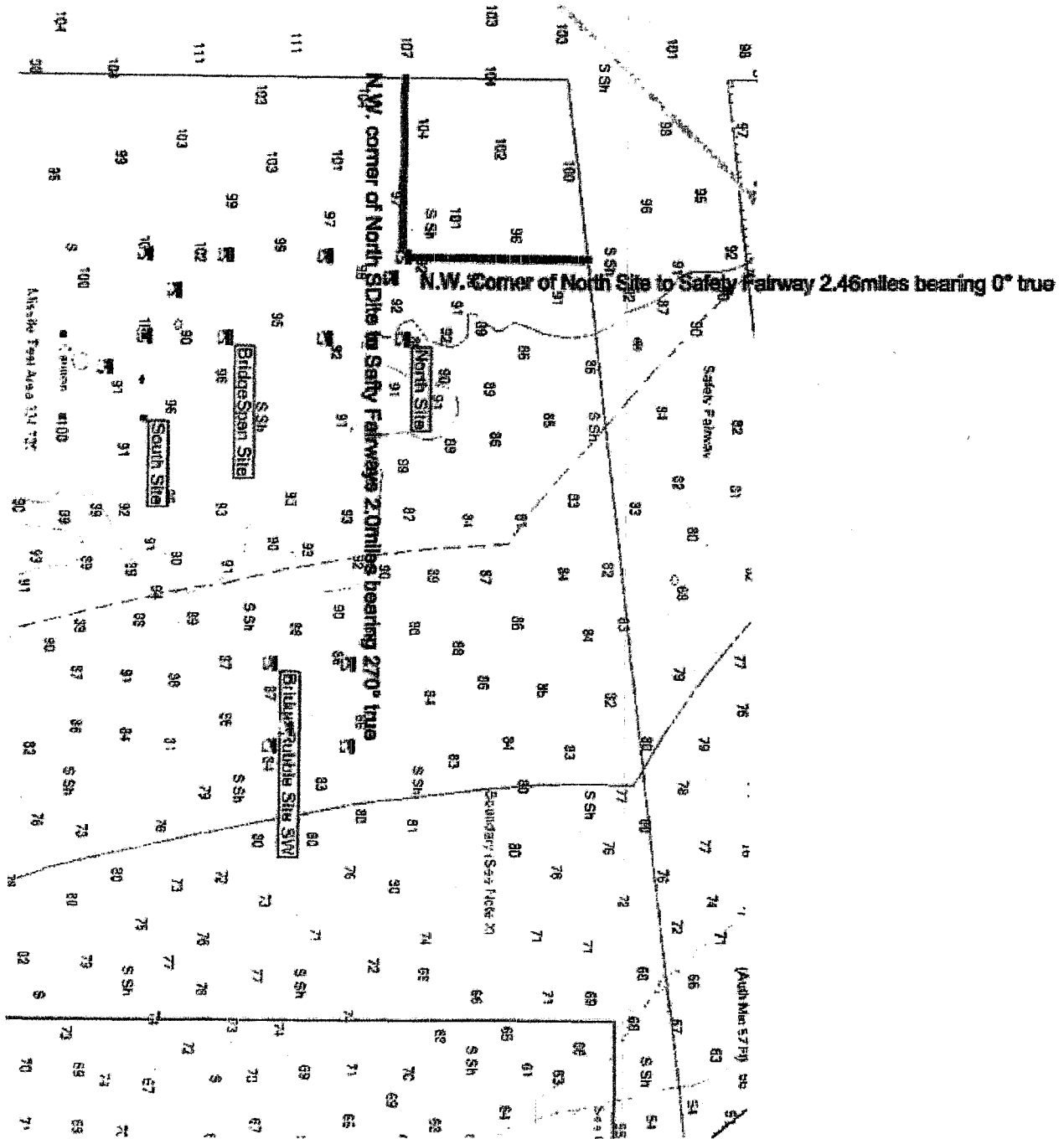

January 20, 2011 06:04:48 EST
SAJ-2006-01340-IP-MMW-01

PREBLE RISH INC
CONSULTING ENGINEERS AND SURVEYORS
CIVIL • SURVEYING • SITE PLANNING

Safety Fairways Site Location

MEARA Re
City of Mex
Mexico E
Bay County

Mexico Beach, City of/Five 1 square-mile reefs
SAJ-2006-01340 (IP-MMW)
Modification #1
January 20, 2011
Sheet 11 of 15

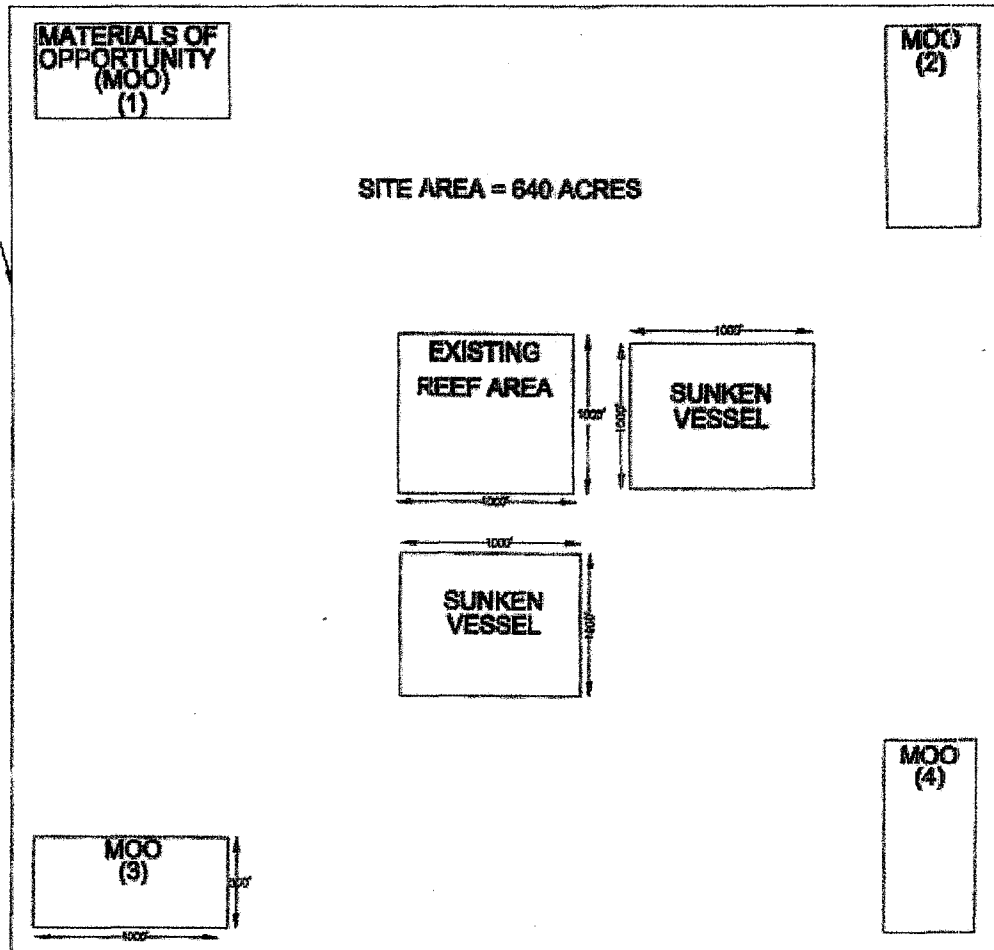

SITE AREA = 640 ACRES

SITE BOUNDARY

SECTION TYPICAL REEF SITE
SCALE: N.T.S

NOTE:

1. REEF LAYOUT MAY DIFFER FROM TYPICAL. SEE LOCATION DRAWINGS FOR EXISTING REEF COORDINATES.

2. LOCATIONS OF EACH REEF WITHIN A SITE WILL BE DETERMINED PRIOR TO DEPLOYMENT

January 11, 2011 (1641-29 EST)
SAJ-2006-01340-IP-MMW-SCHEMATIC.DWG

PREBLE-RISH INC
CONSULTING ENGINEERS AND SURVEYORS
CIVIL • SURVEYING • SITE PLANNING

4000 MARINA DRIVE
FORT ST. JOE, FL 32034
(904) 227-1724

4741 HUNTERBUSH AVENUE
PANAMA CITY, FL 32404
(904) 822-0544

2006 W. BAYVIEW AVENUE, SUITE 101
SANTA ROSA BEACH, FL 32090
(904) 221-2922

1250 MAIN STREET
CHAPLKY, FL 32008
(904) 498-4118

REEF

MBAR
CITY OF
MEXI
B/

Mexico Beach, City of/Five 1 square-mile reefs
SAJ-2006-01340 (IP-MMW)
Modification #1
January 20, 2011
Sheet 12 of 15

NOTE:
 1. REEF LAYOUT MAY DIFFER FROM TYPICAL. SEE LOCATION DRAWINGS FOR EXISTING REEF COORDINATES.
 2. LOCATIONS OF EACH REEF WITHIN A SITE WILL BE DETERMINED PRIOR TO DEPLOYMENT

WATER DEPTH AT LOW TIDE "MSL"

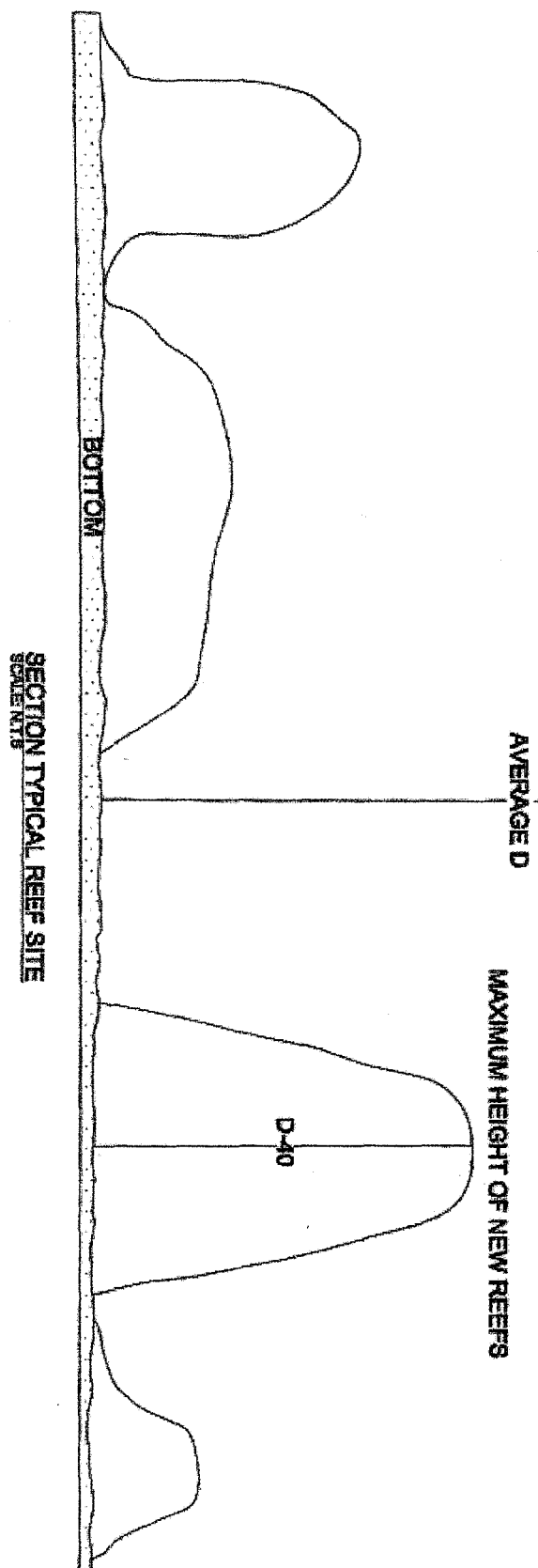

SECTION TYPICAL REEF SITE
 SCALE NTS

January 11, 2015 (16:49:29 CST)
 SAJ025.066A.DWG/MSB9ENHARTS.DWG

PREBLE-RISH INC
 CONSULTING ENGINEERS AND SURVEYORS
 CIVIL • SURVEYING • SITE PLANNING

334 MANHATTAN DRIVE FORT MYERS, FL 33906 (888) 827-8822
 470 HANFORD AVENUE PANAMA CITY, FL 32360 (850) 822-0444
 6788 SEASIDE HWY SW, SUITE 102 SANTA FE SPRING, FL 32759 (407) 821-9822
 1242 MARK STREET CRYSTAL BEACH, FL 32816 (407) 526-4178

REEF DETAILS

MBARA REEF
 CITY OF MEXICO
 MEXICO BEACH
 BAY COUNTY

Mexico Beach, City of/Five 1 square-mile reefs
 SAJ-2006-01340 (IP-MMW)
 Modification #1
 January 20, 2011
 Sheet 13 of 15

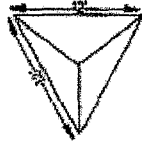

PLAN TYPICAL TETRAHEDRON

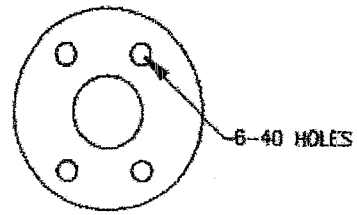

PLAN TYPICAL REEFBALL

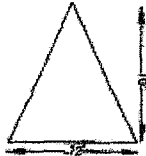

SECTION TYPICAL TETRAHEDRON

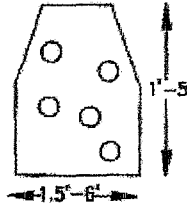

SECTION TYPICAL REEFBALL

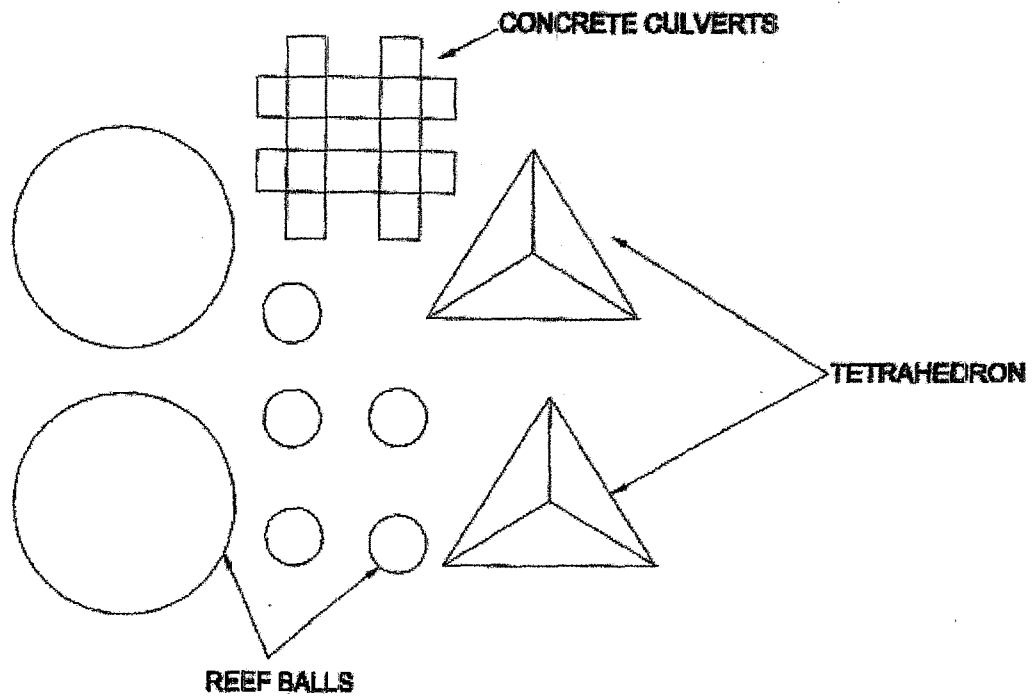

PLAN MATERIAL OF OPPORTUNITY AREA
SCALE: 1" = 10'

January 11, 2011 09:02:29 EST
SAJ-2006-01340-IP-MMW-001-ART-01.DWG

PREBLE-RISH INC
CONSULTING ENGINEERS AND SURVEYORS
CIVIL • SURVEYING • SITE PLANNING

200 HARRISON STREET
PORT ST. LUCIE, FL 34958
(888) 227-7228

470 HARRISON AVENUE
POMONA CITY, FL 32669
(850) 822-1044

800 SECOND AVENUE, SUITE 100
DAVIE, FL 32604, FL 32608
(850) 221-3882

1400 MAIN STREET
CHIEFLY, FL 32688
(850) 826-4118

REEF M

MBA

CITY C

MEX

E

Mexico Beach, City of/Five 1 square-mile reefs
SAJ-2006-01340 (IP-MMW)
Modification #1
January 20, 2011
Sheet 14 of 15

CHART NUMBER:
CHART NAME:

US11389
UNITED STATES GULF COAST FLORIDA ST. JOSEPH
AND ST. ANDREW BAYS

PUBLISHED IN: S Sh
PRINT DATE:
EDITION DATE:
REFERENCE ELLIPSOID:
WGS 84 SAT/LON DELTA:

USA
10/01/2001
10/01/2001
WGS 84
SO 00 00 00 WO 00 00 00

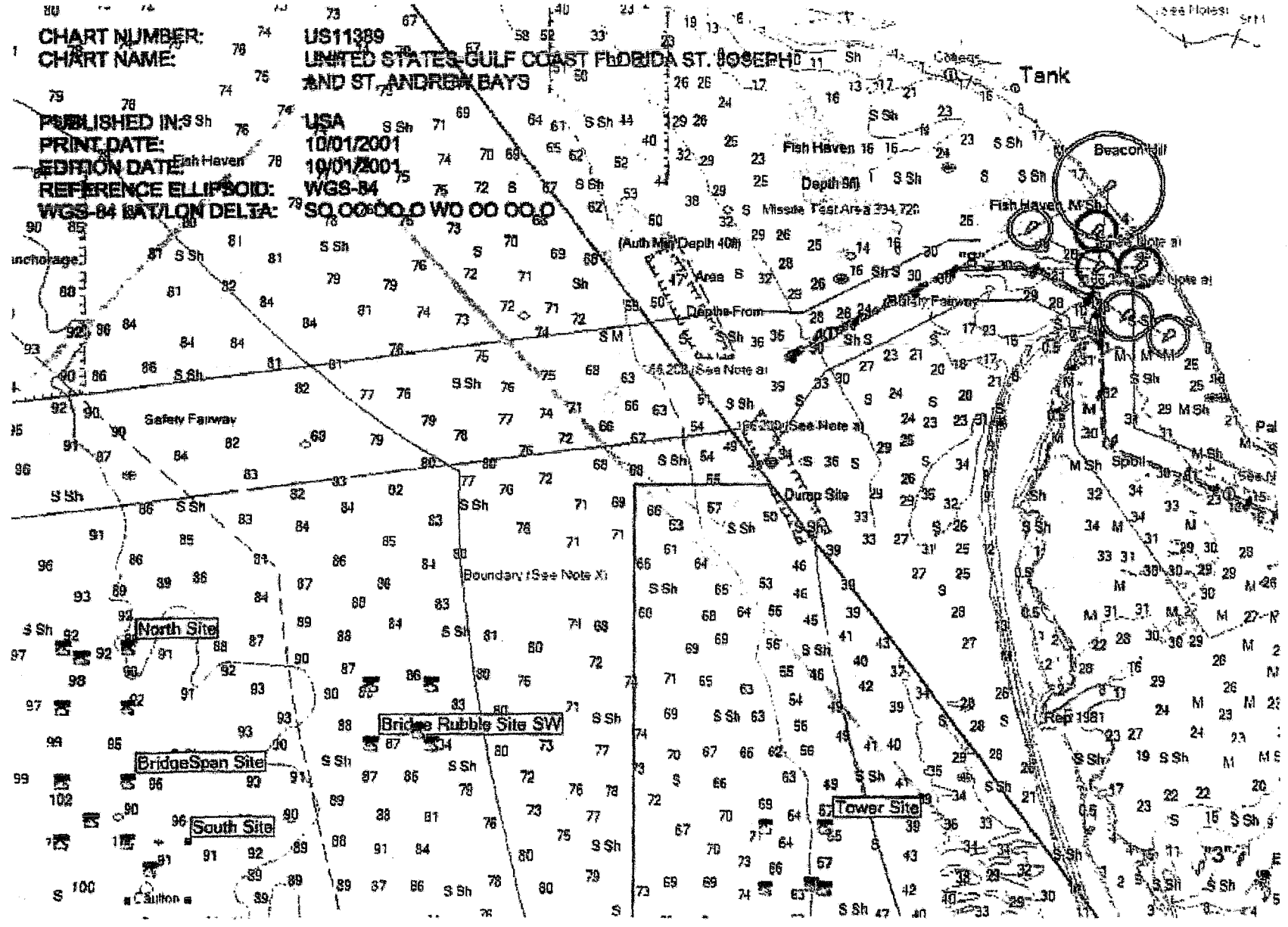

PREBLERISH INC
CONSULTING ENGINEERS AND SURVEYORS
CIVIL • SURVEYING • SITE PLANNING

2000 W. STATE ST. SUITE 100
MEXICO BEACH, FL 32185
TEL: 386-238-1111
FAX: 386-238-1112
WWW.PREBLERISH.COM

PROPOSED MBARA REEF SITES

MBARA Reef
City of Mexico
Mexico B
Bay County

Mexico Beach, City of Five 1 square-mile reefs
SAJ-2006-01340 (IP-MMW)
Modification #1
January 20, 2011
Sheet 15 of 15