



DEPARTMENT OF THE ARMY
CORPS OF ENGINEERS, NEW ORLEANS DISTRICT
7400 LEAKE AVENUE
NEW ORLEANS, LOUISIANA 70118-3561
AUG 26 2019

RECEIVED

2019 AUG 28 P 1:10

CPRA

Operations Division
Western Evaluation Section

SUBJECT: MVN-2018-01009-WLL

Coastal Protection and Restoration Authority (CPRA)
150 Terrace Avenue
Baton Rouge, LA 70802

Gentlemen:

Enclosed is a permit dated this date, subject as above, authorizing work under the Department of the Army permit program.

You are again reminded that any work not in accordance with the approved plans is subject to removal regardless of the expense and the inconvenience that such removal may involve and regardless of the date when the discrepancy is discovered.

Your attention is directed to all the terms and conditions of the approval. In order to have the work approved in accordance with the issued permit, all terms and conditions of the permit and plans shown on the drawings attached thereto must be rigidly adhered to.

It is necessary that you notify the District Engineer, Attention: Western Evaluation Section, in writing, prior to commencement of work and also upon its completion. The notification must include the permittee's name, as shown on the permit, and the permit number. Please note the expiration date on the permit. Should the project not be completed by that date, you may request a permit time extension. Such requests must be received before, but no sooner than six months before, the permit expiration date and must show the work completed and the reason the project was not finished within the time period granted by the permit.

A copy of page 1 of the permit (ENG Form 1721) must be conspicuously displayed at the project site. Also, you must keep a copy of the signed permit at the project site until the work is completed.

Sincerely,

Darrell S. Barbara
Chief, Western Evaluation Section

Enclosures

DEPARTMENT OF THE ARMY PERMIT

Permittee: Coastal Protection and Restoration Authority (CPRA)

Permit No.: MVN-2018-01009-WLL

Issuing Office: New Orleans District

NOTE: The term "you" and its derivatives, as used in this permit, means the permittee or any future transferee. The term "this office" refers to the appropriate district or division office of the Corps of Engineers having jurisdiction over the permitted activity or the appropriate official of that office acting under the authority of the commanding officer.

You are authorized to perform work in accordance with the terms and conditions specified below.

Project Description: Enhance colonial bird rookery habitat by increasing elevations of the existing Rabbit Island through dredging water bottom sediments from a 24 acre borrow site in Calcasieu Ship Channel and depositing those sediments to the proposed elevations. in accordance with the drawings attached in eight sheets, dated August 14, 2018.

Project Location: In West Cove of Calcasieu Lake approximately 2.5 miles west of the Calcasieu Ship Channel in Cameron Parish, LA (29.84917 N, -93.38361 W).

Permit Conditions:

General Conditions:

1. The time limit for completing the work authorized ends on **August 31, 2024**. If you find that you need more time to complete the authorized activity, submit your request for a time extension to this office for consideration at least one month before the above date is reached.
2. You must maintain the activity authorized by this permit in good condition and in conformance with the terms and conditions of this permit. You are not relieved of this requirement if you abandon the permitted activity, although you may make a good faith transfer to a third party in compliance with General Condition 4 below. Should you wish to cease to maintain the authorized activity or should you desire to abandon it without a good faith transfer, you must obtain a modification of this permit from this office, which may require restoration of the area.
3. If you discover any previously unknown historic or archeological remains while accomplishing the activity authorized by this permit, you must immediately notify this office of what you have found. We will initiate the Federal and State coordination required to determine if the remains warrant a recovery effort or if the site is eligible for listing in the National Register of Historic Places.
4. If you sell the property associated with this permit, you must obtain the signature of the new owner in the space provided and forward a copy of the permit to this office to validate the transfer of this authorization.
5. If a conditioned water quality certification has been issued for your project, you must comply with the conditions specified in the certification as special conditions to this permit. For your convenience, a copy of the certification is attached if it contains such conditions.
6. You must allow representatives from this office to inspect the authorized activity at any time deemed necessary to ensure that it is being or has been accomplished in accordance with the terms and conditions of your permit.

Special Conditions: See Pages 4 and 5

Further Information:

1. Congressional Authorities: You have been authorized to undertake the activity described above pursuant to:

- (X) Section 10 of the Rivers and Harbors Act of 1899 (33 U.S.C. 403).
- (X) Section 404 of the Clean Water Act (33 U.S.C. 1344).
- () Section 103 of the Marine Protection, Research and Sanctuaries Act of 1972 (33 U.S.C. 1413).

2. Limits of this authorization.

- a. This permit does not obviate the need to obtain other Federal, State, or local authorizations required by law.
- b. This permit does not grant any property rights or exclusive privileges.
- c. This permit does not authorize any injury to the property or rights of others.
- d. This permit does not authorize interference with any existing or proposed Federal project.

3. Limits of Federal Liability. In issuing this permit, the Federal Government does not assume any liability for the following:

- a. Damages to the permitted project or uses thereof as a result of other permitted or unpermitted activities or from natural causes.
- b. Damages to the permitted project or uses thereof as a result of current or future activities undertaken by or on behalf of the United States in the public interest.
- c. Damages to persons, property, or to other permitted or unpermitted activities or structures caused by the activity authorized by this permit.
- d. Design or construction deficiencies associated with the permitted work.
- e. Damage claims associated with any future modification, suspension, or revocation of this permit.

4. Reliance on Applicant's Data: The determination of this office that issuance of this permit is not contrary to the public interest was made in reliance on the information you provided.

5. Reevaluation of Permit Decision. This office may reevaluate its decision on this permit at any time the circumstances warrant. Circumstances that could require a reevaluation include, but are not limited to, the following:

- a. You fail to comply with the terms and conditions of this permit.
- b. The information provided by you in support of your permit application proves to have been false, incomplete, or inaccurate (See 4 above).
- c. Significant new information surfaces which this office did not consider in reaching the original public interest decision.

Such a reevaluation may result in a determination that it is appropriate to use the suspension, modification, and revocation procedures contained in 33 CFR 325.7 or enforcement procedures such as those contained in 33 CFR 326.4 and 326.5. The referenced enforcement procedures provide for the issuance of an administrative order requiring you to comply with the terms and conditions of your permit and for the initiation of legal action where appropriate. You will be required to pay for any corrective measures ordered by this office, and if you fail to comply with such directive, this office may in certain situations (such as those specified in 33 CFR 209.170) accomplish the corrective measures by contract or otherwise and bill you for the cost.

6. Extensions. General Condition 1 establishes a time limit for the completion of the activity authorized by this permit. Unless there are circumstances requiring either a prompt completion of the authorized activity or a reevaluation of the public interest decision, the Corps will normally give favorable consideration to a request for an extension of this time limit.

Your signature below, as permittee, indicates that you accept and agree to comply with the terms and conditions of this permit.

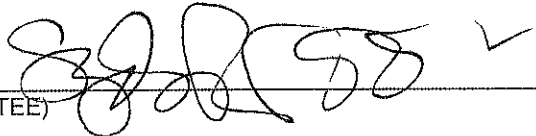
x 
(PERMITTEE)

x 8/20/19
(DATE)

This permit becomes effective when the Federal official, designated to act for the Secretary of the Army, has signed below.

Darrell S. Barbara

8/26/2019
(DATE)

Darrell S. Barbara, Chief, Western Evaluation Section
for Stephen F. Murphy, District Commander

When the structures or work authorized by this permit are still in existence at the time the property is transferred, the terms and conditions of this permit will continue to be binding on the new owner(s) of the property. To validate the transfer of this permit and the associated liabilities associated with compliance with its terms and conditions, have the transferee sign and date below.

(TRANSFEREE)

(DATE)

SPECIAL CONDITIONS: MVN-2018-01009-WLL

7. If the authorized project requires any additional work within waters of the U.S. not expressly permitted herein, the permittee must obtain an amendment to this authorization prior to commencement of work.
8. That any excavated and/or fill material placed within wetlands must be free of contaminants, to the best of the permittee's knowledge.
9. The permittee must install and maintain, at his expense, any safety lights and signals prescribed by the US Coast Guard, through regulations or otherwise, on the authorized facilities.
10. The permitted activity must not interfere with the public's right to free navigation on all navigable waters of the United States.
11. The permittee understands and agrees that, if future operations by the United States require the removal, relocation, or other alteration, of the structure or work herein authorized, or if, in the opinion of the Secretary of the Army or his authorized representative, said structure or work shall cause unreasonable obstruction to the free navigation of the navigable waters, the permittee will be required, upon due notice from the Corps of Engineers, to remove, relocate, or alter the structural work or obstructions caused thereby, without expense to the United States. No claim shall be made against the United States on account of any such removal or alteration.
12. If the authorized project, or future maintenance work, involves the use of floating construction equipment (barge mounted cranes, barge mounted pile driving equipment, floating dredge equipment, dredge discharge pipelines, etc.,) in the waterway, you are advised to notify the Eighth Coast Guard District so that a Notice to Mariners, if required, may be prepared. Notification with a copy of your permit approval and drawings should be mailed to the Commander (dpw), Eighth Coast Guard District, Hale Boggs Federal Building, 500 Poydras Street, Room 1230, New Orleans, Louisiana 70130, about 1 month before you plan to start work. Telephone inquiries can be directed to the Eighth Coast Guard District, Waterways Management at (504) 671-2107.
13. Many local governing bodies have instituted laws and/or ordinances in order to regulate dredge and/or fill activities in floodplains to assure maintenance of floodwater storage capacity and avoid disruption of drainage patterns that may affect surrounding properties. Your project involves dredging and/or placement of fill, therefore, you must contact the local municipal and/or parish governing body regarding potential impacts to floodplains and compliance of your authorized activities with local floodplain ordinances, regulations or permits.
14. If the authorized project requires additional work not expressly permitted herein, or include modifications in the scope of the authorized plan, the permittee shall obtain an amendment and/or separate permit review and decision, prior to commencement of those changes. All work shall be confined to the permitted work area(s) represented in the attached drawings. Mechanized land clearing or filling in wetlands and/or special aquatic sites for access or project construction, unless expressly permitted herein, is not authorized.
15. The permittee shall degrade the containment dikes to authorized elevations, congruent with the elevation of the respective cell, within six months after the fill placement is completed or within the following non-nesting season.

SPECIAL CONDITIONS: MVN-2018-01009-WLL

16. The permittee shall adhere to the attached monitoring schedule titled CS-80 Rabbit Island Restoration- Post Construction Schedule. Associated reports shall be forwarded to CEMVN Regulatory in accordance with the prescribed inspections, to be submitted under this permit number.

17. The permittee understands and agrees that if more than 20% of the survey measurements in any disposal area exceed the target elevation by more than six inches, additional actions to achieve the desired elevations may be required. Following a review of the monitoring reports, the regulatory and natural resource agencies will determine if remedial actions are necessary. Such actions could include grading of higher elevation areas to the target elevation or compensatory mitigation.

18. Appropriate erosion and siltation controls must be utilized during construction to prevent sediment runoff into adjacent wetlands and waterways. Sediment control techniques could include but are not limited to the use of secured hay bales, sediment fencing, wooden or vinyl barriers, and/or seeding of disturbed areas. These techniques should be maintained in effective operating condition until a point that sediment runoff from construction activities is controlled and maintained.

19. The permittee is advised of the requirements set forth in the attached Memorandum for Record and the associated special conditions. All responsibilities and compliance related to the subject conditions are hereby directed to and have oversight by the USACE Navigation Office, Operations Manager, ODC, Mrs. Tracy Falk, with this District. Should you have any questions on the requirements and restrictions stipulated, you shall contact the specified Operations Manager, who may be reached at 504-862-2971 or tracy.a.falk@usace.army.mil

20. The permittee shall adhere to the attached Manatee Special Conditions for In Water Use.

STANDARD MANATEE CONDITIONS FOR IN-WATER ACTIVITIES

During in-water work in areas that potentially support manatees, all personnel associated with the project shall be instructed and aware of the potential presence of manatees, manatee speed zones, and the need to avoid collisions with, and injury to, manatee. All personnel shall be advised that there are civil and criminal penalties for harming, harassing, or killing manatees which are protected under the Marine Mammal Protection Act of 1972 and the Endangered Species Act of 1973. Additionally, personnel shall be instructed not to attempt to feed or otherwise interact with the animal.

All on-site personnel are responsible for observing water-related activities for the presence of manatee(s). To minimize potential impacts to manatees in areas of their potential presence, the permittee shall insure the following are adhered to:

- All work, equipment, and vessel operation shall cease if a manatee is spotted within a 50-foot radius (buffer zone) of the active work area. Once the manatee has left the buffer zone on its own accord (manatees must not be herded or harassed into leaving), or after 30 minutes have passed without additional sightings of manatee(s) in the buffer zone, in-water work can resume under careful observation for manatee(s).
- If a manatee(s) is sighted in or near the project area, all vessels associated with the project shall operate at "no wake/idle" speeds within the construction area and at all times while in waters where the draft of the vessel provides less than a four-foot clearance from the bottom. Vessels shall follow routes of deep water whenever possible.
- If used, siltation or turbidity barriers shall be properly secured, made of material in which manatees cannot become entangled, and be monitored to avoid manatee entrapment or impeding their movement.
- Temporary signs concerning manatees shall be posted prior to and during all in-water project activities and removed upon completion. Each vessel involved in construction activities shall display at the vessel control station or in a prominent location, visible to all employees operating the vessel, a temporary sign at least 8½" X 11" reading language similar to the following: "CAUTION BOATERS: MANATEE AREA/ IDLE SPEED IS REQUIRED IN CONSTRUCTION AREA AND WHERE THERE IS LESS THAN FOUR FOOT BOTTOM CLEARANCE WHEN MANATEE IS PRESENT". A second temporary sign measuring 8½" X 11" shall be posted at a location prominently visible to all personnel engaged in water-related activities and shall read language similar to the following: "CAUTION: MANATEE AREA/ EQUIPMENT MUST BE SHUTDOWN IMMEDIATELY IF A MANATEE COMES WITHIN 50 FEET OF OPERATION".
- Collisions with, injury to, or sightings of manatees shall be immediately reported to the U.S. Fish and Wildlife Service's, Louisiana Ecological Services Office (337/291-3100) and the Louisiana Department of Wildlife and Fisheries, Natural Heritage Program (225/765-2821). Please provide the nature of the call (i.e., report of an incident, manatee sighting, etc.); time of incident/sighting; and the approximate location, including the latitude and longitude coordinates, if possible.

MEMORANDUM FOR RECORD: Chief, Regulatory Branch ATTN: Michael Hermann

SUBJECT: CPRA - Rabbit Island Restoration Project – Dredging of Calcasieu River - MVN-2018-01009-WLL

1. The Operations Manager for Calcasieu River navigation project (ODC) has reviewed the application from CPRA in regards to their Rabbit Island Restoration Project including dredging of Calcasieu River, in Cameron Parish, Louisiana.
2. It has been determined that the subject application is within the Calcasieu River navigation servitude but is outside of the navigation fairway limits. Therefore, this request has no impact to the usefulness of the project and will not be injurious to the public interest.

The scope of this analysis for Section 408 is limited to the federal limits of the Federal Navigation Channel. The application does not require a Section 408 permission in regards to impacts to the Calcasieu River, navigation project.

3. ODC has no objections to the subject request provided the following navigation conditions are included as part of the Section 10 permit document.
 - a. There shall be no unreasonable interference with navigation by the existence or use of the activity authorized herein.
 - b. Permittee shall closely coordinate all scheduling of proposed dredging work with the Operations Manager of the Calcasieu River (Tracy Falk) to assure no contractual conflicts arise between multiple dredging activities
 - c. Permittee shall provide its solicitation package to showing the selected burrowed area footprint, along with a cross section within the authorized navigation channel to USACE Engineering Division (CEMVN-EDC) for review and comment prior to procurement of bids and coordination of federal and state work packages should be closely coordinated in meetings.
 - d. Should the proposed structure or authorized work cause an obstruction or hazard to navigation, the applicant will be required, upon due notice from the Corps of Engineers, to remove, relocate or alter the work at their own expense.
 - e. The applicant will, at his or her expense, install and maintain any safety light, signals, and signs prescribed by the United States Coast Guard, through regulations or otherwise, on authorized facilities or on equipment used in performing work under the authorization.
 - f. If the authorized project, or future maintenance work, involves the use of floating construction equipment (barge mounted cranes, barge mounted pile driving equipment, floating dredge equipment, dredge discharge pipelines, etc.,) in the waterway, you are advised to notify the Coast Guard District so that a Notice to Mariners, if required, may be prepared. Notification with a copy of your permit approval and drawings should be mailed to the Commander (dpw), Eighth Coast Guard District, Hale Boggs Federal Building, 500 Poydras Street, Room 1230, New Orleans, Louisiana 70130, about 1 month before you plan to start work. Telephone inquiries can be directed to the Eighth Coast Guard District, Waterways Management at (504) 671-2107.

- g. The applicant understands and agrees that, if future operations by the United States require the removal, relocation, or other alteration, of the work herein authorized, or if, in the opinion of the Secretary of the Army or his authorized representative, said work shall cause unreasonable obstruction to the free navigation of the navigable waters, the applicant will be required upon due notice from the Corps of Engineers, to remove, relocate or alter the structural work or obstructions caused thereby, without expense to the United States. No claim shall be made against the United States on account of any such removal or alteration.

If you have any questions, please contact Michael Sullivan at 504-862-2373.

Sincerely,

SULLIVAN.MICHAEL.DAVID.1249725729
HAEL.DAVID.1249725729

Digitally signed by
SULLIVAN.MICHAEL.DAVID.1249725729
DN: c=US, o=U.S. Government, ou=DoD,
ou=PKI, ou=USA,
cn=SULLIVAN.MICHAEL.DAVID.1249725
729
Date: 2019.03.26 13:25:09 -05'00'

For
Tracy Falk
Operations Manager
Operations Division

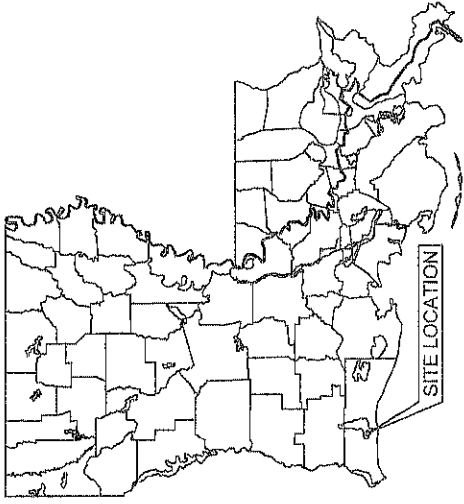
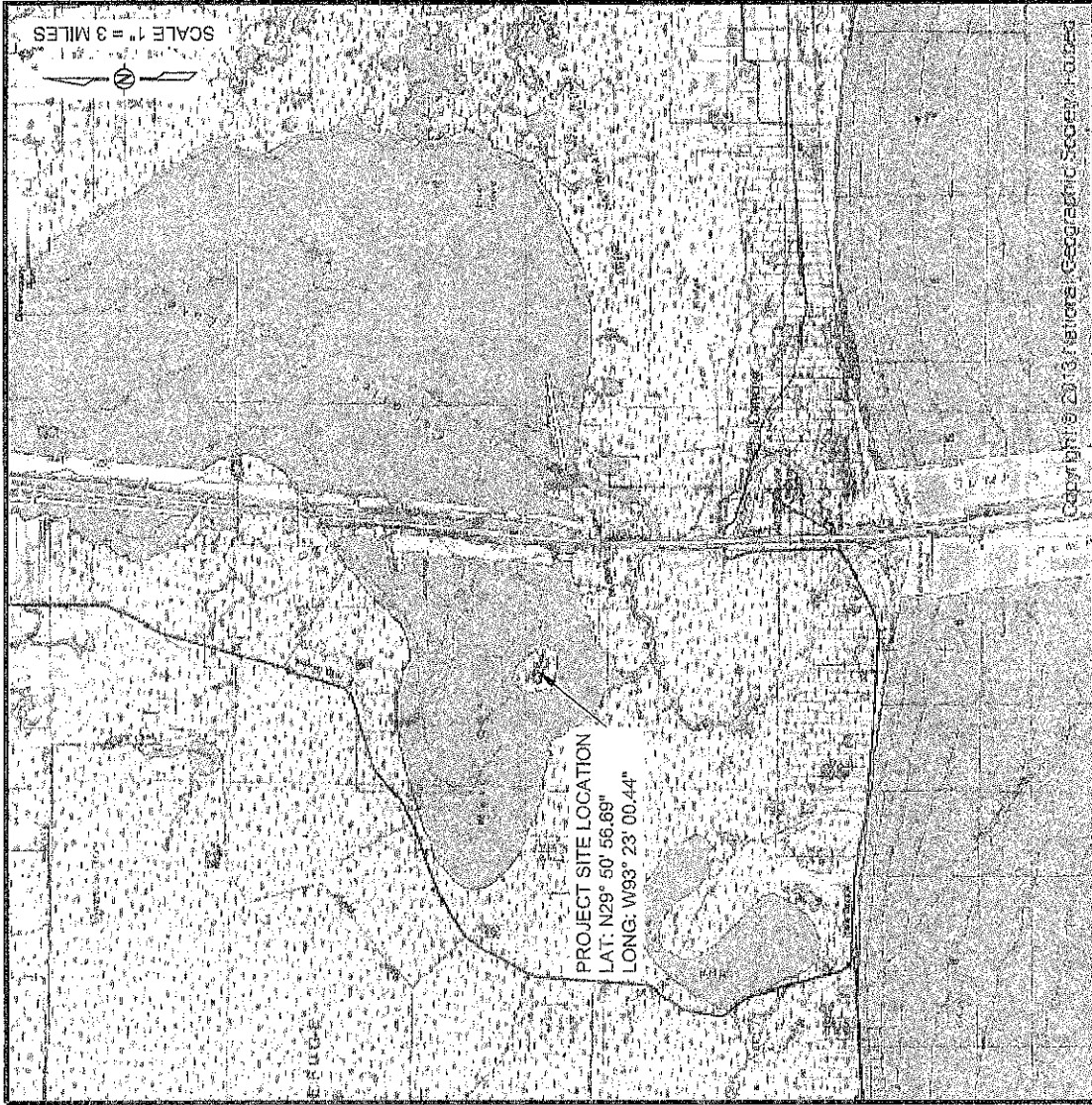

SHEET INDEX

- 1 - VICINITY MAP
- 2 - FILL AREA PLAN VIEW
- 3 - FILL AREA TYPICAL SECTION
- 4 - BORROW AREA PLAN VIEW
- 5 - BORROW AREA TYPICAL SECTION
- 6 - ACCESS ROUTE PLAN VIEW
- 7 - DREDGE PIPELINE TYPICAL SECTION
- 8 - GENERAL NOTES

THESE DRAWINGS WERE PREPARED EXCLUSIVELY FOR OBTAINING REGULATORY APPROVALS AND DO NOT PURPORT TO BE CONSTRUCTION DRAWINGS OR SPECIFICATIONS.

APPLICATION BY: COASTAL PROTECTION AND RESTORATION AUTHORITY 450 LAUREL STREET BATON ROUGE, LOUISIANA 70801	 ROYAL ENGINEERS	COASTAL PROTECTION AND RESTORATION AUTHORITY 450 LAUREL STREET BATON ROUGE, LOUISIANA 70801	RABBIT ISLAND RESTORATION	VICINITY MAP
DRAWN BY: REC	DESIGNED BY: LL	APPROVED BY: BT	STATE PROJECT NUMBER: CS-0080	DATE: 08/14/2018
			FEDERAL PROJECT NUMBER: CS-0080	SHEET 1 OF 8

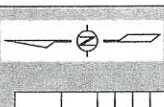

ESTIMATED FILL AREA QUANTITIES			
SITE	VOLUME (CY)	AREA (ACRES)	AREA (ACRES)
FA CELL 1 / +3.0 EL.	294,990	69.28	69.28
FA CELL 2 / +3.5 EL.	59,369	13.96	13.96
FA CELL 3 / +3.0 EL.	154,137	42.56	42.56
SLOPE TO NATURAL GROUND EL.	28,373	12.31	12.31

ESTIMATED EARTHEN CONTAINMENT QUANTITIES			
SITE	VOLUME (CY)	LENGTH (LF)	AREA (ACRES)
ECD	50,160	12,866.77	12.08

THE ESTIMATED TOTALS ARE SHOWN FOR INFORMATION PURPOSES ONLY.

LEGEND

+3.0 FT. EL.

+3.5 FT. EL.

SLOPE TO NATURAL GROUND EL.

MHW

MLW

CENTERLINE OF LEVEE

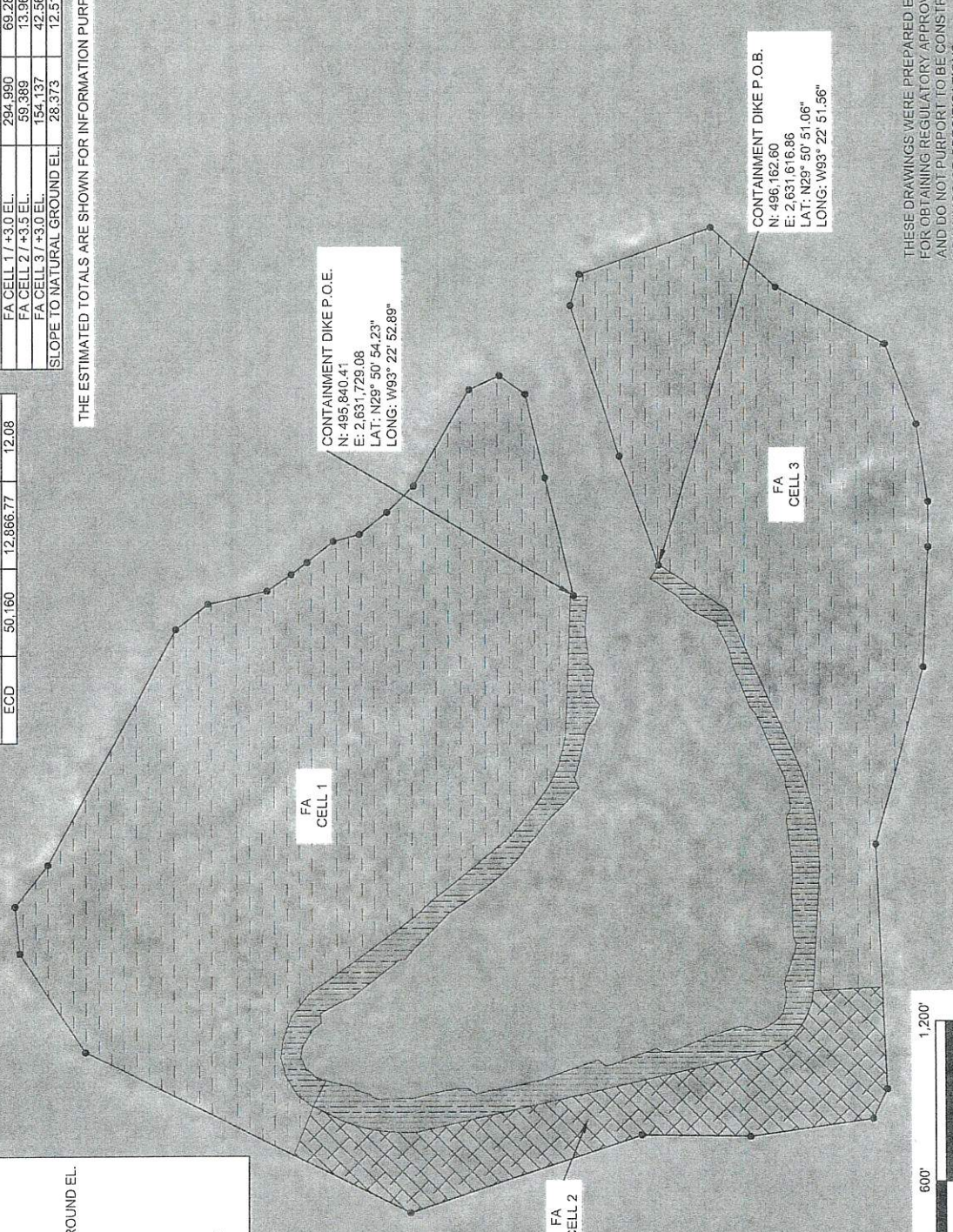

CONTAINMENT DIKE P.O.B.
 N: 495,840.41
 E: 2,631,728.08
 LAT: N29° 50' 54.23"
 LONG: W93° 22' 52.89"

CONTAINMENT DIKE P.O.B.
 N: 496,162.60
 E: 2,631,616.86
 LAT: N29° 50' 51.06"
 LONG: W93° 22' 51.56"

THESE DRAWINGS WERE PREPARED EXCLUSIVELY FOR OBTAINING REGULATORY APPROVALS AND DO NOT PURPORT TO BE CONSTRUCTION DRAWINGS OR SPECIFICATIONS.

APPLICATION BY: COASTAL PROTECTION AND RESTORATION AUTHORITY 450 LAUREL STREET BATON ROUGE, LOUISIANA 70801	 ROYAL ENGINEERS	COASTAL PROTECTION AND RESTORATION AUTHORITY 450 LAUREL STREET BATON ROUGE, LOUISIANA 70801	RABBIT ISLAND RESTORATION	FILL AREA PLAN VIEW
DRAWN BY: REC	DESIGNED BY: LL	APPROVED BY: BT	STATE PROJECT NUMBER: CS-0080 FEDERAL PROJECT NUMBER: CS-0080	DATE: 08/14/2018 SHEET 2 OF 8

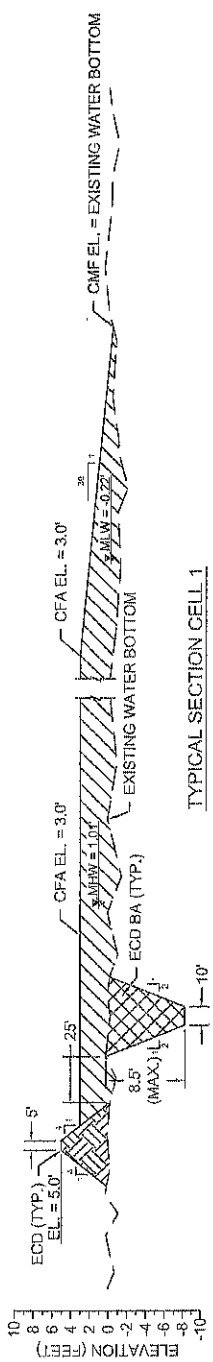

TYPICAL SECTION CELL 1

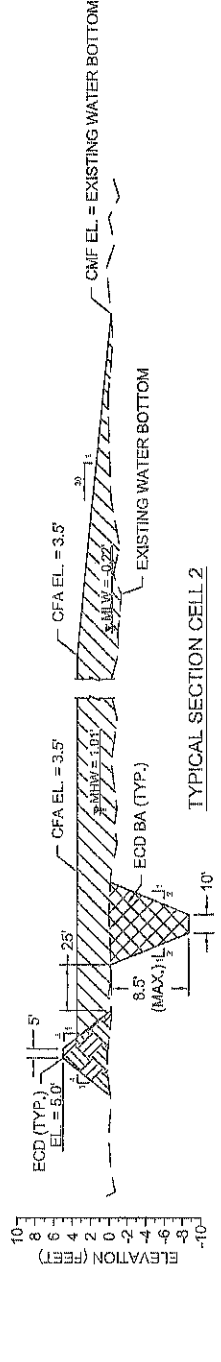

TYPICAL SECTION CELL 2

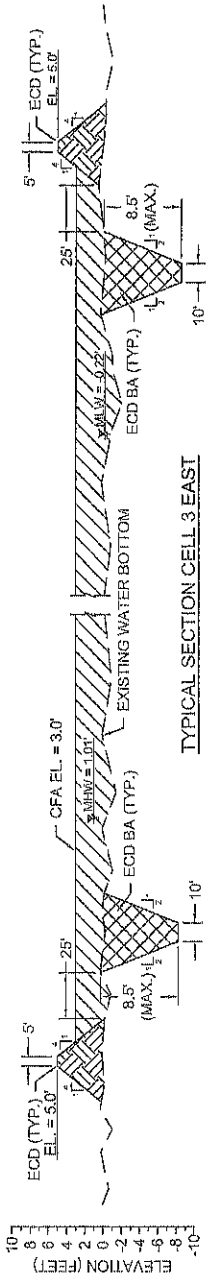

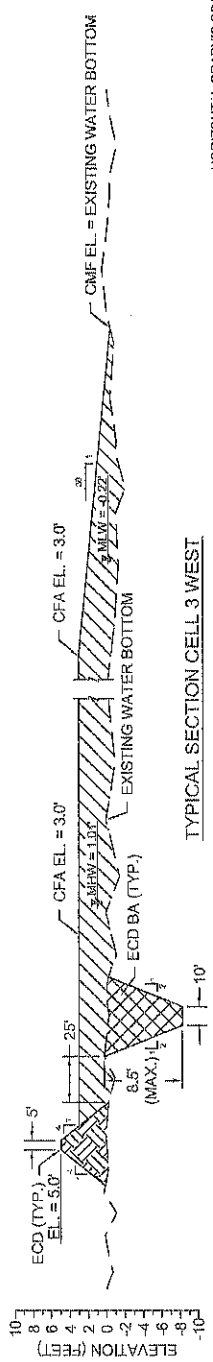

TYPICAL SECTION CELL 3 EAST

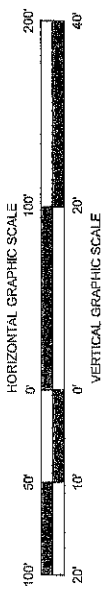

TYPICAL SECTION CELL 3 WEST

THESE DRAWINGS WERE PREPARED EXCLUSIVELY FOR OBTAINING REGULATORY APPROVALS AND DO NOT PURPORT TO BE CONSTRUCTION DRAWINGS OR SPECIFICATIONS.



APPLICATION BY: COASTAL PROTECTION AND RESTORATION AUTHORITY 450 LAUREL STREET BATON ROUGE, LOUISIANA 70801	  ROYAL ENGINEERS	COASTAL PROTECTION AND RESTORATION AUTHORITY 450 LAUREL STREET BATON ROUGE, LOUISIANA 70801	RABBIT ISLAND RESTORATION TYPICAL SECTIONS
DRAWN BY: REC	DESIGNED BY: LL	APPROVED BY: BT	FEDERAL PROJECT NUMBER: CS-0080 STATE PROJECT NUMBER: CS-0080 DATE: 08/14/2018 SHEET 3 OF 8

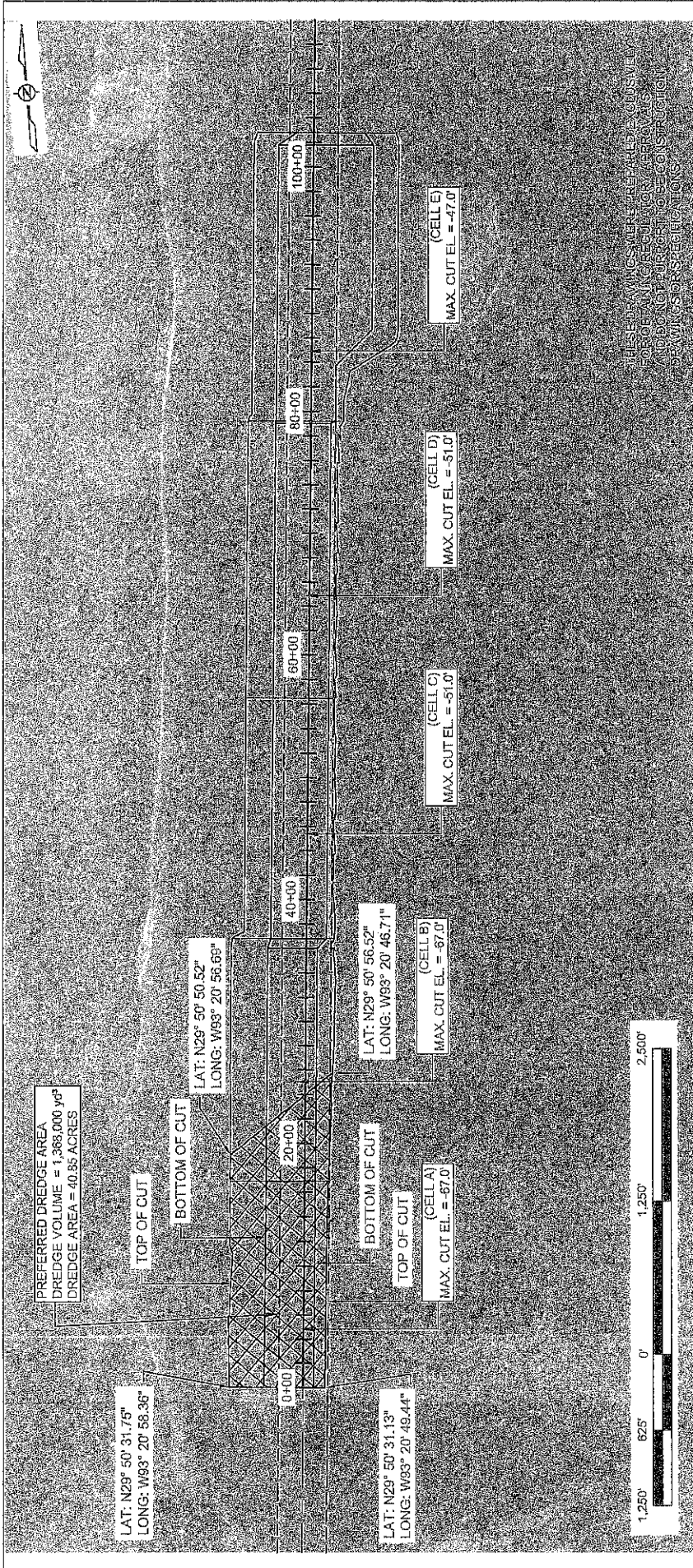

ESTIMATED BORROW AREA QUANTITIES

SITE	VOLUME (CY)	AREA (ACRES)
CELL A	1,022,636	30.59
CELL B	1,305,000	38.15
CELL C	1,464,000	33.16
CELL D	769,000	38.43
CELL E	1,334,000	59.35

NOTES:

1. THESE DRAWINGS DEPICT MAXIMUM BORROW AREA ACREAGE AND VOLUMES.
2. BORROW CELLS A THROUGH E WERE DELINEATED USING GEOTECHNICAL INFORMATION. THE PREFERRED BORROW AREA HAS BEEN IDENTIFIED AS CONTAINING THE MORE SUITABLE MATERIAL, HOWEVER THE OTHER DELINEATED BORROW CELLS MAY BE CONSIDERED AS A BORROW SOURCE IF REQUIRED.

APPLICATION BY: COASTAL PROTECTION AND RESTORATION AUTHORITY 450 LAUREL STREET BATON ROUGE, LOUISIANA 70801	 ROYAL ENGINEERS	COASTAL PROTECTION AND RESTORATION AUTHORITY 450 LAUREL STREET BATON ROUGE, LOUISIANA 70801	RABBIT ISLAND RESTORATION	BORROW AREA PLAN VIEW
DRAWN BY:	DESIGNED BY: LL	APPROVED BY: BT	STATE PROJECT NUMBER: CS-0080 FEDERAL PROJECT NUMBER: CS-0080	DATE: 08/14/2018 SHEET 4 OF 8

THESE DRAWINGS WERE PREPARED EXCLUSIVELY FOR OBTAINING REGULATORY APPROVALS AND DO NOT PURPORT TO BE CONSTRUCTION DRAWINGS OR SPECIFICATIONS.

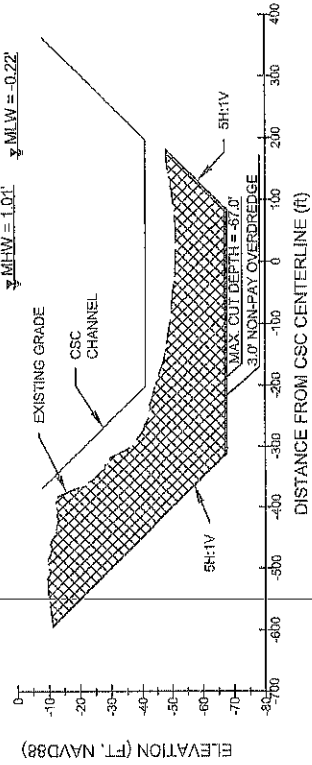

CELL A - TYPICAL SECTION

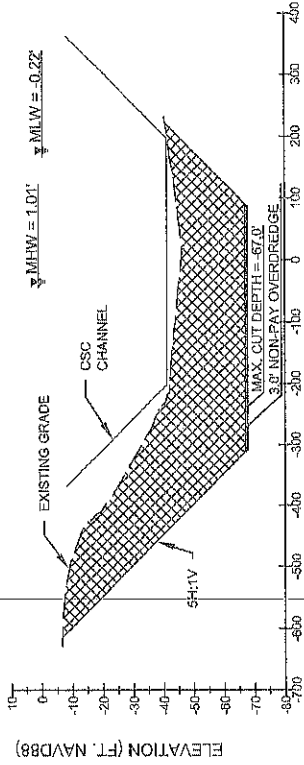

CELL B - TYPICAL SECTION

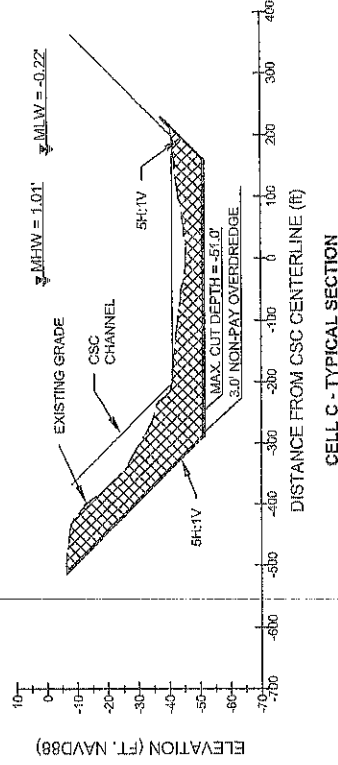

CELL C - TYPICAL SECTION

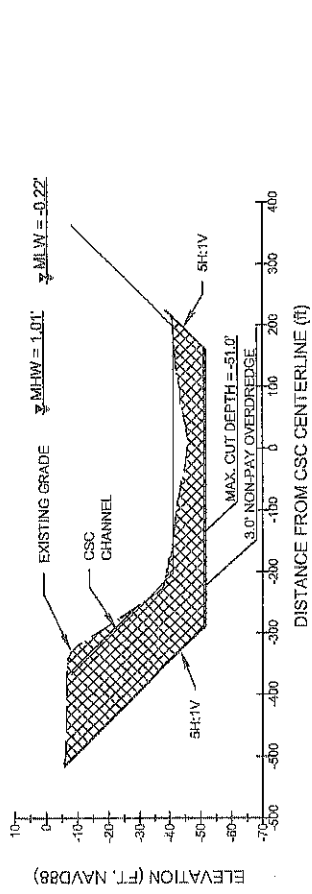

CELL D - TYPICAL SECTION

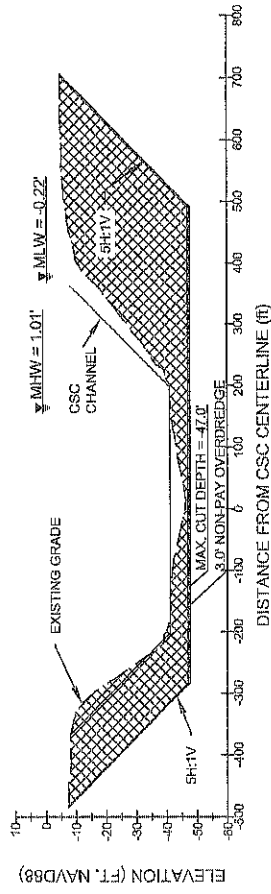

CELL E - TYPICAL SECTION

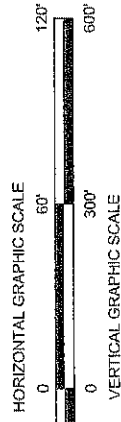

APPLICATION BY:
COASTAL PROTECTION AND RESTORATION AUTHORITY
450 LAUREL STREET
BATON ROUGE, LOUISIANA 70801



ROYAL ENGINEERS



COASTAL PROTECTION AND RESTORATION AUTHORITY
450 LAUREL STREET
BATON ROUGE, LOUISIANA 70801

RABBIT ISLAND RESTORATION

BORROW AREA TYPICAL SECTIONS

STATE PROJECT NUMBER: CS-0080

FEDERAL PROJECT NUMBER: CS-0080

DATE: 08/14/2018

SHEET 5 OF 8

DRAWN BY:

DESIGNED BY: LL

APPROVED BY: BT

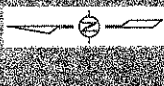

EQUIPMENT ACCESS CORRIDOR

	NORTHING	EASTING	LATITUDE	LONGITUDE
1	495,536.6128	2,641,609.5115	N29° 50' 49.79"	W93° 20' 59.31"
2	496,193.7254	2,637,328.4145	N29° 50' 55.54"	W93° 21' 48.05"
3	496,274.0237	2,652,763.7020	N29° 50' 55.54"	W93° 22' 39.67"

LEGEND

- FILL AREA
- BORROW AREA
- X.XX' DENOTES WATER DEPTHS REFERENCED TO MLW

WEST COVE

CALCASIEU LAKE

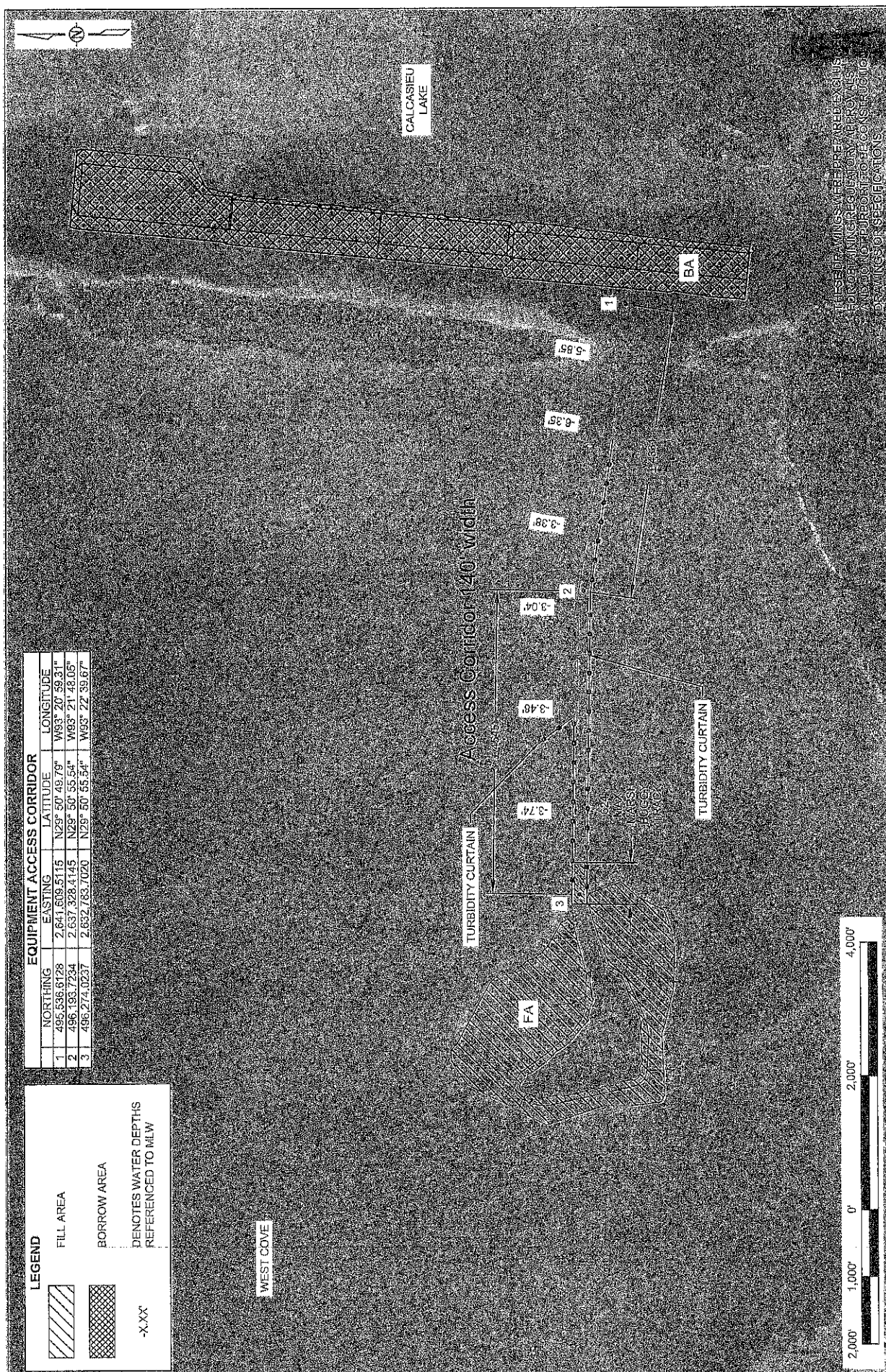

THESE DRAWINGS ARE PREPARED BY EXCLUSIVELY FOR THE PURPOSES OF THE PROJECT AND DO NOT REPRESENT THE CONSULTING ENGINEER'S SPECIFICATIONS.



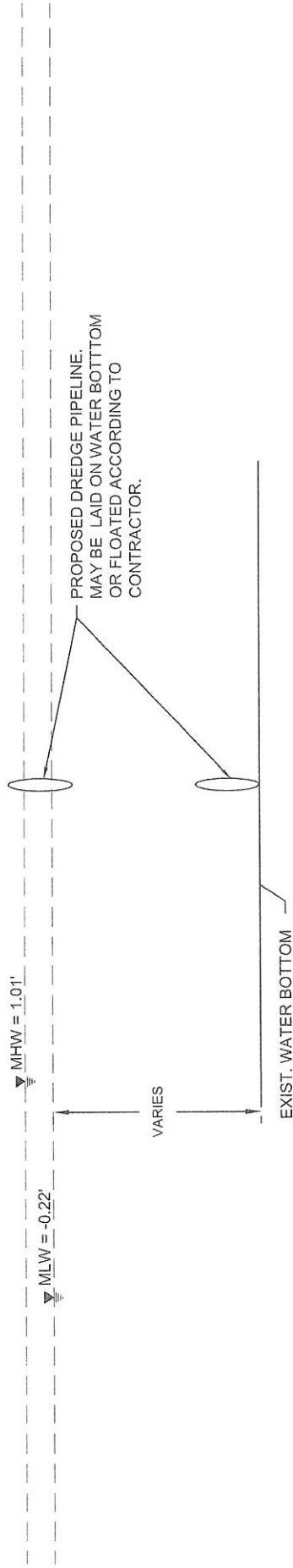

<p>APPLICATION BY: COASTAL PROTECTION AND RESTORATION AUTHORITY 450 LAUREL STREET BATON ROUGE, LOUISIANA 70801</p>	 ROYAL ENGINEERS	<p>COASTAL PROTECTION AND RESTORATION AUTHORITY 450 LAUREL STREET BATON ROUGE, LOUISIANA 70801</p>	<p>RABBIT ISLAND RESTORATION</p>	<p>ACCESS ROUTE PLAN VIEW</p>
<p>DRAWN BY: REC</p>	<p>DESIGNED BY: LL</p>	<p>APPROVED BY: BT</p>	<p>STATE PROJECT NUMBER: CS-0060</p>	<p>DATE: 08/14/2018</p>
			<p>FEDERAL PROJECT NUMBER: CS-0080</p>	<p>SHEET 6 OF 8</p>



DREDGE PIPELINE TYPICAL SECTION

NOTE: PIPELINE DIAMETER AND INSTALLATION VARIES ACCORDING TO CONTRACTOR.

THESE DRAWINGS WERE PREPARED EXCLUSIVELY FOR OBTAINING REGULATORY APPROVALS AND DO NOT PURPORT TO BE CONSTRUCTION DRAWINGS OR SPECIFICATIONS.

APPLICATION BY: COASTAL PROTECTION AND RESTORATION AUTHORITY 450 LAUREL STREET BATON ROUGE, LOUISIANA 70801	 ROYAL ENGINEERS 	COASTAL PROTECTION AND RESTORATION AUTHORITY 450 LAUREL STREET BATON ROUGE, LOUISIANA 70801 APPROVED BY: BT	RABBIT ISLAND RESTORATION STATE PROJECT NUMBER: CS-0080 FEDERAL PROJECT NUMBER: CS-0080	DREDGE PIPELINE TYPICAL SECTION DATE: 08/14/2018 SHEET 7 OF 8
DRAWN BY: REC	DESIGNED BY: LL			

GENERAL NOTES

1. THE PERMITTEE WILL COMPLY WITH ALL APPLICABLE LAWS REGARDING THE NEED TO CONTACT THE LOUISIANA ONE CALL SYSTEM (811) OR ONLINE AT http://www.laconecall.com/how_to_use_us.htm TO LOCATE ANY EXISTING UTILITIES.
2. EQUIPMENT TO BE USED: MARSH BUGGY EXCAVATOR, HYDRAULIC DREDGE, BARGE, AND WORK BOAT.
3. EQUIPMENT DRAFT:
 - MARSH BUGGY: 5.0'
 - DREDGE: 4.0'
 - BARGE: 3.0'
 - JOHN/WORK BOAT: 1.5'

THESE DRAWINGS WERE PREPARED EXCLUSIVELY FOR OBTAINING REGULATORY APPROVALS AND DO NOT PURPORT TO BE CONSTRUCTION DRAWINGS OR SPECIFICATIONS.

APPLICATION BY: COASTAL PROTECTION AND RESTORATION AUTHORITY 450 LAUREL STREET BATON ROUGE, LOUISIANA 70801	 ROYAL ENGINEERS	COASTAL PROTECTION AND RESTORATION AUTHORITY 450 LAUREL STREET BATON ROUGE, LOUISIANA 70801	RABBIT ISLAND RESTORATION STATE PROJECT NUMBER: CS-0080 FEDERAL PROJECT NUMBER: CS-0080	GENERAL NOTES DATE: 08/14/2018 SHEET 8 OF 8
DRAWN BY: REC	DESIGNED BY: LL	APPROVED BY: BT		