



FLORIDA DEPARTMENT OF Environmental Protection

Northwest District
160 W. Government Street, Suite 308
Pensacola, FL 32502

Ron DeSantis
Governor

Jeanette Nuñez
Lt. Governor

Noah Valenstein
Secretary

February 7, 2020

FROM:

Trust for Public Land
c/o Peter Fodor
306 N Monroe St.
Tallahassee, FL 32301
Pete.fodor@tpl.org

TO:

Gulf County Board of County Commissioners
c/o Sandy Quinn
1000 Cecil Costin Blvd.
Port St. Joe, FL 32456
commissioner4@gulfcounty-fl.gov

Re: File No. 0369442-002-EM/23
Transfer from File No. 0369442-001-EI/23

Dear Mr. Fodor and Mr. Quinn:

Enclosed is a copy of the executed transfer of permit for the referenced project. The transfer of this permit to the Gulf County Board of County Commissioners is hereby approved and effective as of the date of this letter. Please attach a copy of this letter and the enclosed transfer of permit to your permit and make them available on-site during construction. When referring to this project, please use the permit number indicated.

This notice of transfer does not alter the original expiration date, Specific or General Conditions, or monitoring requirements of the permit. This letter must be attached to the original permit.

NOTICE OF RIGHTS

This action is final and effective on the date filed with the Clerk of the Department unless a petition for an administrative hearing is timely filed under Sections 120.569 and 120.57, F.S., before the deadline for filing a petition. On the filing of a timely and sufficient petition, this action will not be final and effective until a subsequent order of the Department. Because the administrative hearing process is designed to formulate final agency action, the subsequent order may modify or take a different position than this action.

Petition for Administrative Hearing

A person whose substantial interests are affected by the Department's action may petition for an administrative proceeding (hearing) under Sections 120.569 and 120.57, F.S. Pursuant to Rules 28-106.201 and 28-106.301, F.A.C., a petition for an administrative hearing must contain the following information:

- (a) The name and address of each agency affected and each agency's file or identification number, if known;
- (b) The name, address, any e-mail address, any facsimile number, and telephone number of the petitioner, if the petitioner is not represented by an attorney or a qualified representative; the name, address, and telephone number of the petitioner's representative, if any, which shall be the address for service purposes during the course of the proceeding; and an explanation of how the petitioner's substantial interests will be affected by the agency determination;
- (c) A statement of when and how the petitioner received notice of the agency decision;
- (d) A statement of all disputed issues of material fact. If there are none, the petition must so indicate;
- (e) A concise statement of the ultimate facts alleged, including the specific facts that the petitioner contends warrant reversal or modification of the agency's proposed action;
- (f) A statement of the specific rules or statutes that the petitioner contends require reversal or modification of the agency's proposed action, including an explanation of how the alleged facts relate to the specific rules or statutes; and
- (g) A statement of the relief sought by the petitioner, stating precisely the action that the petitioner wishes the agency to take with respect to the agency's proposed action.

The petition must be filed (received by the Clerk) in the Office of General Counsel of the Department at 3900 Commonwealth Boulevard, Mail Station 35, Tallahassee, Florida 32399-3000, or via electronic correspondence at Agency_Clerk@dep.state.fl.us. Also, a copy of the petition shall be mailed to the applicant at the address indicated above at the time of filing.

Time Period for Filing a Petition

In accordance with Rule 62-110.106(3), F.A.C., petitions for an administrative hearing by the applicant and persons entitled to written notice under Section 120.60(3), F.S., must be filed within 21 days of receipt of this written notice. Petitions filed by any persons other than the applicant, and other than those entitled to written notice under Section 120.60(3), F.S., must be filed within 21 days of publication of the notice or within 21 days of receipt of the written notice, whichever occurs first. You cannot justifiably rely on the finality of this decision unless notice of this decision and the right of substantially affected persons to challenge this decision has been duly published or otherwise provided to all persons substantially affected by the decision. While you are not required to publish notice of this action, you may elect to do so pursuant Rule 62-110.106(10)(a).

The failure to file a petition within the appropriate time period shall constitute a waiver of that person's right to request an administrative determination (hearing) under Sections 120.569 and 120.57, F.S., or to intervene in this proceeding and participate as a party to it. Any subsequent intervention (in a proceeding initiated by another party) will be only at the discretion of the presiding officer upon the filing of a motion in compliance with Rule 28-106.205, F.A.C. If you

do not publish notice of this action, this waiver may not apply to persons who have not received a clear point of entry.

Extension of Time

Under Rule 62-110.106(4), F.A.C., a person whose substantial interests are affected by the Department's action may also request an extension of time to file a petition for an administrative hearing. The Department may, for good cause shown, grant the request for an extension of time. Requests for extension of time must be filed with the Office of General Counsel of the Department at 3900 Commonwealth Boulevard, Mail Station 35, Tallahassee, Florida 32399-3000, or via electronic correspondence at Agency_Clerk@FloridaDEP.gov, before the deadline for filing a petition for an administrative hearing. A timely request for extension of time shall toll the running of the time period for filing a petition until the request is acted upon.

Mediation

Mediation is not available in this proceeding.

FLAWAC Review

The applicant, or any party within the meaning of Section 373.114(1)(a) or 373.4275, F.S., may also seek appellate review of this order before the Land and Water Adjudicatory Commission under Section 373.114(1) or 373.4275, F.S. Requests for review before the Land and Water Adjudicatory Commission must be filed with the Secretary of the Commission and served on the Department within 20 days from the date when this order is filed with the Clerk of the Department.

Judicial Review

Once this decision becomes final, any party to this action has the right to seek judicial review pursuant to Section 120.68, F.S. by filing a Notice of Appeal pursuant to Florida Rules of Appellate Procedure 9.110 and 9.190 with the Clerk of the Department in the Office of General Counsel (Station #35, 3900 Commonwealth Boulevard, Tallahassee, Florida 32399-3000) and by filing a copy of the Notice of Appeal accompanied by the applicable filing fees with the appropriate district court of appeal. The notice must be filed within 30 days from the date this action is filed with the Clerk of the Department.

If you have any questions regarding this matter, please contact Jacob Hullett at the letterhead address, at 580-595-0638, or at Jacob.Hullett@FloridaDEP.gov .

EXECUTION AND CLERKING

Executed in Pensacola, Florida.

STATE OF FLORIDA DEPARTMENT OF ENVIRONMENTAL PROTECTION



Kimberly R. Allen
Permitting Program Administrator

KRA:jh

Attachments:

1. Permit File No. 0369442-001-EI/23, 35 pages
2. Permit Transfer Request, 3 pages

CERTIFICATE OF SERVICE

The undersigned duly designated deputy clerk hereby certifies that this document and all attachments were sent on the filing date below to the following listed persons:

Wade Dandridge, DEP, Wade.Dandridge@FloridaDEP.gov

Tanya McHale, DEP, tanya.mchale@floridadep.gov

Diana Athnos, DEP, diana.athnos@floridadep.gov

Jonathan Brucker, DEP, Aquatic Preserve Manager, jonathan.brucker@FloridaDEP.gov

Dylan Shoemaker, DEP, St. Joe Bay State Buffer Preserve, Dylan.shoemaker@FloridaDEP.gov

Gulf County:, bocc@gulfcounty-fl.gov, janderson@psj.fl.gov, zachary_hodges@doh.state.fl.us
maiken@gulfcounty-fl.gov, lcollinsworth@gulfcounty-fl.gov, billy@visitgulf.com

FILING AND ACKNOWLEDGMENT

FILED, on this date, pursuant to Section 120.52, F.S., with the designated Department Clerk, receipt of which is hereby acknowledged.



Clerk

February 7, 2020

Date

Request to Transfer Environmental Resource Permit

Instructions: To be completed, executed, and submitted by the new owner to the Agency within 30 days after any transfer of ownership or control of the real property where the permitted activity is located.

Use of this form is not required when a valid permit is in the operation and maintenance phase. In such case, the owner must notify the Agency in writing within 30 days of a change in ownership or control of the entire real property, project, or activity covered by the permit. The notification may be by letter or e-mail, or through use of this form, and must be sent to the office that issued the permit. A processing fee is not required for this notice. The permit shall automatically transfer to the new owner or person in control, except in cases of abandonment, revocation, or modification of a permit as provided in Sections 373.426 and 373.429, F.S. (2013). If a permittee fails to provide written notice to the Agency within 30 days of the change in ownership or control, or if the change does not include the entire real property or activity covered by the permit, then the transfer must be requested using this form.

Permit No: 0369442-001-EI/23 Application
No(s):

Acres to be Transferred: 7.25

Permitted Project: Salinas Park Addition

Proposed Project Name (if different):

Phase of Project (if applicable):

I hereby notify the Agency that I have acquired ownership or control of the land on which the permitted system is located through the sale or other legal transfer of the land. By signing below, I hereby certify that I have sufficient real property interest or control in the land in accordance with subsection 4.2.3(d) of Applicant's Handbook Volume I; attached is a copy of my title, easement, or other demonstration of ownership or control in the land, including any revised plats, as recorded in the Public Records. I request that the permit be modified to reflect that I agree to be the new permittee. By so doing, I acknowledge that I have examined the permit terms, conditions, and drawings, and agree to accept all rights and obligations as permittee, including agreeing to be liable for compliance with all of the permit terms and conditions, and to be liable for any corrective actions required as a result of any violations of the permit after approval of this modification by the Permitting Agency. Also attached are copies of any recorded restrictive covenants, articles of incorporation, and certificate of incorporation that may have been changed as a result of my assuming ownership or control of the lands. As necessary, I agree to furnish the Agency with demonstration that I have the ability to provide for the operation and maintenance of the system for the duration of the permit in accordance with subsection 12.3 of Applicant's Handbook Volume I.

Name of Proposed Permittee: Gulf County Board of County Commissioners

Mailing Address: 1000 Cecil Costin Blvd.

City: Port St Joe

State: FL

Zip: 32456

Telephone:

E-mail:

Signature of Proposed Permittee

Date: 1/28/20

Sandy Quinn, Chairman
Name and Title

RECEIVED

JAN 31 2020



Northwest Florida DEP

Enclosures:

- Copy of title, easement, or other demonstration of ownership or control in the land, as recorded in the Public Records
- Copy of current plat(s) (if any), as recorded in the Public Records
- Copy of current recorded restrictive covenants and articles of incorporation (if any)
- Other



Parcel Summary

Parcel ID 06314-003R
 Location Address CAPE SAN BLAS RD
 PORT ST JOE 32456
 Brief Tax Description* S 23 T 9 R 11 864 FT BAY FRONT ORB 635/638 FR PS ENTERPRISES ET AL ORB 682/97 FR THE TRUST FOR PUBLIC LAND MAP 54C
 *The Description above is not to be used on legal documents.
 Property Use Code VACANT (000000)
 Sec/Twp/Rng 23-9S-11W
 Tax District St Joe Fire Zone (District 4)
 Millage Rate 14.0717
 Acreage 7.250
 Homestead N

View Map

RECEIVED

JAN 31 2020

Owner Information

Primary Owner
 Gulf County
 Board Of County Commissioners
 1000 C G Costin Blvd
 Port St Joe, FL 32456

Northwest Florida DEP

Land Information

Code	Land Use	Number of Units	Unit Type	Frontage	Depth
000120	BAY FF	864.00	FF	0	0

Sales

Multi Parcel	Sale Date	Sale Price	Instrument	Book	Page	Qualification	Vacant/Improved	Grantor	Grantee
N	12/18/2019	\$100	SW	682	97	Unqualified (U)	Vacant	THE TRUST FOR PUBLIC LAND	BOARD OF COUNTY COMMISSIONERS
N	02/28/2018	\$912,000	WD	635	638	Unqualified (U)	Vacant	PS ENTERPRISES OF PC LTD ET AL	THE TRUST FOR PUBLIC LAND
N	02/27/2018	\$0	WD	643	377	Unqualified (U)	Vacant	THE TRUST FOR PUBLIC LAND	GULF COUNTY BOARD OF COUNTY COMMISSIONERS
N	10/18/2006	\$100	QC	421	146	Unqualified (U)	Vacant	PATRONIS JOHNNY	PS ENTERPRISES OF PC LTD ET AL
N	04/17/2002	\$100	WD	278	664	Unqualified (U)	Vacant	PATRONIS J. SR	PATRONIS JOHN J & THEOLOGOS PATRONIS (TRUSTEES)
N	04/13/1998	\$100	QC	212	573	Unqualified (U)	Vacant	PATRONIS, TRUSTEES	PATRONIS
N	12/12/1994	\$100	QC	175	635	Unqualified (U)	Vacant	PATRONIS	PATRONIS
N	01/01/1982	\$310,000		88	599	Unqualified (U)	Vacant		

Valuation

	2019 Certified Values	2018 Certified Values
Building Value	\$0	\$0
Extra Features Value	\$0	\$0
Land Value	\$950,400	\$950,400
Land Agricultural Value	\$0	\$0
Agricultural (Market) Value	\$0	\$0
Just (Market) Value	\$950,400	\$950,400
Assessed Value	\$950,400	\$950,400
Exempt Value	\$950,400	\$950,400
Taxable Value	\$0	\$0
Maximum Save Our Homes Portability	\$0	\$0

"Just (Market) Value" description - This is the value established by the Property Appraiser for ad valorem purposes. This value does not represent anticipated selling price.

No data available for the following modules: Residential Buildings, Commercial Buildings, Extra Features, Sketches.



FLORIDA DEPARTMENT OF Environmental Protection

Northwest District
160 W. Government Street, Suite 308
Pensacola, FL 32502

Ron DeSantis
Governor

Jeanette Nuñez
Lt. Governor

Noah Valenstein
Secretary

Permittee/Authorized Entity:

Trust for Public Land
c/o Peter Fodor
306 N Monroe Street
Tallahassee, Florida 32301, Leon County
Pete.fodor@tpl.org

Salinas Park Addition

Authorized Agent:

Valerie Weeks
2408 Tippecanoe Road
Tallahassee, Florida 32303
val@weeksenvironmental.com

Environmental Resource Permit

State-owned Submerged Lands Authorization – Not Applicable

**U.S. Army Corps of Engineers Authorization – Separate Corps Authorization
Required**

Gulf County
Permit No.: 0369442-001-EI/23

Permit Issuance Date: January 23, 2019
Permit Construction Phase Expiration Date: January 23, 2024

Environmental Resource Permit

Permittee: Trust for Public Land

Permit No: 0369442-001-EI/23

PROJECT LOCATION

The activities authorized by this permit are located at Salinas Park Addition, parcel no. 06314-003R, 280 Cape San Blas Road, Port Saint Joe, Florida 32456, in Section 23, Township 09 South, Range 11 West in Gulf County, at 29°41'9.6919" North Latitude, 85°18'50.4585" West Longitude.

PROJECT DESCRIPTION

The permittee is authorized to construct an elevated boardwalk with viewing platforms within unnamed Class III wetlands associated with the St Joseph Bay Aquatic Preserve, a Class II Outstanding Florida Waterbody, Approved Shellfish Harvesting Area. In addition, the permittee is authorized to install three (3) six-foot wide sidewalk crossings with 18 inch culverts through the adjacent roadside ditch. Authorized activities are depicted on the attached exhibits.

Wetland impacts: approximately 20 square feet of fill in the form of support pilings for the boardwalk and viewing platforms; and approximately 2,500 square feet of elevated boardwalk and viewing platforms over wetlands.

Other construction consisting of park amenities will be constructed on uplands and do not require an ERP authorization.

AUTHORIZATIONS

Salinas Park Addition

Environmental Resource Permit

The Department has determined that the activity qualifies for an Environmental Resource Permit. Therefore, the Environmental Resource Permit is hereby granted, pursuant to Part IV of Chapter 373, Florida Statutes (F.S.), and Chapter 62-330, Florida Administrative Code (F.A.C.).

Sovereignty Submerged Lands Authorization

As staff to the Board of Trustees of the Internal Improvement Trust Fund (Board of Trustees), the Department has determined the activity is not on submerged lands owned by the State of Florida. Therefore, your project is not subject to the requirements of Chapter 253, F.S., or Rule 18-21, F.A.C.

Federal Authorization

Your proposed activity as outlined on your application and attached drawings **does not qualify** for federal authorization pursuant to the State Programmatic General Permit and a **SEPARATE permit** or authorization **shall be required** from the U.S. Army Corps of Engineers (Corps). You must apply separately to the Corps using the federal application form (ENG 4345). More information about Corps permitting may be found online in the Jacksonville District Regulatory Division Sourcebook. **Failure to obtain Corps authorization prior to construction could subject you to federal enforcement action by that agency.**

Authority for review – an agreement with the Corps entitled “Coordination Agreement Between the U. S. Army Corps of Engineers (Jacksonville District) and the Florida Department of Environmental Protection, or Duly Authorized Designee, State Programmatic General Permit,” Section 10 of the Rivers and Harbor Act of 1899, and Section 404 of the Clean Water Act.

Coastal Zone Management

Issuance of this authorization also constitutes a finding of consistency with Florida’s Coastal Zone Management Program, as required by Section 307 of the Coastal Zone Management Act.

Water Quality Certification

This permit also constitutes a water quality certification under Section 401 of the Clean Water Act, 33 U.S.C. 1341.

Other Authorizations

You are advised that authorizations or permits for this activity may be required by other federal, state, regional, or local entities including but not limited to local governments or municipalities. This permit does not relieve you from the requirements to obtain all other required permits or authorizations.

The activity described may be conducted only in accordance with the terms, conditions and attachments contained in this document. Issuance and granting of the permit and authorizations herein do not infer, nor guarantee, nor imply that future permits, authorizations, or modifications will be granted by the Department.

PERMIT CONDITIONS

The activities described must be conducted in accordance with:

- **The Specific Conditions**
- **The General Conditions**
- **The limits, conditions and locations of work shown in the attached drawings**
- **The term limits of this authorization**

You are advised to read and understand these conditions and drawings prior to beginning the authorized activities, and to ensure the work is conducted in conformance with all the terms, conditions, and drawings herein. If you are using a contractor, the contractor also should read and understand these conditions and drawings prior to beginning any activity. Failure to comply with these conditions, including any mitigation requirements, shall be grounds for the Department to revoke the permit and authorization and to take appropriate enforcement action. Operation of the facility is not authorized except when determined to be in conformance with all applicable rules and this permit as described.

SPECIFIC CONDITIONS – ADMINISTRATIVE/EMERGENCIES

1. The construction phase expires at 11:59 p.m. on the date indicated on the cover page of this permit.
2. For emergencies involving a serious threat to the public health, safety, welfare, or environment, the emergency telephone contact number is (800) 320-0519 (State Warning Point).

The Department telephone number for reporting nonthreatening problems or system malfunctions is (850) 595-0663, day or night.

3. The mailing address for submittal of forms for the “Construction Commencement Notice”, “As-Built Certification ...”, “Request for Conversion of Stormwater Management Permit Construction Phase to Operation and Maintenance Phase”, or other correspondence is FDEP, SLERP, 160 W Government Street, Pensacola, FL 32502.

SPECIFIC CONDITIONS – PRIOR TO ANY CONSTRUCTION

4. Areas of exposed soils shall be isolated from wetlands or other surface waters to prevent erosion and deposition of these soils into wetlands or other surface waters during permitted activities.

5. The following measures shall be taken by the permittee whenever siltation, sedimentation, or erosion occurs within wetlands outside of the limits of the authorized activities:

- a. Immediately cease all work contributing to the violation.
- b. Stabilize all exposed soils contributing to the violation. Modify the work procedures that were responsible for the violation and install more erosion, sedimentation, and turbidity control devices.
- c. Notify the Department within 24 hours of the time the violation occurred at (850) 595-8300.

SPECIFIC CONDITIONS – CONSTRUCTION ACTIVITIES

6. If the approved permit drawings and/or narrative conflict with the Specific Conditions, then the Specific Conditions shall prevail.

7. The permittee shall be responsible for ensuring that erosion control devices/procedures are inspected and maintained daily during all phases of construction authorized by this permit until all areas that were disturbed during construction are sufficiently stabilized to prevent erosion, siltation, and turbid discharges.

8. There shall be no storage or stockpiling of tools or materials (e.g., lumber, pilings, debris, etc.) within wetlands, along the shoreline within the littoral zone, or elsewhere within waters of the state.

9. Construction equipment shall not be repaired or refueled in wetlands or elsewhere within waters of the state.

10. Any damage to wetlands outside of the authorized impact areas as a result of construction shall be immediately reported to the Department at (850)595-8300 and repaired by reestablishing the pre-construction elevations and replanting vegetation of the same species, size, and density as that in the adjacent areas. The restoration shall be completed within 30 days of completion of construction, and the Department shall be notified of its completion within that same 30-day period.

11. This permit does not authorize the entrenchment of water, sewer, cable or utility lines within wetlands.

12. Construct of the boardwalk in wetlands will be from above or “top down” to ensure that no heavy equipment disturbs or comes into contact with the ground during construction. No cranes, matting, diesel drop hammers or jetting of piles will be used in wetlands.

13. To protect wetland resources when present, the elevation of the decking shall be a minimum of five feet above wetland grade and shall have a minimum of 1/2-inch spacing between deck planks.

14. Pilings installed in wetlands will be installed on 10 foot centers.

GENERAL CONDITIONS FOR INDIVIDUAL PERMITS

The following general conditions are binding on all individual permits issued under chapter 62-330, F.A.C., except where the conditions are not applicable to the authorized activity, or where the conditions must be modified to accommodate project-specific conditions.

1. All activities shall be implemented following the plans, specifications and performance criteria approved by this permit. Any deviations must be authorized in a permit modification in accordance with Rule 62-330.315, F.A.C. Any deviations that are not so authorized may subject the permittee to enforcement action and revocation of the permit under Chapter 373, F.S.

2. A complete copy of this permit shall be kept at the work site of the permitted activity during the construction phase, and shall be available for review at the work site upon request by the Agency staff. The permittee shall require the contractor to review the complete permit prior to beginning construction.

3. Activities shall be conducted in a manner that does not cause or contribute to violations of state water quality standards. Performance-based erosion and sediment control best management practices shall be installed immediately prior to, and be maintained during and after construction as needed, to prevent adverse impacts to the water resources and adjacent lands. Such practices shall be in accordance with the *State of Florida Erosion and Sediment Control Designer and Reviewer Manual* (Florida Department of Environmental Protection and Florida Department of Transportation June 2007), and the *Florida Stormwater Erosion and Sedimentation Control Inspector's Manual* (Florida Department of Environmental Protection, Nonpoint Source Management Section, Tallahassee, Florida, July 2008), which are both incorporated by reference in subparagraph 62-330.050(9)(b)5., F.A.C., unless a project-specific erosion and sediment control plan is approved or other water quality control measures are required as part of the permit.

4. At least 48 hours prior to beginning the authorized activities, the permittee shall submit to the Agency a fully executed Form 62-330.350(1), “Construction Commencement Notice,” [October 1, 2013], which is incorporated by reference in paragraph 62-330.350(1)(d), F.A.C., indicating the expected start and completion dates. A copy of this form may be obtained from

the Agency, as described in subsection 62-330.010(5), F.A.C. If available, an Agency website that fulfills this notification requirement may be used in lieu of the form.

5. Unless the permit is transferred under Rule 62-330.340, F.A.C., or transferred to an operating entity under Rule 62-330.310, F.A.C., the permittee is liable to comply with the plans, terms and conditions of the permit for the life of the project or activity.

6. Within 30 days after completing construction of the entire project, or any independent portion of the project, the permittee shall provide the following to the Agency, as applicable:

- a. For an individual, private single-family residential dwelling unit, duplex, triplex, or quadruplex – “Construction Completion and Inspection Certification for Activities Associated With a Private Single-Family Dwelling Unit” [Form 62-330.310(3)]; or
- b. For all other activities – “As-Built Certification and Request for Conversion to Operational Phase” [Form 62-330.310(1)].
- c. If available, an Agency website that fulfills this certification requirement may be used in lieu of the form.

7. If the final operation and maintenance entity is a third party:

- a. Prior to sales of any lot or unit served by the activity and within one year of permit issuance, or within 30 days of as- built certification, whichever comes first, the permittee shall submit, as applicable, a copy of the operation and maintenance documents (see sections 12.3 thru 12.3.3 of Volume I) as filed with the Department of State, Division of Corporations and a copy of any easement, plat, or deed restriction needed to operate or maintain the project, as recorded with the Clerk of the Court in the County in which the activity is located.
- b. Within 30 days of submittal of the as- built certification, the permittee shall submit “Request for Transfer of Environmental Resource Permit to the Perpetual Operation Entity” [Form 62-330.310(2)] to transfer the permit to the operation and maintenance entity, along with the documentation requested in the form. If available, an Agency website that fulfills this transfer requirement may be used in lieu of the form.

8. The permittee shall notify the Agency in writing of changes required by any other regulatory agency that require changes to the permitted activity, and any required modification of this permit must be obtained prior to implementing the changes.

9. This permit does not:

- a. Convey to the permittee any property rights or privileges, or any other rights or privileges other than those specified herein or in Chapter 62-330, F.A.C.;
- b. Convey to the permittee or create in the permittee any interest in real property;
- c. Relieve the permittee from the need to obtain and comply with any other required federal, state, and local authorization, law, rule, or ordinance; or
- d. Authorize any entrance upon or work on property that is not owned, held in easement, or controlled by the permittee.

10. Prior to conducting any activities on state-owned submerged lands or other lands of the state, title to which is vested in the Board of Trustees of the Internal Improvement Trust Fund, the permittee must receive all necessary approvals and authorizations under Chapters 253 and 258, F.S.

Written authorization that requires formal execution by the Board of Trustees of the Internal Improvement Trust Fund shall not be considered received until it has been fully executed.

11. The permittee shall hold and save the Agency harmless from any and all damages, claims, or liabilities that may arise by reason of the construction, alteration, operation, maintenance, removal, abandonment or use of any project authorized by the permit.

12. The permittee shall notify the Agency in writing:

- a. Immediately if any previously submitted information is discovered to be inaccurate; and
- b. Within 30 days of any conveyance or division of ownership or control of the property or the system, other than conveyance via a long-term lease, and the new owner shall request transfer of the permit in accordance with Rule 62-330.340, F.A.C. This does not apply to the sale of lots or units in residential or commercial subdivisions or condominiums where the stormwater management system has been completed and converted to the operation phase.

13. Upon reasonable notice to the permittee, Agency staff with proper identification shall have permission to enter, inspect, sample and test the project or activities to ensure conformity with the plans and specifications authorized in the permit.

14. If any prehistoric or historic artifacts, such as pottery or ceramics, stone tools or metal implements, dugout canoes, or any other physical remains that could be associated with Native American cultures, or early colonial or American settlement are encountered at any time within the project site area, work involving subsurface disturbance in the immediate vicinity of such discoveries shall cease. The permittee or other designee shall contact the Florida Department of State, Division of Historical Resources, Compliance and Review Section, at (850) 245-6333 or (800) 847-7278, as well as the appropriate permitting agency office. Such subsurface work shall not resume without verbal or written authorization from the Division of Historical Resources. If unmarked human remains are encountered, all work shall stop immediately and notification shall be provided in accordance with Section 872.05, F.S.

15. Any delineation of the extent of a wetland or other surface water submitted as part of the permit application, including plans or other supporting documentation, shall not be considered binding unless a specific condition of this permit or a formal determination under Rule 62-330.201, F.A.C., provides otherwise.

16. The permittee shall provide routine maintenance of all components of the stormwater management system to remove trapped sediments and debris. Removed materials shall be disposed of in a landfill or other uplands in a manner that does not require a permit under Chapter 62-330, F.A.C., or cause violations of state water quality standards.

17. This permit is issued based on the applicant's submitted information that reasonably demonstrates that adverse water resource-related impacts will not be caused by the completed permit activity. If any adverse impacts result, the Agency will require the permittee to eliminate the cause, obtain any necessary permit modification, and take any necessary corrective actions to resolve the adverse impacts.

18. A Recorded Notice of Environmental Resource Permit may be recorded in the county public records in accordance with subsection 62-330.090(7), F.A.C. Such notice is not an encumbrance upon the property.

NOTICE OF RIGHTS

This action is final and effective on the date filed with the Clerk of the Department unless a petition for an administrative hearing is timely filed under Sections 120.569 and 120.57, F.S. before the deadline for filing a petition. On the filing of a timely and sufficient petition, this action will not be final and effective until further order of the Department. Because the administrative hearing process is designed to formulate final agency action, the hearing process may result in a modification of the agency action or even denial of the application.

Petition for Administrative Hearing

A person whose substantial interests are affected by the Department's action may petition for an administrative proceeding (hearing) under Sections 120.569 and 120.57, F.S. Pursuant to Rules 28-106.201 and 28-106.301, F.A.C., a petition for an administrative hearing must contain the following information:

- (a) The name and address of each agency affected and each agency's file or identification number, if known;
- (b) The name, address, and telephone number of the petitioner; the name, address, and telephone number of the petitioner's representative, if any, which shall be the address for service purposes during the course of the proceeding; and an explanation of how the petitioner's substantial interests are or will be affected by the agency determination;
- (c) A statement of when and how the petitioner received notice of the agency decision;
- (d) A statement of all disputed issues of material fact. If there are none, the petition must so indicate;
- (e) A concise statement of the ultimate facts alleged, including the specific facts that the petitioner contends warrant reversal or modification of the agency's proposed action;
- (f) A statement of the specific rules or statutes that the petitioner contends require reversal or modification of the agency's proposed action, including an explanation of how the alleged facts relate to the specific rules or statutes; and
- (g) A statement of the relief sought by the petitioner, stating precisely the action that the petitioner wishes the agency to take with respect to the agency's proposed action.

The petition must be filed (received by the Clerk) in the Office of General Counsel of the Department at 3900 Commonwealth Boulevard, Mail Station 35, Tallahassee, Florida 32399-3000, or via electronic correspondence at Agency_Clerk@dep.state.fl.us. Also, a copy of the petition shall be mailed to the applicant at the address indicated above at the time of filing.

Time Period for Filing a Petition

In accordance with Rule 62-110.106(3), F.A.C., petitions for an administrative hearing by the applicant and persons entitled to written notice under Section 120.60(3), F.S., must be filed within 21 days of receipt of this written notice. Petitions filed by any persons other than the applicant, and other than those entitled to written notice under Section 120.60(3), F.S., must be filed within 21 days of publication of the notice or within 21 days of receipt of the written notice, whichever occurs first. The failure to file a petition within the appropriate time period

shall constitute a waiver of that person's right to request an administrative determination (hearing) under Sections 120.569 and 120.57, F.S. or to intervene in this proceeding and participate as a party to it. Any subsequent intervention (in a proceeding initiated by another party) will be only at the discretion of the presiding officer upon the filing of a motion in compliance with Rule 28 106.205, F.A.C.

Extension of Time

Under Rule 62-110.106(4), F.A.C., a person whose substantial interests are affected by the Department's action may also request an extension of time to file a petition for an administrative hearing. The Department may, for good cause shown, grant the request for an extension of time. Requests for extension of time must be filed with the Office of General Counsel of the Department at 3900 Commonwealth Boulevard, Mail Station 35, Tallahassee, Florida 32399-3000, or via electronic correspondence at Agency_Clerk@dep.state.fl.us, before the deadline for filing a petition for an administrative hearing. A timely request for extension of time shall toll the running of the time period for filing a petition until the request is acted upon.

Mediation

Mediation is not available in this proceeding.

FLAWAC Review

The applicant, or any party within the meaning of Section 373.114(1)(a) or 373.4275, F.S., may also seek appellate review of this order before the Land and Water Adjudicatory Commission under Section 373.114(1) or 373.4275, F.S. Requests for review before the Land and Water Adjudicatory Commission must be filed with the Secretary of the Commission and served on the Department within 20 days from the date when this order is filed with the Clerk of the Department.

Judicial Review

Once this decision becomes final, any party to this action has the right to seek judicial review pursuant to Section 120.68, F.S. by filing a Notice of Appeal pursuant to Florida Rules of Appellate Procedure 9.110 and 9.190 with the Clerk of the Department in the Office of General Counsel (Station #35, 3900 Commonwealth Boulevard, Tallahassee, Florida 32399-3000) and by filing a copy of the Notice of Appeal accompanied by the applicable filing fees with the appropriate district court of appeal. The notice must be filed within 30 days from the date this action is filed with the Clerk of the Department.

Thank you for applying to the Submerged Lands and Environmental Resource Permit Program. If you have any questions regarding this matter, please contact Diana Athnos at the letterhead address, at (850)595-0557, or at diana.athnos@FloridaDEP.gov

EXECUTION AND CLERKING

Executed in Orlando, Florida.

STATE OF FLORIDA DEPARTMENT OF ENVIRONMENTAL PROTECTION



For Kimberly R. Allen
Permitting Program Administrator

Attachment: Exhibit 1, Project Drawings and Design Specs., 25 pages

Copies of 62-330 forms may be obtained at: <https://floridadep.gov/water/submerged-lands-environmental-resources-coordination/content/forms-environmental-resource>

CERTIFICATE OF SERVICE

The undersigned duly designated deputy clerk hereby certifies that this document and all attachments were sent on the filing date below to the following listed persons:

Kimberly R. Allen, DEP, Kim.Allen@FloridaDEP.gov

Tanya McHale, DEP, tanya.mchale@floridadep.gov

Diana Athnos, DEP, diana.athnos@floridadep.gov

Jonathan Brucker, DEP, Aquatic Preserve Manager, jonathan.brucker@FloridaDEP.gov

Dylan Shoemaker, DEP, St. Joe Bay State Buffer Preserve, Dylan.shoemaker@FloridaDEP.gov

Gulf County:

bocc@gulfcounty-fl.gov

janderson@psj.fl.gov

zachary_hodges@doh.state.fl.us

maiken@gulfcounty-fl.gov

lcollinsworth@gulfcounty-fl.gov

billy@visitgulf.com

FILING AND ACKNOWLEDGMENT

FILED, on this date, pursuant to Section 120.52, F.S., with the designated Department Clerk, receipt of which is hereby acknowledged.

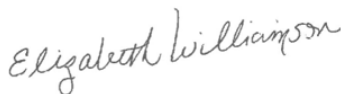

Clerk

January 23, 2019

Date

100% CONSTRUCTION DOCUMENTS SALINAS PARK GULF COUNTY

280 CAPE SAN BLAS RD.
CAPE SAN BLAS, FL



DRAWING INDEX

- C-0: COVER SHEET
- C-1: SITE PLAN
- C-2: GRADING PLAN
- C-3: BOARDWALK ELEVATIONS AND RADIUS
- C-4: WEST TRAIL HEAD PROFILE
- C-5: MIDDLE TRAIL HEAD PROFILE
- C-6: EAST TRAIL HEAD PROFILE
- C-7: 10' WIDE BOARDWALK PROFILE
- C-8: 10' WIDE BOARDWALK PROFILE
- C-9: 6' WIDE BOARDWALK PROFILE
- C-10: WEST TRAIL HEAD PROFILE
- C-11: MIDDLE TRAIL HEAD PROFILE
- C-12: EAST TRAIL HEAD PROFILE
- S-1: NOTES
- S-2: BOARDWALK DETAILS
- S-3: BOARDWALK DETAILS
- S-4: 10' WIDE BOARDWALK DETAILS
- S-5: CROSS BRACING DETAILS
- S-6: WEST AND EAST OBSERVATION PLATFORM
- S-7: PEAK OBSERVATION PLATFORM
- S-8: NOTES
- S-9: 6' WIDE BOARDWALK DETAILS
- S-10: 6' WIDE BOARDWALK DETAILS
- S-11: 6' WIDE BOARDWALK TERMINUS PLAN
- S-12: PEAK OBSERVATION ELEVATION

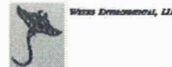

SITE INFORMATION:
PARCEL TAX ID # 06314-0001
SITE ADDRESS 280 CAPE SAN BLAS RD.
TOTAL SITE AREA 7.69 ACRES (334,967 SQ FT)
PROPOSED USE COUNTY PARK (PUBLIC FACILITY)

SUBMITTAL DATES

1 DESIGN DEVELOPMENT PACKAGE FOR CLIENT REVIEW	AUG 16, 2016
2 60% CONSTRUCTION DOCUMENTS PACKAGE FOR CLIENT REVIEW	
3 90% CONSTRUCTION DOCUMENTS PACKAGE FOR CLIENT REVIEW	OCT 9, 2016
4 100% CONSTRUCTION DOCUMENTS PACKAGE FOR CLIENT REVIEW	

UTILITIES:
WATER LIGHTHOUSE UTILITIES

FLOOD INFORMATION:
THIS PROPERTY LIES IN ZONE "X"
PER FEMA FIRM PANEL 10010C015F
DATED 8/15/2009

OWNER:
TRUST FOR PUBLIC LAND
308 N BROADWAY ST.
TALLAHASSEE, FL 32301
(850) 222-7911

ENGINEER:
PARKER CONSULTING SERVICES, INC.
3849 KILLEARN CENTER CT
TALLAHASSEE, FL 32309
PH (850) 877-8600

CONTRACTOR:
JD JAMES CONSTRUCTION SERVICES
1506 WILSON BLVD
MOUNTAIN VIEW, FL 32579
(904) 833-1111
www.jdjamesbridge.com

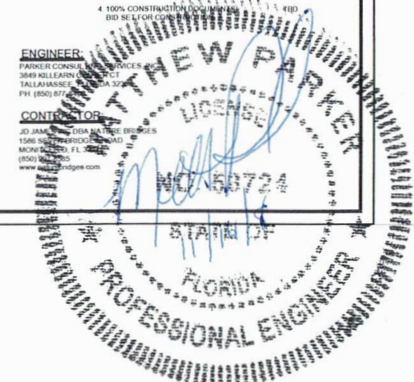

C-1

SITE PLAN

DRAWN BY: JLF	DATE: 11/12/18
REVIEWED BY: JWP	DATE: 11/14/18

REVISION DATE:	REVISION:
----------------	-----------

REVISION DATE:	REVISION:
----------------	-----------

SALINAS PARK GULF COUNTY
280 CAPE SAN BLAS RD
CAPE SAN BLAS, FL

PARKER ENGINEERING
CONSULTING SERVICES, INC.
CIVIL ENGINEERS
3819 KILPATRICK BLVD
TALLAHASSEE, FL 32308
MATTHEW PARKER
PROFESSIONAL ENGINEER

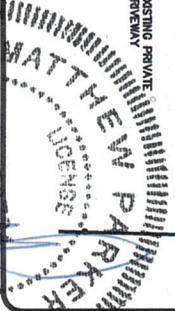
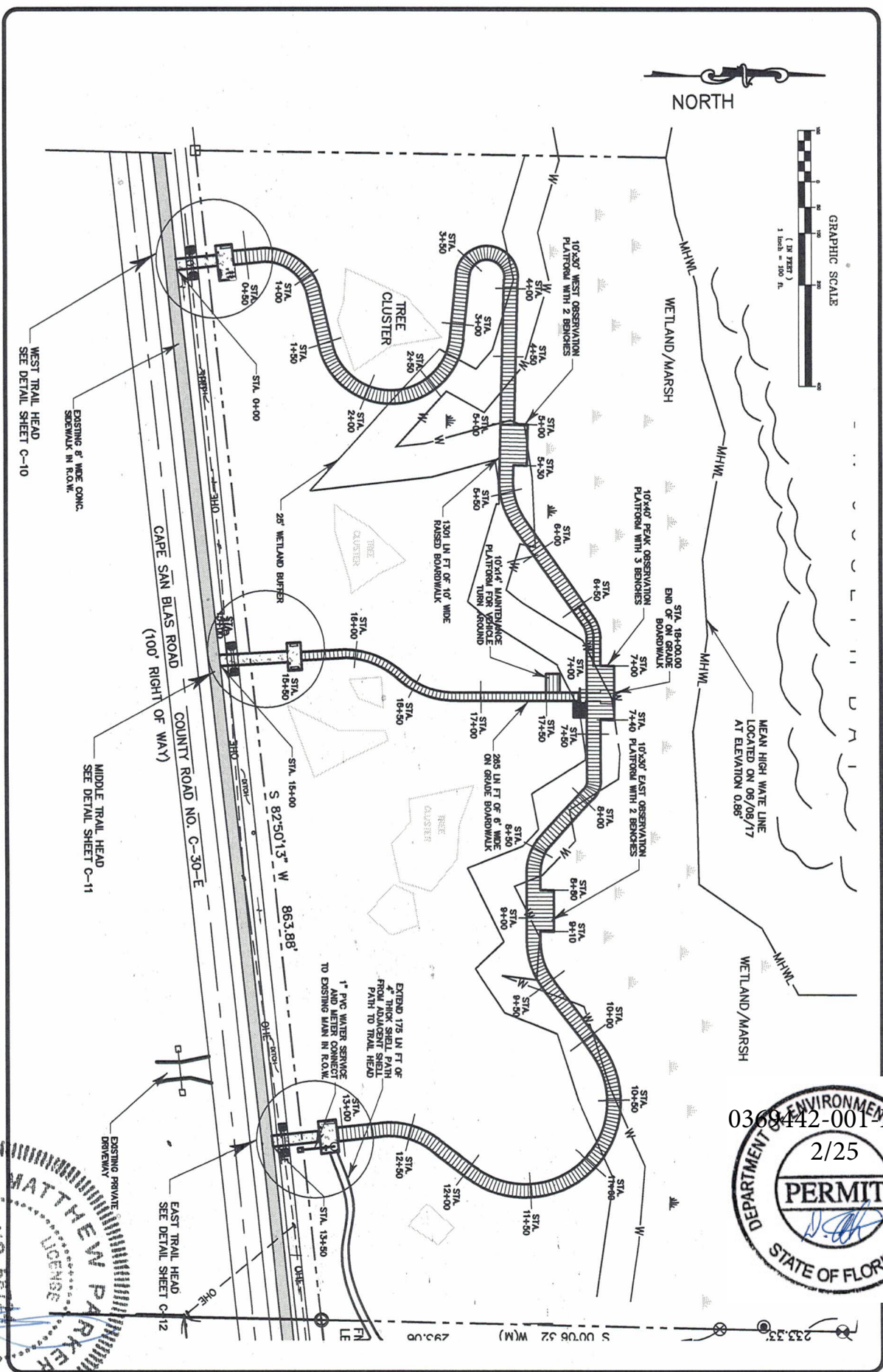

C-2

GRADING PLAN

DRAWN BY: LMF
REVIEWED BY: NP

DATE: 11/12/18
REVISION DATE:

REVISION:

SALINAS PARK GULF COUNTY
280 CAPE SAN BLAS RD
CAPE SAN BLAS, FL

PARKER
CONSULTING SERVICES, INC.
CIVIL ENGINEERS

3810 RICHLEIGH CENTER
TALLAHASSEE, FL 32308
MATTHEW PARKER, P.E. 8501
TEL: 904.877.8800
FAX: 904.877.8803

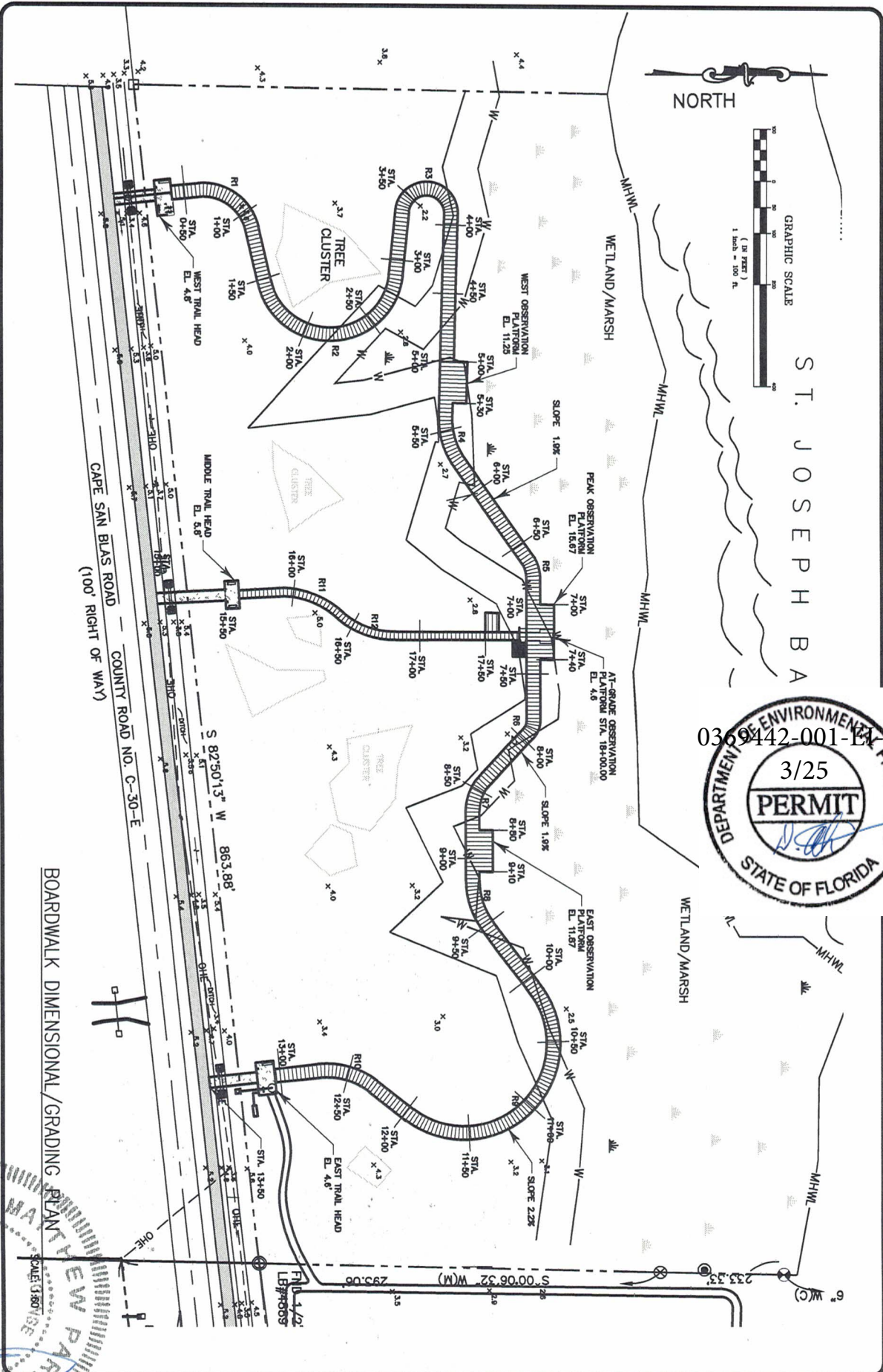

0369442-001-LA-23



BOARDWALK DIMENSIONAL/GRADING PLAN
SCALE: 1/8" = 1'-0"



STATION	ELEVATION	NOTES
0+00.00'	5.1'	START ELEVATED B.W.
0+50.00'	4.8'	
1+00.00'	5.52'	
1+50.00'	6.25'	
2+00.00'	6.88'	
2+50.00'	7.68'	
3+00.00'	8.39'	
3+50.00'	9.10'	
4+00.00'	9.81'	
4+50.00'	10.53'	
5+00.00'	11.25'	
5+50.00'	11.95'	
6+00.00'	12.68'	
6+50.00'	13.35'	
7+00.00'	14.48'	
7+50.00'	15.45'	
8+00.00'	15.67'	
8+50.00'	14.72'	
9+00.00'	13.77'	
9+50.00'	12.82'	
10+00.00'	11.87'	
10+30.00'	11.87'	
10+90.00'	11.45'	
11+00.00'	10.33'	
11+90.00'	9.23'	
12+00.00'	8.15'	
12+50.00'	7.05'	
13+00.00'	5.95'	
13+50.00'	4.00'	END ELEVATED B.W.
15+00.00'	5.30'	START ON GRADE B.W.
15+50.00'	5.40'	
16+00.00'	6.20'	
16+90.00'	5.00'	
17+00.00'	4.80'	
17+50.00'	4.80'	
18+00.00'	4.80'	END ON GRADE B.W.

RADIUS	STARTING STATION	ENDING STATION	RADIUS
R1	0+82.00'	1+13.00'	36'
R2	1+53.00'	2+80.00'	48'
R3	3+37.00'	3+83.00'	18'
R4	5+39.00'	5+70.00'	53'
R5	6+82.00'	6+74.00'	26'
R6	7+78.00'	7+81.00'	14'
R7	8+41.00'	8+82.00'	35'
R8	9+12.00'	9+47.00'	54'
R9	10+07.00'	11+82.00'	65'
R10	12+28.00'	12+86.00'	95'
R11	15+82.00'	18+38.00'	63'
R12	16+38.00'	18+82.00'	58'

C-3

BOARDWALK ELEVATIONS & RADIUS

DRAWN BY/LMF	DATE: 11/17/18	REVISION DATE:
REVIEWED BY: MP	DATE: 11/14/18	REVISION DATE:

SALINAS PARK GULF COUNTY
280 CAPE SAN BLAS RD
CAPE SAN BLAS, FL

PARKER
CONSULTING SERVICES INC.
CIVIL ENGINEERS
3890 BULLARD CENTER DR
TALLAHASSEE, FL 32308, PHONE: (904) 777-8900
MATTHEW PARKER, P.E. 51874

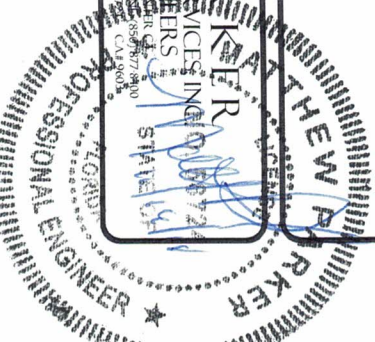

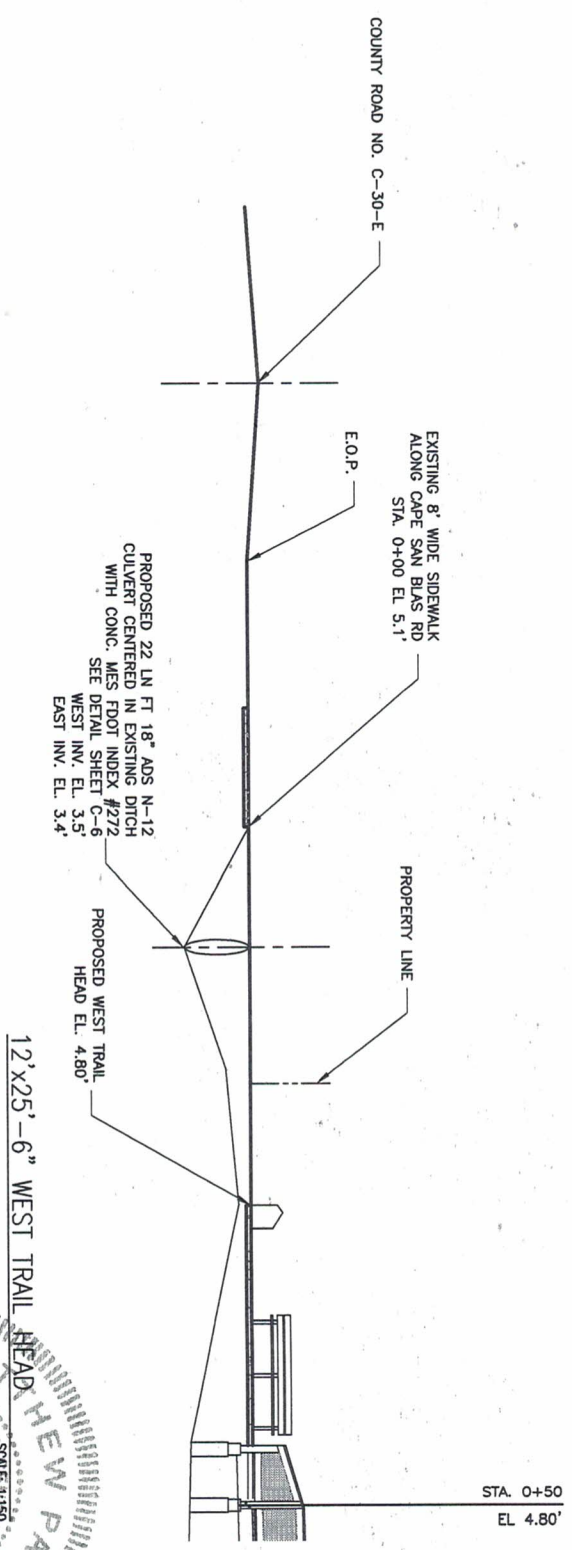
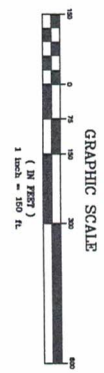

STA. 0+50
EL. 4.80'

12'x25'-6" WEST TRAIL HEAD

SCALE 1/160

DRAWN BY: LMF	DATE: 11/12/18
REVIEWED BY: MP	DATE: 11/14/18

REVISION DATE:	
----------------	--

REVISION:	
-----------	--

SALINAS PARK GULF COUNTY
280 CAPE SAN BLAS RD
CAPE SAN BLAS, FL

C-4

WEST TRAIL
HEAD
PROFILE

PARKER
CONSULTING SERVICES, INC.
CIVIL ENGINEERS
3849 BILDERMAN CENTER CT
TALLAHASSEE, FL 32309 PHONE (850) 878-6000
MATTHEW PARKER P.E. LICENSE NO. 12527

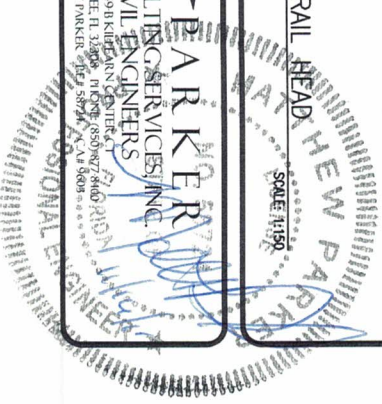

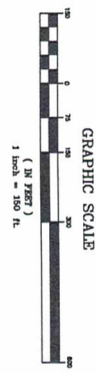

STA. 14+00
EL. 4.00'

PROPOSED EAST TRAIL
HEAD EL. 5.8'

PROPERTY LINE

PROPOSED 22 LN FT 18" ADS N-12
CULVERT CENTERED IN EXISTING DITCH
WITH CONC. MES. FOOT INDEX #272
SEE DETAIL SHEET C-6
WEST INV. EL. 3.7'
EAST INV. EL. 3.6'

E.O.P.

EXISTING 8' WIDE SIDEWALK
ALONG CAPE SAN BLAS RD

COUNTY ROAD NO. C-30-E

10'x20' MIDDLE TRAIL



C-5

MIDDLE
TRAIL HEAD
PROFILE

DRAWN BY: LMF
REVIEWED BY: MP
DATE: 11/12/18
DATE: 11/14/18

REVISION DATE:
REVISION DATE:

REVISION:
REVISION:

SALINAS PARK GULF COUNTY
280 CAPE SAN BLAS RD
CAPE SAN BLAS, FL

PARKER
CONSULTING SERVICES, INC.
CIVIL ENGINEERS
3890 BULLIARD CENTER
TALLAHASSEE, FL 32308
MATTHEW PARKER, P.E. 58724

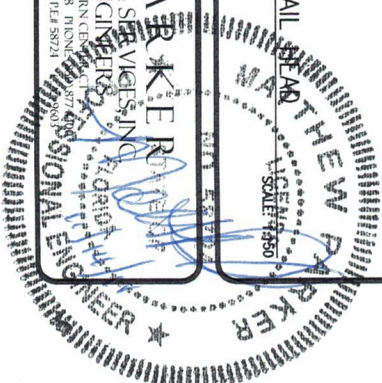

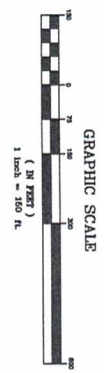

PROPOSED 22 LN FT 18" ADS N-12
CULVERT CENTERED IN EXISTING DITCH
WITH CONC. MES FDOT INDEX #272
SEE DETAIL SHEET C-6
WEST INV. EL. 3.4'
EAST INV. EL. 3.3'

13'x24' EAST TRAIL HEAD

SCALE: 1"=50'



C-6

EAST TRAIL
HEAD
PROFILE

DRAWN BY: LMF
REVIEWED BY: MP
DATE: 11/12/18
DATE: 11/14/18

REVISION DATE:
REVISION DATE:

REVISION:
REVISION:

SALINAS PARK GULF COUNTY
280 CAPE SAN BLAS RD
CAPE SAN BLAS, FL

PARKER
CONSULTING SERVICES, INC.
CIVIL ENGINEERS
3849 BULLOCK N. CENTER CT.
TALLAHASSEE, FL 32308-2706
MATTHEW PARKER
REGISTERED PROFESSIONAL ENGINEER
FLORIDA LICENSE # 11000

C-7

10' WIDE BOARDWALK PROFILE

DRAWN BY: LMF	DATE: 11/12/18	REVISION
REVIEWED BY: MP	DATE: 11/14/18	REVISION



CAPE SAN BLAS, FL
 ARK GULF COUNTY
 E SAN BLAS RD

PARKER
 CONSULTING SERVICES, INC.
 CIVIL ENGINEERS
 3819 DUTCHMAN CENTER CT
 TALLAHASSEE, FL 32309
 MATTHEW PARKER (850) 937-8100

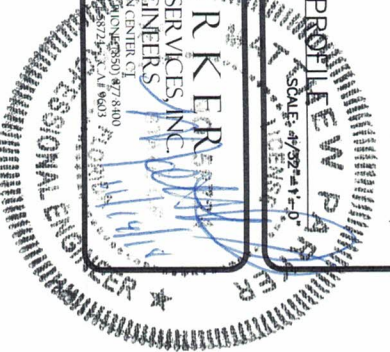

10' WIDE BOARDWALK PROFILE W/ PARALLEL WETLANDS

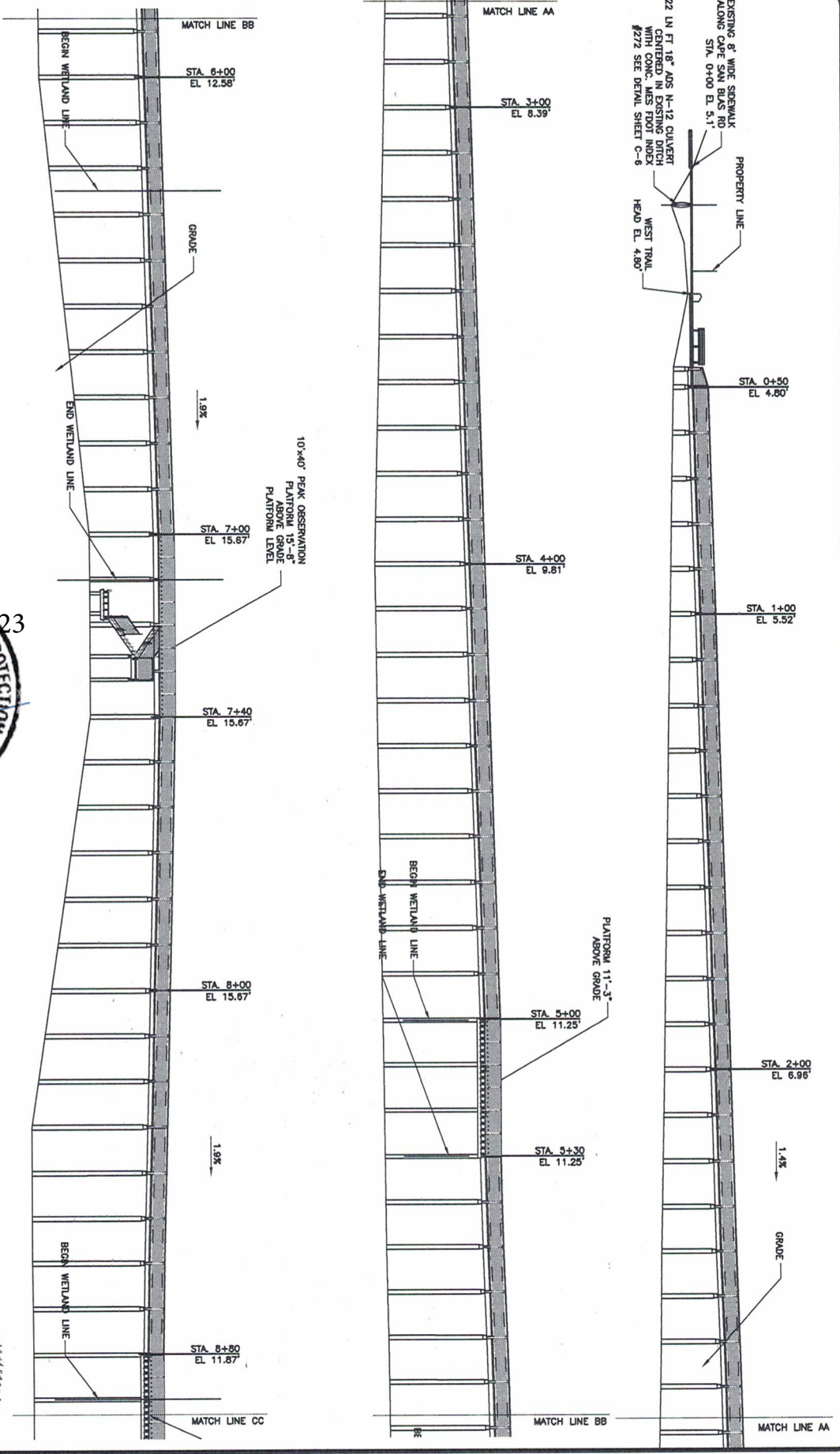

C-8

10' WIDE BOARDWALK PROFILE

DRAWN BY: LMF
REVIEWED BY: MP

DATE: 11/12/18
DATE: 11/14/18

REVISION DATE:
REVISION:

SALINAS PARK GULF COUNTY
280 CAPE SAN BLAS RD
CAPE SAN BLAS, FL

PARKER
CONSULTING SERVICES, INC.
CIVIL ENGINEERS
3899 BULLIARD, CENEX CT
TALLAHASSEE, FL 32308 PHONE: 904.833.4000
MATTHEW PARKER P.E. #2272

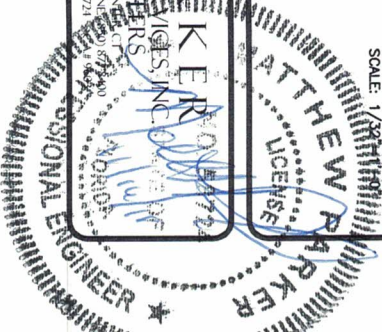

10' WIDE BOARDWALK PROFILE

SCALE: 1/8"=1'-0"

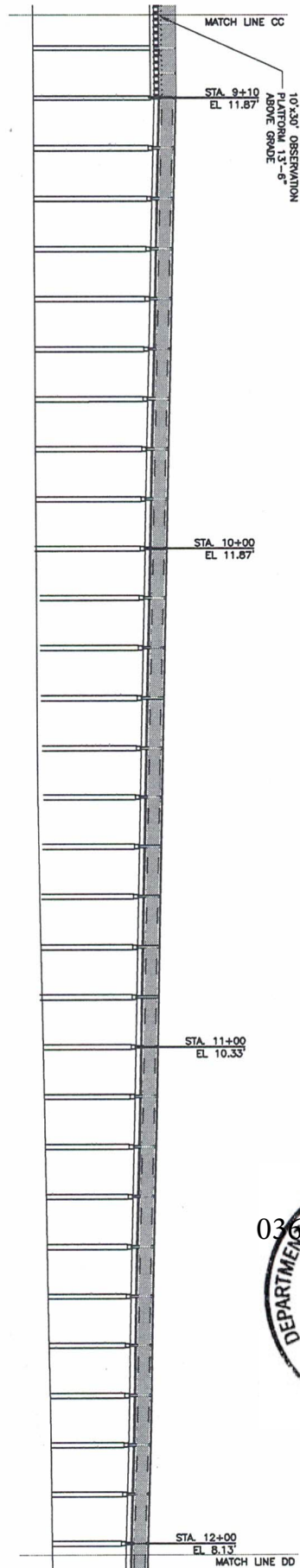
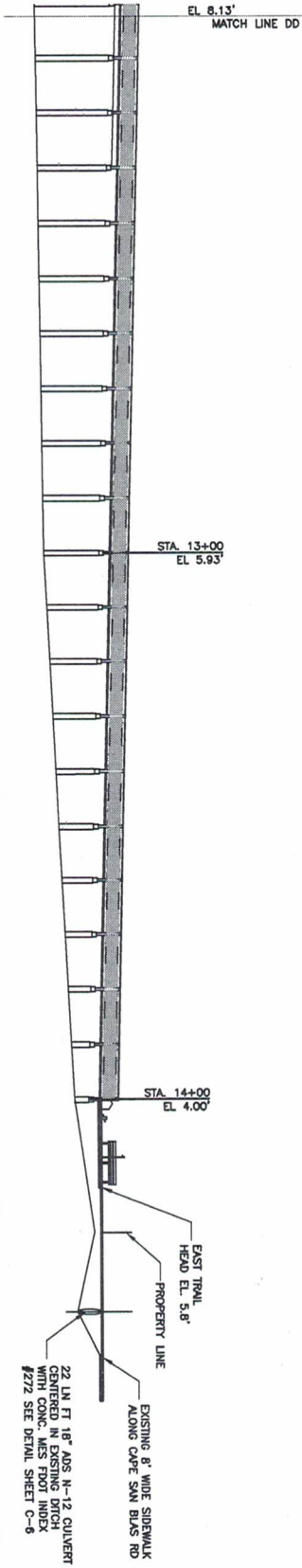

C-9

6' WIDE BOARDWALK PROFILE

DRAWN BY: LMF	DATE: 11/12/18	REVISION DATE:	REVISION:
REVIEWED BY: MP	DATE: 11/14/18	REVISION DATE:	REVISION:

SALINAS PARK GULF COUNTY
280 CAPE SAN BLAS RD
CAPE SAN BLAS, FL

PARKER
CONSULTING SERVICES, INC.
CIVIL ENGINEERS
3849 BULLMAN CENTER CT
TALLAHASSEE, FL 32308 PHONE: (904) 878-8100
MATTHEW PARKER P.E. STATE LICENSE # 10000



6' WIDE BOARDWALK PROFILE
SCALE: 1/32" = 1'-0"

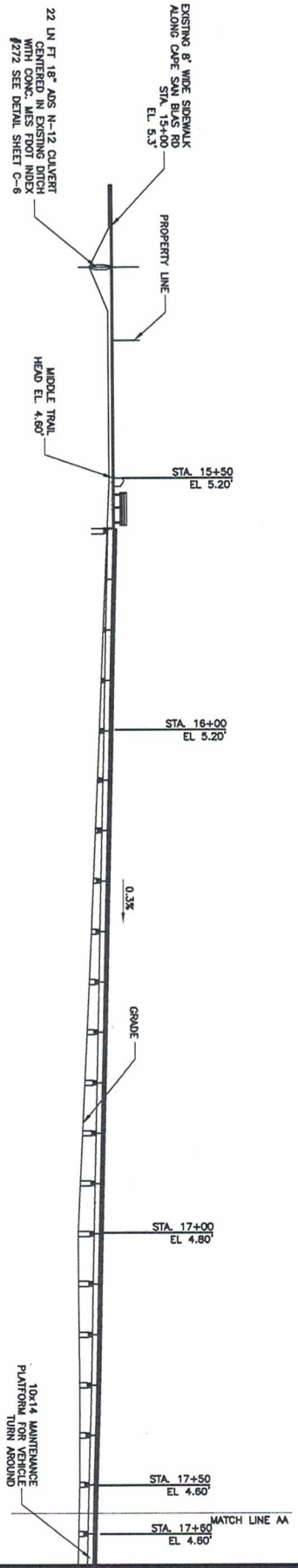
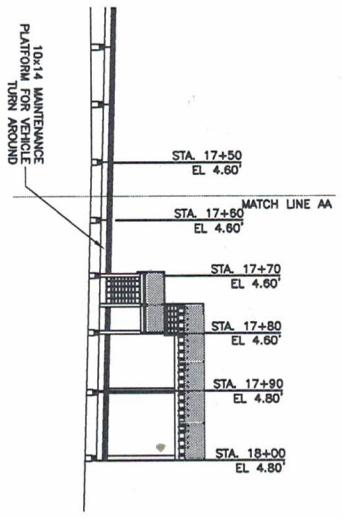

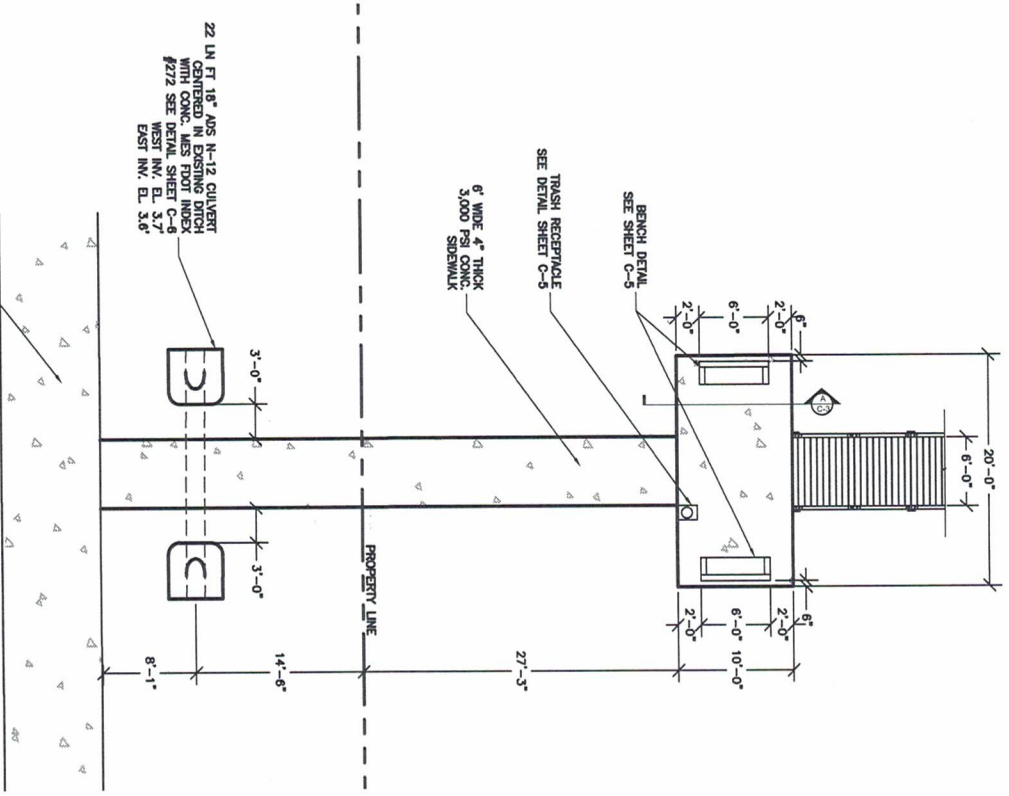

10'x20' MIDDLE TRAIL HEAD
1/16"=1'-0"

EXISTING 6" WIDE PUBLIC
ACCESS SIDEWALK ALONG
COUNTY RD #6-30E

22 LN FT 18" AUS N-12 CULVERT
CENTRED IN ROAD AND
VERTICALLY ALIGNED WITH
#272 SEE DETAIL SHEET C-6
WEST INV. EL. 3.7'
EAST INV. EL. 3.6'

6' WIDE 4" THICK
3,000 PSI CONC.
SIDEWALK

TRASH RECEPTACLE
SEE DETAIL SHEET C-5

BENCH DETAIL
SEE SHEET C-5

DRAWN BY: LMF	DATE: 11/12/18	REVISION DATE:	REVISION:
REVIEWED BY: MP	DATE: 11/14/18	REVISION DATE:	REVISION:

SALINAS PARK GULF COUNTY
280 CAPE SAN BLAS RD
CAPE SAN BLAS, FL

PARKER
CONSULTING SERVICES, INC.
CIVIL ENGINEERS
3840 B KILLENBANK DRIVE
TALAHASSEE, FL 32308 PHONE: (904) 878-8000
MATTHEW PARKER, P.E. # 9003

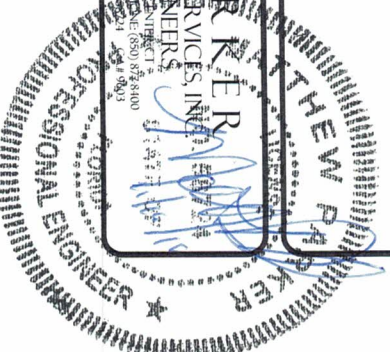

C-11

MIDDLE
TRAIL
HEAD

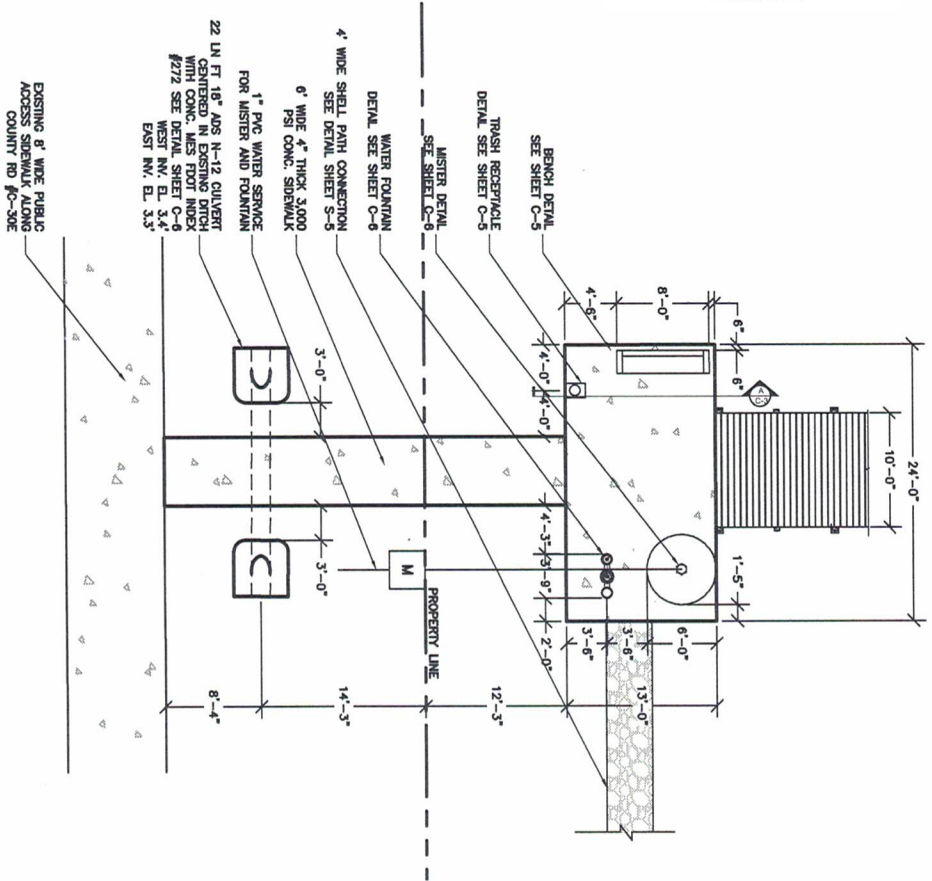

13'x24' EAST TRAIL HEAD
1/16"=1'-0"

DRAWN BY: LMF	DATE: 11/12/18	REVISION DATE:	REVISION:
REVIEWED BY: MP	DATE: 11/14/18	REVISION DATE:	REVISION:

SALINAS PARK GULF COUNTY
280 CAPE SAN BLAS RD
CAPE SAN BLAS, FL

PARKER
CONSULTING SERVICES INC.
CIVIL ENGINEERS
3809 KILLIAN CENTER CT
TALLAHASSEE, FL 32308 PHONE: 904.997.8100
MATTHEW PARKER, P.E. 5072 CAPEWAY RD
TALLAHASSEE, FL 32309



C-12

EAST TRAIL HEAD

DESIGN CRITERIA
 LANS / AREA NDS-2001 ASD MANUAL FOR ENGINEERING WOOD CONSTRUCTION
 -ASCE 7-10 "MINIMUM DESIGN LOADS FOR BUILDINGS AND OTHER STRUCTURES" PUBLISHED BY THE AMERICAN SOCIETY OF CIVIL ENGINEERS
 -FLORIDA BUILDING CODE 2017 EDITION
 -ASHTO / AMERICAN ASSOCIATION OF STATE HIGHWAY AND TRANSPORTATION OFFICIALS

DESIGN LOADS
 BUILDING LOADS PER ASHTO GUIDE SPECIFICATIONS FOR PEDESTRIAN BRIDGES
 DECK: LIVE LOAD - 100 PSF PEDESTRIAN LOAD
 DEAD LOAD - 7.5 PSF

WIND LOAD CRITERIA
 WIND LOAD PER SECTION 6.5.10 ASCE 7-10 "MINIMUM DESIGN LOADS FOR BUILDINGS AND OTHER STRUCTURES"
 BUILDING CATEGORY - I
 EXPOSURE CATEGORY - C
 BUILDING TYPE - OPEN
 VELOCITY PRESSURE EXPOSURE COEFFICIENT (Kz) - 0.85
 TOPOGRAPHIC FACTOR (Kzt) - 1.0
 DIRECTIONALITY FACTOR (Kd) - 0.85
 BASIC WIND SPEED (V) - 130 MPH
 IMPORTANCE FACTOR (I) - 0.77
 VELOCITY PRESSURE (qp) = 18.17 PSF

- GENERAL NOTES**
1. ALL TIMBER PILES TO BE #2 OR BETTER SOUTHERN YELLOW PINE (SYP) PRESSURE TREATED WITH 19% MC BEFORE INSTALLMENT. ALL FRAMING LUMBER TO BE #2 OR BETTER SYP PRESSURE TREATED WITH 19% MC BEFORE TREATMENT. ALL DECK BOARDS AND HANDRAIL CAPS TO BE WEAR DECK COMPOSITE LUMBER. ALL OVERLAY, SUPPORTS, CURBS AND POSTS TO BE #1 SYP PT WITH 19% MC BEFORE TREATMENT.
 2. ALL DECK, HANDRAIL FASTENERS, HANDRAIL BOLTS, NUTS, WASHERS, CLIPS, STRAPS, NAILS AND DECK SCREWS TO BE 316 STAINLESS STEEL.
 3. ALL WORK TO BE COMPLETED IN ACCORDANCE WITH THE AFPA (AMERICAN FOREST PRODUCTS ASSOCIATION) AND THE 2017 FLORIDA BUILDING CODE AND 2009 ASHTO GUIDE SPECIFICATIONS FOR PEDESTRIAN BRIDGES.
 4. ALL PILING SHALL MEET THE REQUIREMENTS AS SET FORTH BY THE AMERICAN SOCIETY FOR TESTING AND MATERIALS (ASTM) UNDER THE PROVISIONS OF D25 (LATEST EDITION). STANDARD SPECIFICATIONS FOR ROUND TIMBER PILES. TOLERANCE IN DIAMETER OF PILING SHALL BE 1" TAPER IN 10 LINEAR FEET.
 5. ALL PILES ARE TO BE DRIVEN TO REFUSAL AND MUST ACHIEVE A MINIMUM DEPTH OF 10'. PILE REPLACEMENT ALLOWABLE VARIATION ±.3" SIDE TO SIDE IN SECTION AND ±1" ON PILE CENTER TO CENTER SPACING ALONG LENGTH.
 6. THE PILE DRIVING SPECIFICATIONS FOR DEFINING REFUSAL ARE AS FOLLOWS: TO ACHIEVE A MINIMUM 10' SOIL PENETRATION USING A BOBCAT 442 COMPACT EXCAVATOR (OR EQUIVALENT), IDLING AT 800 RPM'S, WITH ATTACHED C30 "NPK" HAMMER (OR EQUIVALENT) UTILIZING 3,500 LB-FT OF IMPULSE FORCE OPERATING AT A CYCLE RATE OF 2,400 PER MINUTE AND USING A FLOW OF 11-13 GALLONS OF HYDRAULIC FLUID PER MINUTE. IF THE PILING DOES NOT CONTINUE TO MOVE AFTER 1-MINUTE, THEN REFUSAL HAS BEEN MET.
 7. UPON ENCOUNTERING ROCK, DENSE SOIL, OR OTHER SIMILAR SOIL CONDITION THAT HINDERS PILING INSERTION, THE AUGURING METHOD MAY BE UTILIZED.
 8. WARDDECK COMPOSITE DECK BOARDS AND TOP CAP COLOR TO BE SADDLE.

Lumber Specifications

Dimension	Location	Species	Grade	Treatment
2" x 8"	Guardrail Cap	Advantage	Composite	ACC
2" x 6"	Decking	Advantage	Composite	ACC
2" x 6"	Top Rail	SYP	# 1	0.40 ACC
2" x 6"	Wire Cover	SYP	# 1	0.40 ACC
2" x 6"	Bottom Rail	SYP	# 1	0.40 ACC
4" x 6"	Guardrail Post	SYP	# 1	0.40 ACC
4" x 4"	Guardrail Post Blocking	SYP	# 1	0.40 ACC
3" x 12"	Stringer	SYP	# 2 & BTR	0.40 CCA
3" x 12"	Stringer Blocking	SYP	# 2 & BTR	0.40 CCA
8" x 8"	Pile Cap	SYP	# 2 & BTR	0.40 CCA
2" x 8"	Cross Bracing	SYP	# 2 & BTR	0.40 CCA
8"	Pile	SYP		0.80 CCA
6"	Pile Blocking	SYP		0.80 CCA

SYP (Southern Yellow Pine)
 ACC (Acetylated Wood)
 CCA (Copper Chromium Arsenate)



DRAWN BY: LMF	DATE: 11/12/18	REVISION DATE:	REVISION:
REVIEWED BY: MP	DATE: 11/14/18	REVISION DATE:	REVISION:

SALINAS PARK GULF COUNTY
 280 CAPE SAN BLAS RD
 CAPE SAN BLAS, FL

PARKER
 CONSULTING SERVICES, INC.
 CIVIL ENGINEERS
 1849 BULLIARD CENTER CT
 TAMPA, FL 33606
 MATTHEW PARKER, P.E. S17277
 PROFESSIONAL ENGINEER

S-1

NOTES

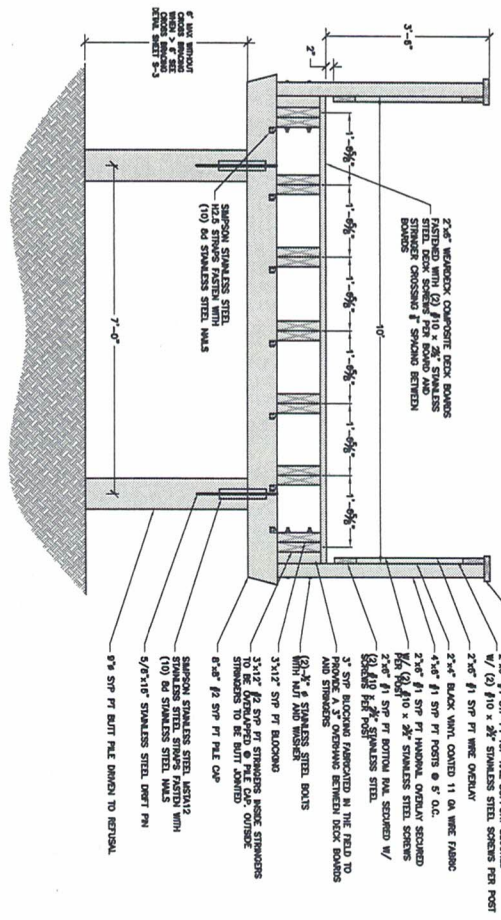

TYPICAL BOARDWALK SECTION
1/4"=1'-0"

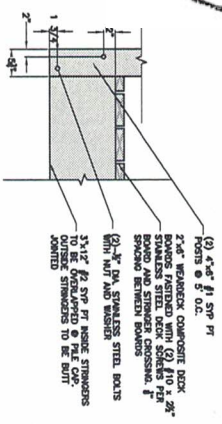

HANDRAIL DETAIL
1/4"=1'-0"

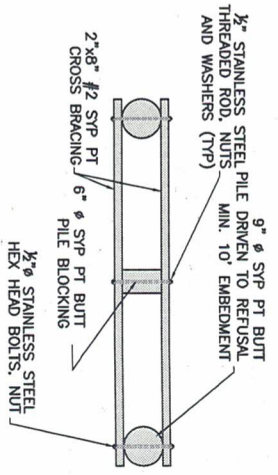

TYPICAL CROSS BRACING DETAIL
1/4"=1'-0"

S-2

BOARDWALK
DETAILS

DRAWN BY: LMF	DATE: 11/12/18	REVISION DATE:	REVISION:
REVIEWED BY: MP	DATE: 11/14/18	REVISION DATE:	REVISION:

SALINAS PARK GULF COUNTY
280 CAPE SAN BLAS RD
CAPE SAN BLAS, FL

PARKEER
CONSULTING SERVICES, INC.
CIVIL ENGINEERS
3819 B KIDDERMAN CENTER CT
TALLAHASSEE, FL 32308 PHONE: (904) 877-9000 FAX: (904) 877-9001
MATTHEW PARKER, P.E. C.A. 9603

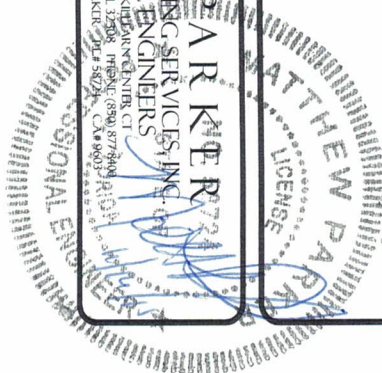

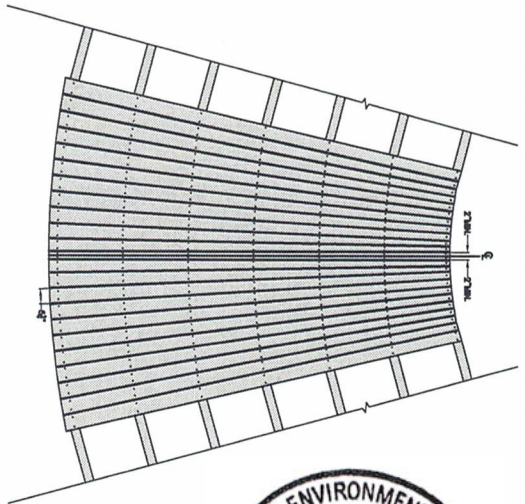

CURVE RADIUS DECK BOARD DETAIL
1/2"=1'-0"



0369442-001-ET-13

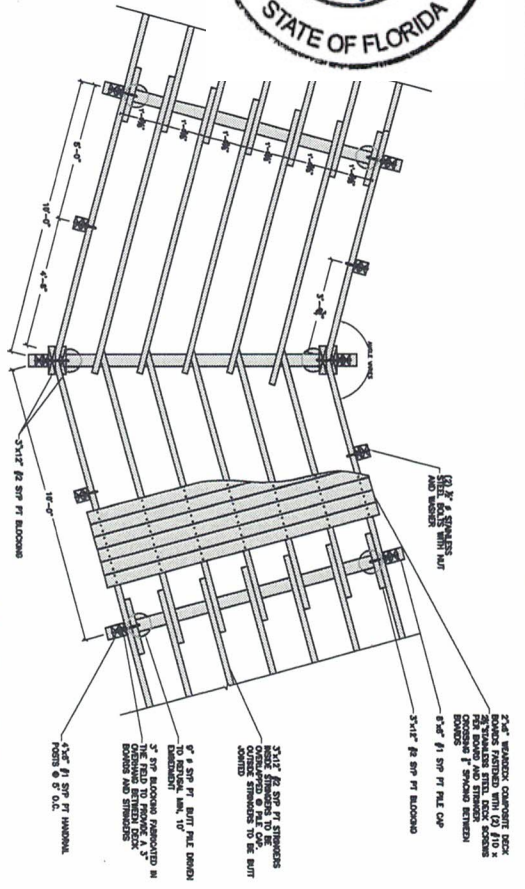

ANGLE BOARDWALK DETAIL
1/2"=1'-0"

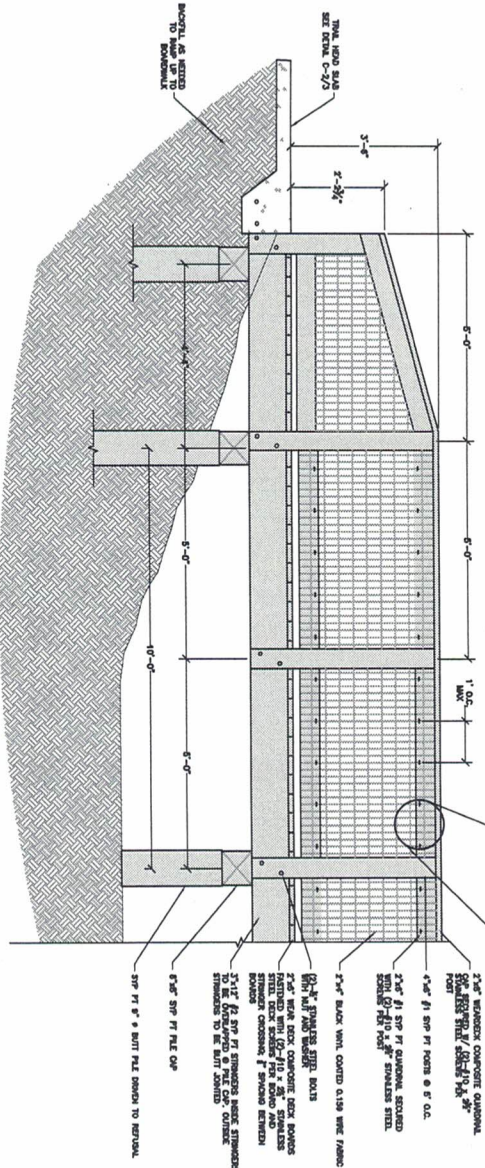

BOARDWALK ELEVATION
3/4"=1'-0"

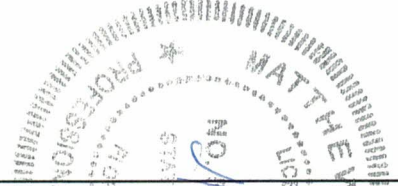

S-4 10' WIDE BOARDWALK DETAILS	DRAWN BY: LMF DATE: 8/20/17	REVISION DATE: REVISION:	DRAWN BY: LMF DATE: 8/20/17	REVISION DATE: REVISION:
	REVIEWED BY: MP DATE: 8/20/17	REVISION DATE: REVISION:	REVIEWED BY: MP DATE: 8/20/17	REVISION DATE: REVISION:

SALINAS PARK GULF COUNTY
 280 CAPE SAN BLAS RD
 CAPE SAN BLAS, FL

Nature Bridges
 200 S. W. 10th Street, Suite 100
 Fort Lauderdale, FL 33304
 www.naturebridges.com

PARKER CONSULTING SERVICES, INC. CIVIL ENGINEERS
 1511 HANSHALL ST. SUITE 1000, FORT LAUDERDALE, FL 33304
 MATTHEW J. PARKER, P.E. # 76743

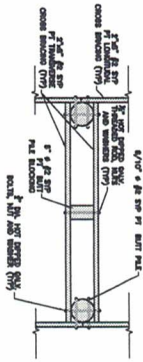

TOWER CROSS BRACING DETAIL 12'-19'

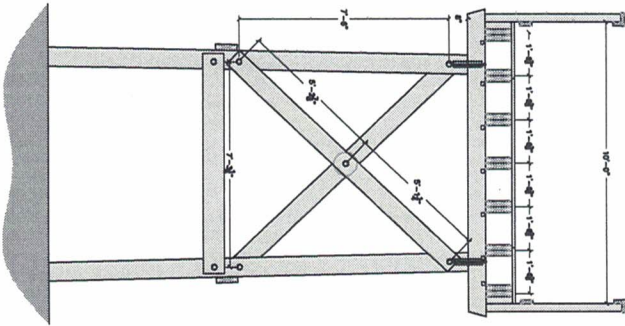

TOWER CROSS BRACING DETAIL 12'-19'

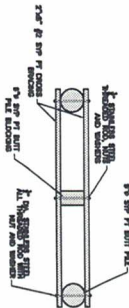

CROSS BRACING DETAIL 6'-11'

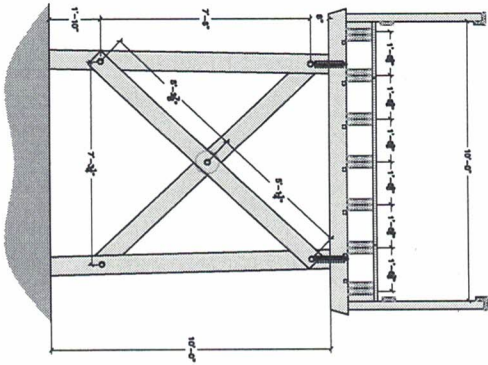

CROSS BRACING DETAIL 6'-11'

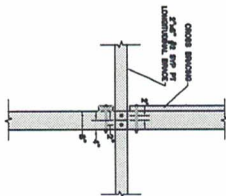

TOWER JOINT DETAIL FOR TOWER BRACING

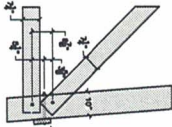

TYPICAL JOINT DETAIL FOR CROSS BRACING

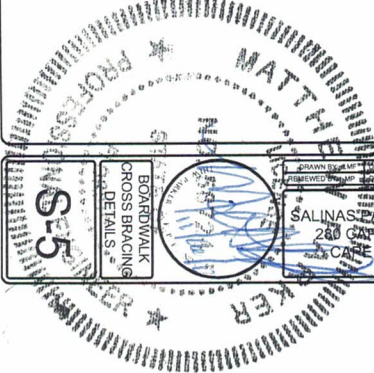

DRAWN BY: [Name] DATE: 06/01/17 REVISIONS: [List]	REVISION DATE: [Date] REVISION: [Description]	REVISION DATE: [Date] REVISION: [Description]	REVISION DATE: [Date] REVISION: [Description]
	REVISION DATE: [Date] REVISION: [Description]	REVISION DATE: [Date] REVISION: [Description]	REVISION DATE: [Date] REVISION: [Description]

BOARDWALK CROSS BRACING DETAILS
 SALINAS PARK GULF COUNTY
 260 CAPE SAN BLAS RD
 CAPE SAN BLAS, FL

WILKES ENVIRONMENTAL, LLC
 Nature Bridges
 PARKER CONSULTING SERVICES, INC. CIVIL ENGINEERS

DESIGN CRITERIA
 -ANSI / AF&PA NOS-2001 ASD MANUAL FOR ENGINEERING WOOD CONSTRUCTION
 -ASCE 7-10 "MINIMUM DESIGN LOADS FOR BUILDINGS AND OTHER STRUCTURES" PUBLISHED BY THE AMERICAN SOCIETY OF CIVIL ENGINEERS
 -FLORIDA BUILDING CODE 2017 EDITION
 -ASHOTO / AMERICAN ASSOCIATION OF STATE HIGHWAY AND TRANSPORTATION OFFICIALS

DESIGN LOADS
 BUILDING LOADS PER ASHTO GUIDE SPECIFICATIONS FOR PEDESTRIAN BRIDGES
 DECK: LIVE LOAD - 100 PSF PEDESTRIAN LOAD
 DEAD LOAD - 7.5 PSF

WIND LOAD CRITERIA
 WIND LOAD PER SECTION 6.5.10 ASCE 7-10 "MINIMUM DESIGN LOADS FOR BUILDINGS AND OTHER STRUCTURES"

BUILDING CATEGORY - I
 EXPOSURE CATEGORY - C
 BUILDING TYPE - OPEN
 VELOCITY PRESSURE EXPOSURE COEFFICIENT (Kz) - 0.85
 TOPOGRAPHIC FACTOR (Kzt) - 1.0
 DIRECTIONALITY FACTOR (Kd) - 0.85
 BASIC WIND SPEED (V) - 130 MPH
 IMPORTANCE FACTOR (I) - 0.77
 VELOCITY PRESSURE (qz) = 18.17 PSF

GENERAL NOTES

1. ALL TIMBER PILES TO BE #2 OR BETTER SOUTHERN YELLOW PINE (SYP) PRESSURE TREATED WITH 19% MC BEFORE TREATMENT. FRAMING LUMBER TO BE #2 OR BETTER SYP PRESSURE TREATED WITH 19% MC BEFORE TREATMENT. ALL DECKBOARDS AND GUARDRAIL CAPS TO BE WEAR DECK COMPOSITE LUMBER. ALL OVERLAY, SUPPORTS, CURBS AND POSTS TO BE #1 SYP PT WITH 19% MC BEFORE TREATMENT.
2. ALL DECK, HANDRAIL FASTENERS, HANDRAIL BOLTS, NUTS, WASHERS, CLIPS, STRAPS, NAILS AND DECK SCREWS TO BE 316 STAINLESS STEEL.
3. ALL WORK TO BE COMPLETED IN ACCORDANCE WITH THE AFPA (AMERICAN FOREST PRODUCTS ASSOCIATION) AND THE 2017 FLORIDA BUILDING CODE AND 2009 ASHTO GUIDE SPECIFICATIONS FOR PEDESTRIAN BRIDGES.
4. ALL PILING SHALL MEET THE REQUIREMENTS AS SET FORTH BY THE AMERICAN SOCIETY FOR TESTING AND MATERIALS (ASTM) UNDER THE PROVISIONS OF D29 (LATEST EDITION), STANDARD SPECIFICATIONS FOR ROUND TIMBER PILES. TOLERANCE IN DIAMETER OF PILING SHALL BE 1" TAPER IN 10 LINEAR FEET.
5. ALL PILES ARE TO BE DRIVEN TO REFUSAL AND MUST ACHIEVE A MINIMUM DEPTH OF 10' PILE REPLACEMENT ALLOWABLE VARIATION ±3" SIDE TO SIDE IN SECTION AND ±1" ON PILE CENTER TO CENTER SPACING ALONG LENGTH.
6. THE PILE DRIVING SPECIFICATIONS FOR DEFINING REFUSAL ARE AS FOLLOWS: TO ACHIEVE A MINIMUM 10' SOIL PENETRATION USING A BOBCAT 442 COMPACT EXCAVATOR (OR EQUIVALENT), IDLING AT 800 RPM'S, WITH ATTACHED C30 "HP" HAMMER (OR EQUIVALENT) UTILIZING 3,500 LB.-FT OF IMPLUSE FORCE OPERATING AT A CYCLE RATE OF 2,400 PER MINUTE AND USING A FLOW OF 11-13 GALLONS OF HYDRAULIC FLUID PER MINUTE. IF THE PILING DOES NOT CONTINUE TO MOVE AFTER 1-MINUTE, THEN REFUSAL HAS BEEN MET.
7. UPON ENCOUNTERING ROCK, DENSE SOIL, OR OTHER SIMILAR SOIL CONDITION THAT HINDERS PILING INSERTION, THE AUGURING METHOD MAY BE UTILIZED.



Lumber Specifications

Dimension Location	Species	Grade	Treatment
4" x 4"	SYP	#1	0.40 ACC
4" x 4"	SYP	#1	0.40 ACC
3" x 12"	SYP	# 2 & BTR	0.40 CCA
3" x 12"	SYP	# 2 & BTR	0.40 CCA
6" x 6"	SYP	# 2 & BTR	0.40 CCA
8"	Pile	SYP	0.80 CCA

SYP (Southern Yellow Pine)
 * Modified in the field to 3"

S-8

NOTES

DRAWN BY: LMF
 REVIEWED BY: MAP
 DATE: 11/12/18
 DATE: 11/14/18

REVISION DATE:
 REVISION DATE:

REVISION:
 REVISION:

SALINAS PARK GULF COUNTY
 280 CAPE SAN BLAS RD
 CAPE SAN BLAS, FL

PARKER
 CONSULTING SERVICES, INC.
 CIVIL ENGINEERS

3819 HILLCREST CENTER DR
 TALLAHASSEE, FL 32308
 MATTHEW PARKER, P.E. 58772

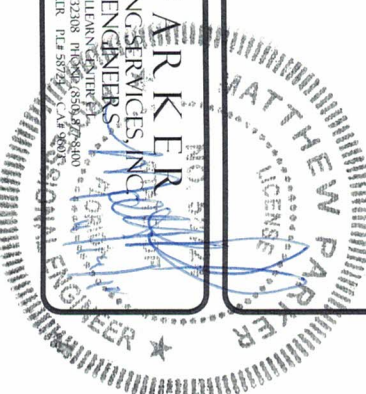

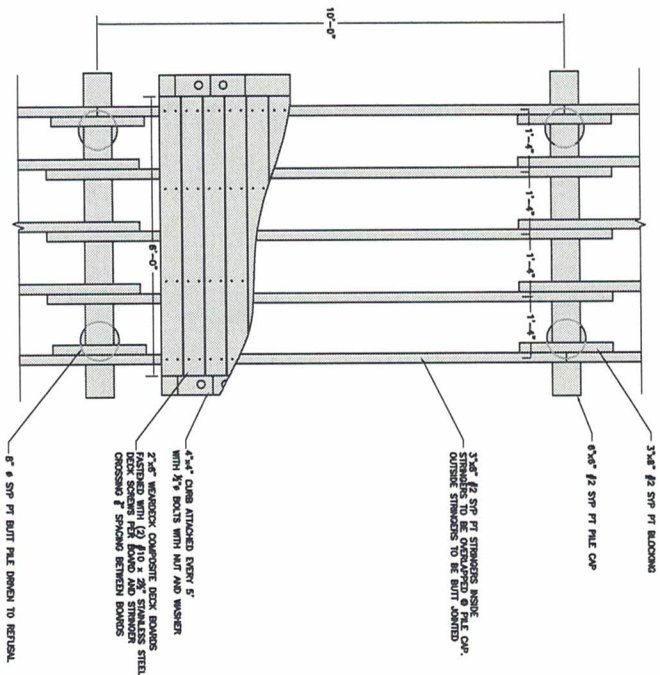

AT GRADE BOARDWALK PLAN VIEW

1/4"=1'-0"

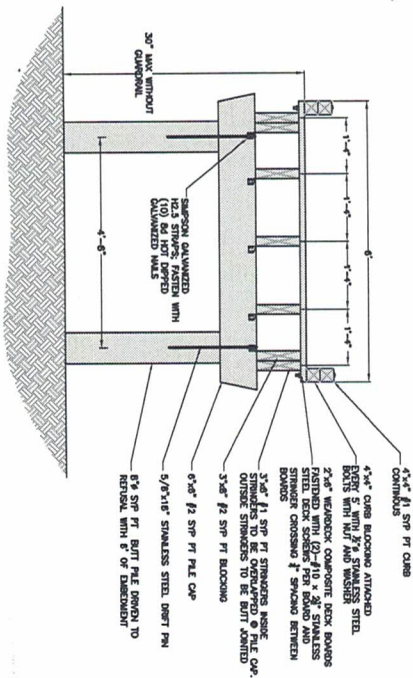

AT GRADE BOARDWALK SECTION

1/4"=1'-0"

S-9

6'
BOARDWALK
DETAILS

DRAWN BY: LMF DATE: 11/12/18
REVIEWED BY: MP DATE: 11/14/18

REVISION DATE:
REVISION DATE:

REVISION:
REVISION:

SALINAS PARK GULF COUNTY
280 CAPE SAN BLAS RD
CAPE SAN BLAS, FL

NO 5724
PARKER
CONSULTING ENGINEERS
CIVIL ENGINEERS
3819 BIRCHWOOD DR
TALLAHASSEE, FL 32310
MATTHEW PARKER
REGISTERED PROFESSIONAL ENGINEER
FLORIDA LICENSE NO. 12585

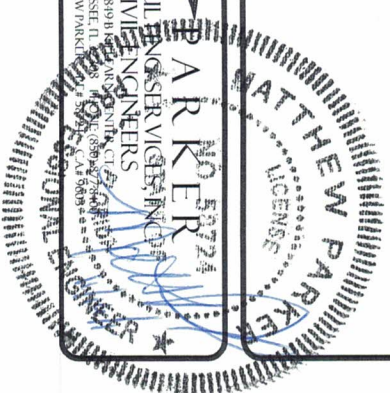



0359442-001-23

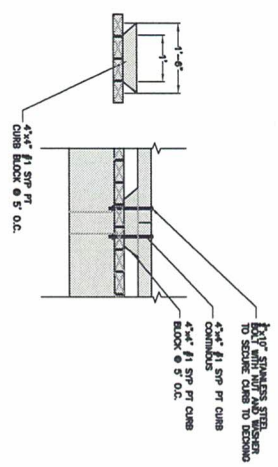

TYPICAL CURB DETAIL

3/4"=1'-0"

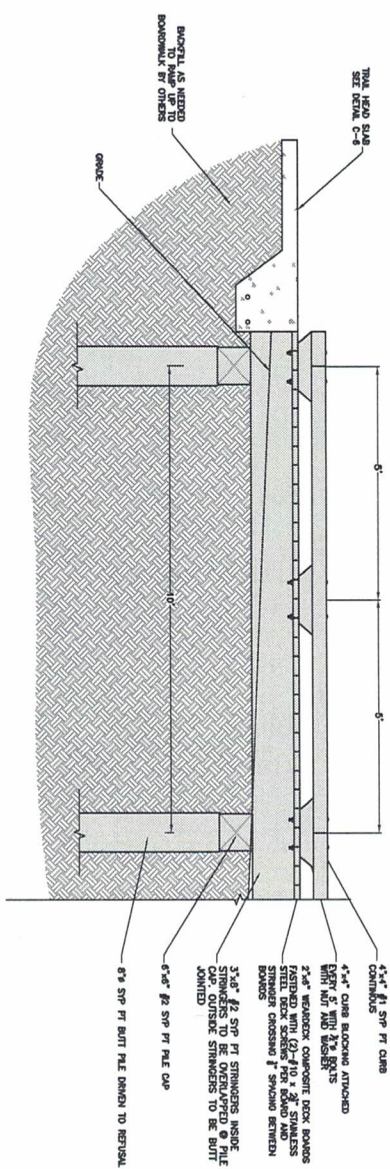

AT GRADE BOARDWALK ELEVATION

1/4"=1'-0"

DRAWN BY: LMF	DATE: 11/2/18	REVISION DATE:	REVISION:
REVIEWED BY: AMP	DATE: 11/14/18	REVISION DATE:	REVISION:

SALINAS PARK GULF COUNTY
280 CAPE SAN BLAS RD
CAPE SAN BLAS, FL

PARKER
CONSULTING ENGINEERS, INC.
CIVIL ENGINEERS
3819 HUNTER CENTER CT
TALLAHASSEE, FL 32308 PHONE: (850) 877-8440
MATTHEW PARKER
P.E. #9724, C.A.E. #903



S-10

BOARDWALK
DETAILS

6'

0369442-001-EX-23

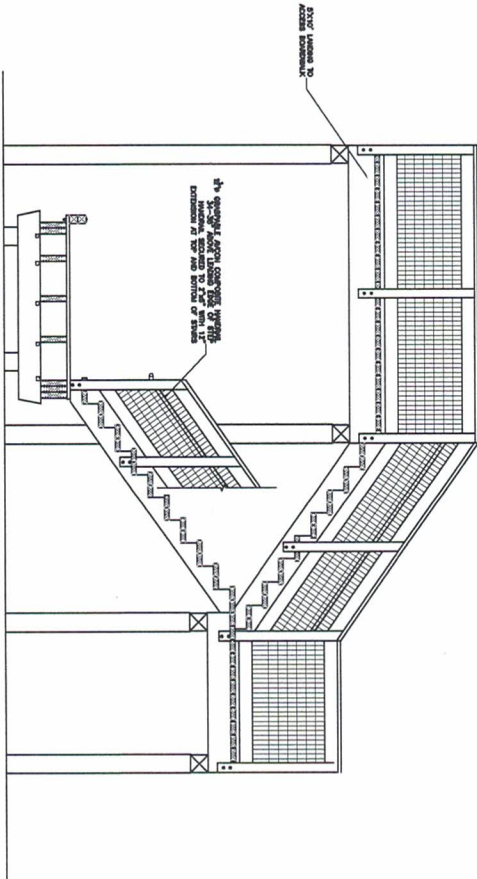

PEAK OBSERVATION ELEVATION

1/2"=1'-0"

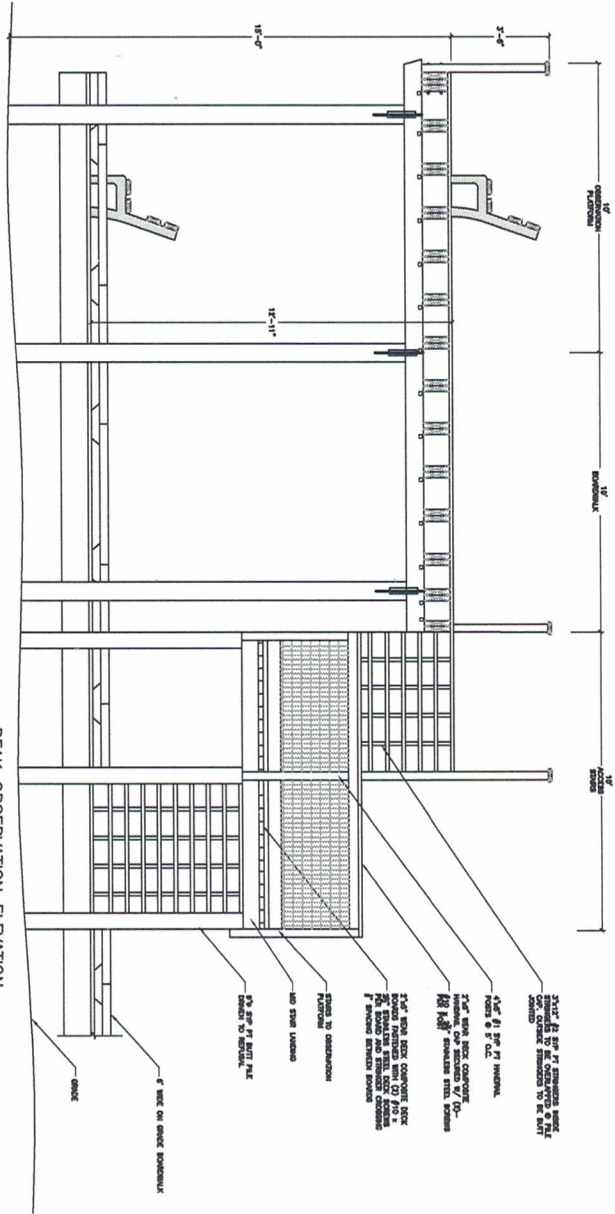

PEAK OBSERVATION ELEVATION

1/2"=1'-0"

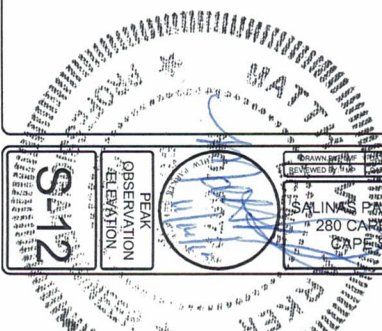

<p>S-12</p> <p>PEAK OBSERVATION ELEVATION</p>	<p>DRAWN BY: [Signature]</p> <p>REVIEWED BY: [Signature]</p>	<p>DATE: 05/14/17</p> <p>DATE: 09/25/18</p>	<p>REVISION DATE</p> <p>REVISION DATE</p>	<p>REVISION</p> <p>REVISION</p>	<p>REVISION DATE</p> <p>REVISION DATE</p>	<p>REVISION</p> <p>REVISION</p>	
	<p>SALINA PARK GULF COUNTY 280 CAPE SAN BLAS RD CAPE SAN BLAS, FL</p>				<p>Nature Bridges</p> <p>30 PARKWAY, SUITE 1000, BOCA RATON, FL 33433</p>		<p>PARKER CONSULTING SERVICES, INC.</p> <p>CIVIL ENGINEERS</p> <p>3000 W. PALM BEACH BLVD., SUITE 1000, BOCA RATON, FL 33433</p>