



REPLY TO
ATTENTION OF

DEPARTMENT OF THE ARMY
JACKSONVILLE DISTRICT CORPS OF ENGINEERS
41 N. JEFFERSON STREET, SUITE 301
PENSACOLA, FLORIDA 32502

December 10, 2019

Regulatory Division
North Permits Branch
Pensacola Permits Section
SAJ-2010-01719 (LP-EPS)

Walton County Board of County Commissioners
c/o Mr. Greg Graham
117 Montgomery Circle
DeFuniak Springs, FL 32435

Dear Mr. Graham:

This is in reference to your request for a Department of the Army (DA) permit to perform work in or affecting waters of the United States. If you determine the permit provided is acceptable in its entirety and you have chosen to proceed with the authorized activity, then upon recommendation of the Chief of Engineers, pursuant to Section 10 of the Rivers and Harbors Act of 1899 (33 U.S.C. 403), you are authorized under a Letter of Permission to construct an additional 500' by 15' marginal boardwalk and pier with four 10' x 10' turnaround structures on an existing boardwalk and pier structure on Lafayette Creek at Shipyard Road, Freeport, Lafayette Creek, in Section 22, Township 1 South, Range 19 West, Walton County, Florida.

Geographic Position: Latitude: 30.487661° North
Longitude: 86.135950° West

The project must be completed in accordance with the twelve enclosed construction drawings, and the general and special conditions which are incorporated in, and made a part of, the permit.

Special Conditions:

1. **Reporting Address:** The Permittee shall submit all reports, notifications, documentation and correspondence required by the general and special conditions of this permit to either (not both) of the following addresses:
 - a. For electronic mail (preferred): SAJ-RD-Enforcement@usace.army.mil (not to exceed 15 MB).
 - b. For standard mail: U.S. Army Corps of Engineers, Regulatory Division, Enforcement Section, P.O. Box 4970, Jacksonville, FL 32232-0019.

- c. The Permittee shall reference this permit number, SAJ-2010-01719 (LP-EPS), on all submittals.
2. **Commencement Notification:** Within 10 days from the date of initiating the work authorized by this permit the Permittee shall complete and submit the attached "Commencement Notification" Form.
 3. **Self-Certification:** Within 60 days of completion of the work authorized by this permit, the Permittee shall complete the attached "Self-Certification Statement of Compliance" form and submit it to the Corps. In the event that the completed work deviates in any manner from the authorized work, the Permittee shall describe the deviations between the work authorized by this permit and the work as constructed on the "Self-Certification Statement of Compliance" form. The description of any deviations on the "Self-Certification Statement of Compliance" form does not constitute approval of any deviations by the Corps.
 4. **Cultural Resources/Historic Properties:**
 - a. No structure or work shall adversely affect impact or disturb properties listed in the *National Register of Historic Places* (NRHP) or those eligible for inclusion in the NRHP.
 - b. If during the ground disturbing activities and construction work within the permit area, there are archaeological/cultural materials encountered which were not the subject of a previous cultural resources assessment survey (and which shall include, but not be limited to: pottery, modified shell, flora, fauna, human remains, ceramics, stone tools or metal implements, dugout canoes, evidence of structures or any other physical remains that could be associated with Native American cultures or early colonial or American settlement), the Permittee shall immediately stop all work and ground-disturbing activities within a 100-meter diameter of the discovery and notify the Corps within the same business day (8 hours). The Corps shall then notify the Florida State Historic Preservation Officer (SHPO) and the appropriate Tribal Historic Preservation Officer(s) (THPO(s)) to assess the significance of the discovery and devise appropriate actions.
 - c. Additional cultural resources assessments may be required of the permit area in the case of unanticipated discoveries as referenced in accordance with the above Special Condition; and if deemed necessary by the SHPO, THPO(s), or Corps, in accordance with 36 CFR 800 or 33 CFR 325, Appendix C (5). Based, on the circumstances of the discovery, equity to all parties, and considerations of

the public interest, the Corps may modify, suspend or revoke the permit in accordance with 33 CFR Part 325.7. Such activity shall not resume on non-federal lands without written authorization from the SHPO for finds under his or her jurisdiction, and from the Corps.

- d. In the unlikely event that unmarked human remains are identified on non-federal lands, they will be treated in accordance with Section 872.05 Florida Statutes. All work and ground disturbing activities within a 100-meter diameter of the unmarked human remains shall immediately cease and the Permittee shall immediately notify the medical examiner, Corps, and State Archeologist within the same business day (8-hours). The Corps shall then notify the appropriate SHPO and THPO(s). Based, on the circumstances of the discovery, equity to all parties, and considerations of the public interest, the Corps may modify, suspend or revoke the permit in accordance with 33 CFR Part 325.7. Such activity shall not resume without written authorization from the State Archeologist and from the Corps.

5. Turbidity Barriers:

- a. Shall be used throughout construction to control erosion and siltation and ensure that turbidity levels within the project area do not exceed background conditions.
- b. Shall be made of material in which listed species cannot become entangled (i.e., reinforced impermeable polycarbonate vinyl fabric [PVC]), and shall be monitored to ensure listed species are not entangled or trapped in the project area.
- c. Shall be removed promptly when the work is complete and the water quality in the project area has returned to background conditions.
- d. Shall not block entry to or exit from designated critical habitat.

6. Sea Turtle and Smalltooth Sawfish Conditions: The Permittee shall comply with the attached National Marine Fisheries Service's "Sea Turtle and Smalltooth Sawfish Construction Conditions" dated March 23, 2006.

7. Manatee Conditions: The Permittee shall comply with the attached "Standard Manatee Conditions for In-Water Work – 2011".

8. Regulatory Agency Changes: Should any other regulatory agency require changes to the work authorized or obligated by this permit, the Permittee is advised that a modification to this permit instrument is required prior to initiation of those changes. It is

the Permittee's responsibility to request a modification of this permit from the Pensacola Regulatory Office.

9. Material and Equipment Storage: No building or fill materials, tools or other equipment shall be stockpiled within waters of the United States.

10. All contractors involved in this permitted activity shall be provided copies of this permit in its entirety. A copy shall remain on site at all times during construction.

11. At least 60 days prior to beginning the authorized work in Lafayette Creek, the Permittee shall notify the U.S. Coast Guard by phone at 251-441-5684 or 251-441-5940 that work will begin in the creek. The Permittee shall provide the Coast Guard with dates of commencement of project activities and when the project is scheduled to end. Please note U.S. Coast Guard regulations may also require you as Permittee to provide information for a Notice to the maritime community regarding your project. You should contact the Coast Guard Sector Mobile Waterways Management Branch (spw), 1500 15th Street, Mobile, AL 36615 or by phone at 251-441-5684 or 251-441-5940 to determine if a Notice is necessary. Also any safety lights, signs and signals prescribed by the U.S. Coast Guard through their regulations or otherwise, must be installed and maintained at your expense as Permittee on authorized facilities in navigable waters of the United States. To receive a U.S. Coast Guard Private Aids to Navigation marking determination, you are advised to contact the Eighth Coast Guard District (dpw), 500 Poydras St. Suite 1230, New Orleans, LA 70130, 504-671-2328 or via email to: D8oanPATON@uscg.mil prior to installation/construction of any fixed structures. For general information related to Private Aids to Navigation please visit the Eighth CG District web site at: <http://www.uscg.mil/d8/waterways/PATON.Home.asp>

12. "Top-down" construction shall be used to avoid wetland impacts outside of the structure footprint shown the attached permit drawings.

13. Assurance of Navigation and Maintenance: The Permittee understands and agrees that, if future operations by the United States require the removal, relocation, or other alteration, of the structures or work herein authorized, or if in the opinion of the Secretary of the Army or his authorized representative, said structure or work shall cause unreasonable obstruction to the free navigation of the navigable waters, the Permittee will be required, upon due notice from the Corps of Engineers, to remove, relocate, or alter the structural work or obstructions caused thereby, without expense to the United States. No claim shall be made against the United States on account of any such removal or alteration.

14. Project Design Criteria (PDCs) for In-Water Activities: The Permittee shall comply with National Marine Fisheries Service's "PDCs for In-Water Activities" dated November 20, 2017 provided as an attachment to this permit.

15. Activity Specific PDCs: The Permittee shall comply with the NMFS JAXBO PDCs for Activity 2 dated November 20, 2017, provided as an attachment to this permit.

16. Daylight Hours: All activities must be completed during daylight hours.

If the work authorized is not completed on or before **December 10, 2024**, authorization, if not previously revoked or specifically extended, shall cease and be null and void.

Instructions for Objecting to Permit Terms and Conditions: This letter contains an initial proffered permit for your proposed project/permit application. If you object to certain terms and conditions contained within the permit, you may request that the permit be modified. Enclosed you will find a Notification of Administrative Appeal Options and Process fact sheet and Request for Appeal (RFA) form. If you choose to object to certain terms and conditions of the permit, you must follow the directions provided in Section 1, Part A and submit the completed RFA form to the letterhead address.

In order for an RFA to be accepted by the Corps, the Corps must determine that it is complete, that it meets the criteria under 33 CFR Part 331.5, and that it has been received by the District office within 60 days of the date of the RFA. Should you decide to submit an RFA form, it must be received at the letterhead address by February 7, 2020.

Should you have any questions regarding this letter, please contact the project manager, Ed Sarfert, in writing the letterhead address, by telephone at 850-439-9533, or by email at edward.p.sarfert@usace.army.mil.

The Corps Jacksonville District Regulatory Division is committed to improving service to our customers. We strive to perform our duty in a friendly and timely manner while working to preserve our environment. We invite you to take a few minutes to visit http://corpsmapu.usace.army.mil/cm_apex/f?p=regulatory_survey and complete our automated Customer Service Survey. Your input is appreciated – favorable or otherwise.

BY AUTHORITY OF THE SECRETARY OF THE ARMY:



for Andrew D. Kelly, Jr.
Colonel, U.S. Army
District Commander

Enclosures

Copy Furnished:

CESAJ-RD-PE (w/ enclosures)

REQUEST PERMIT TRANSFER: PERMIT NUMBER: SAJ-2010-01719(LP-EPS)

When the structures or work verified by this permit are still in existence at the time the property is transferred, the terms and conditions of this permit will continue to be binding on the new owner(s) of the property. To validate the transfer of this permit and the associated liabilities associated with compliance with its terms and conditions, the present permittee and the transferee should sign and date below. This document must then be provided to the U.S. Army Corps of Engineers, Regulatory Division, Post Office Box 4970, Jacksonville, Florida 32232-0019.

(TRANSFEREE SIGNATURE) (DATE)

(Name - Printed) Lot/Block of site

(Street Address)

(City, State, and Zip Code)

Flood Plain Information:

This Department of the Army permit does not give absolute authority to perform the work as specified on your application. The proposed work may be subject to local building restrictions. You should contact the local office in your area that issues building permits to determine if your site is located in a flood-prone or floodway area, and if you must comply with the local building requirements mandated by the National Flood Insurance Program. If your local office cannot provide you the necessary information, you may request a flood hazard evaluation of the site by providing this office with a letter and a small scale map showing the location of the site. The request should be addressed to the **Chief, Flood Control and Floodplain Management Branch, Jacksonville District, U.S. Army Corps of Engineers, P.O. Box 4970, Jacksonville, Florida 32232-0019**. Phone inquiries may be made at 904-232-2515.

GENERAL CONDITIONS
33 CFR PART 320-330
PUBLISHED FR DATED 13 NOVEMBER 1986

1. The time limit for completing the work authorized ends on **the date noted in the permit letter**. If you find that you need more time to complete the authorized activity, submit your request for a time extension to this office for consideration at least one month before the above date is reached.
2. You must maintain the activity authorized by this permit in good condition and in conformance with the terms and conditions of this permit. You are not relieved of this requirement if you abandon the permitted activity, although you may make a good faith transfer to a third party in compliance with General Condition 4 below. Should you wish to cease to maintain the authorized activity or should you desire to abandon it without a good faith transfer, you must obtain a modification of this permit from this office, which may require restoration of the area.
3. If you discover any previously unknown historic or archeological remains while accomplishing the activity authorized by this permit, you must immediately notify this office of what you have found. We will initiate the Federal and state coordination required to determine if the remains warrant a recovery effort or if the site is eligible for listing in the National Register of Historic Places.
4. If you sell the property associated with this permit you must obtain the signature of the new owner in the space provided and forward a copy of the permit to this office to validate the transfer of this authorization.
5. If a conditioned water quality certification has been issued for your project, you must comply with the conditions specified in the certification as special conditions to this permit. For your convenience, a copy of the certification is attached if it contains such conditions.
6. You must allow a representative from this office to inspect the authorized activity at any time deemed necessary to ensure that it is being or has been accomplished in accordance with the terms and conditions of your permit.

NOTIFICATION OF ADMINISTRATIVE APPEAL OPTIONS AND PROCESS AND REQUEST FOR APPEAL

Applicant: Walton County Board of County Commissioners		File Number: SAJ-2010-01719	Date: December 10, 2019
Attached is:			See Section below
X	INITIAL PROFFERED PERMIT (Standard Permit or Letter of permission)		A
	PROFFERED PERMIT (Standard Permit or Letter of permission)		B
	PERMIT DENIAL		C
	APPROVED JURISDICTIONAL DETERMINATION		D
	PRELIMINARY JURISDICTIONAL DETERMINATION		E

SECTION I - The following identifies your rights and options regarding an administrative appeal of the above decision. Additional information may be found at http://www.usace.army.mil/CECW/Pages/reg_materials.aspx or Corps regulations at 33 CFR Part 331.

A: INITIAL PROFFERED PERMIT: You may accept or object to the permit.

- **ACCEPT:** If you received a Standard Permit, you may sign the permit document and return it to the district engineer for final authorization. If you received a Letter of Permission (LOP), you may accept the LOP and your work is authorized. Your signature on the Standard Permit or acceptance of the LOP means that you accept the permit in its entirety, and waive all rights to appeal the permit, including its terms and conditions, and approved jurisdictional determinations associated with the permit.
- **OBJECT:** If you object to the permit (Standard or LOP) because of certain terms and conditions therein, you may request that the permit be modified accordingly. You must complete Section II of this form and return the form to the district engineer. Your objections must be received by the district engineer within 60 days of the date of this notice, or you will forfeit your right to appeal the permit in the future. Upon receipt of your letter, the district engineer will evaluate your objections and may: (a) modify the permit to address all of your concerns, (b) modify the permit to address some of your objections, or (c) not modify the permit having determined that the permit should be issued as previously written. After evaluating your objections, the district engineer will send you a proffered permit for your reconsideration, as indicated in Section B below.

B: PROFFERED PERMIT: You may accept or appeal the permit

- **ACCEPT:** If you received a Standard Permit, you may sign the permit document and return it to the district engineer for final authorization. If you received a Letter of Permission (LOP), you may accept the LOP and your work is authorized. Your signature on the Standard Permit or acceptance of the LOP means that you accept the permit in its entirety, and waive all rights to appeal the permit, including its terms and conditions, and approved jurisdictional determinations associated with the permit.
- **APPEAL:** If you choose to decline the proffered permit (Standard or LOP) because of certain terms and conditions therein, you may appeal the declined permit under the Corps of Engineers Administrative Appeal Process by completing Section II of this form and sending the form to the division engineer. This form must be received by the division engineer within 60 days of the date of this notice.

C: PERMIT DENIAL: You may appeal the denial of a permit under the Corps of Engineers Administrative Appeal Process by completing Section II of this form and sending the form to the division engineer. This form must be received by the division engineer within 60 days of the date of this notice.

D: APPROVED JURISDICTIONAL DETERMINATION: You may accept or appeal the approved JD or provide new information.

- **ACCEPT:** You do not need to notify the Corps to accept an approved JD. Failure to notify the Corps within 60 days of the date of this notice, means that you accept the approved JD in its entirety, and waive all rights to appeal the approved JD.
- **APPEAL:** If you disagree with the approved JD, you may appeal the approved JD under the Corps of Engineers Administrative Appeal Process by completing Section II of this form and sending the form to the division engineer. This form must be received by the division engineer within 60 days of the date of this notice.

E: PRELIMINARY JURISDICTIONAL DETERMINATION: You do not need to respond to the Corps regarding the preliminary JD. The Preliminary JD is not appealable. If you wish, you may request an approved JD (which may be appealed), by contacting the Corps district for further instruction. Also you may provide new information for further consideration by the Corps to reevaluate the JD.

SECTION II - REQUEST FOR APPEAL or OBJECTIONS TO AN INITIAL PROFFERED PERMIT

REASONS FOR APPEAL OR OBJECTIONS: (Describe your reasons for appealing the decision or your objections to an initial proffered permit in clear concise statements. You may attach additional information to this form to clarify where your reasons or objections are addressed in the administrative record.)

ADDITIONAL INFORMATION: The appeal is limited to a review of the administrative record, the Corps memorandum for the record of the appeal conference or meeting, and any supplemental information that the review officer has determined is needed to clarify the administrative record. Neither the appellant nor the Corps may add new information or analyses to the record. However, you may provide additional information to clarify the location of information that is already in the administrative record.

POINT OF CONTACT FOR QUESTIONS OR INFORMATION:

If you have questions regarding this decision you may contact:

Project Manager as noted in letter

If you have questions regarding the appeal process you may contact:

Phillip A. Shannin
Administrative Appeals Review Officer
USACE – South Atlantic Division
60 Forsyth Street SW, Room 10M15
Atlanta, Georgia 30303-8801
(404) 562-5136

RIGHT OF ENTRY: Your signature below grants the right of entry to Corps of Engineers personnel, and any government consultants, to conduct investigations of the project site during the course of the appeal process. You will be provided a 15 day notice of any site investigation, and will have the opportunity to participate in all site investigations.

Signature of appellant or agent.

Date:

Telephone number:

STANDARD MANATEE CONDITIONS FOR IN-WATER WORK

2011

The permittee shall comply with the following conditions intended to protect manatees from direct project effects:

- a. All personnel associated with the project shall be instructed about the presence of manatees and manatee speed zones, and the need to avoid collisions with and injury to manatees. The permittee shall advise all construction personnel that there are civil and criminal penalties for harming, harassing, or killing manatees which are protected under the Marine Mammal Protection Act, the Endangered Species Act, and the Florida Manatee Sanctuary Act.
- b. All vessels associated with the construction project shall operate at "Idle Speed/No Wake" at all times while in the immediate area and while in water where the draft of the vessel provides less than a four-foot clearance from the bottom. All vessels will follow routes of deep water whenever possible.
- c. Siltation or turbidity barriers shall be made of material in which manatees cannot become entangled, shall be properly secured, and shall be regularly monitored to avoid manatee entanglement or entrapment. Barriers must not impede manatee movement.
- d. All on-site project personnel are responsible for observing water-related activities for the presence of manatee(s). All in-water operations, including vessels, must be shutdown if a manatee(s) comes within 50 feet of the operation. Activities will not resume until the manatee(s) has moved beyond the 50-foot radius of the project operation, or until 30 minutes elapses if the manatee(s) has not reappeared within 50 feet of the operation. Animals must not be herded away or harassed into leaving.
- e. Any collision with or injury to a manatee shall be reported immediately to the Florida Fish and Wildlife Conservation Commission (FWC) Hotline at 1-888-404-3922. Collision and/or injury should also be reported to the U.S. Fish and Wildlife Service in Jacksonville (1-904-731-3336) for north Florida or Vero Beach (1-772-562-3909) for south Florida, and to FWC at ImperiledSpecies@myFWC.com
- f. Temporary signs concerning manatees shall be posted prior to and during all in-water project activities. All signs are to be removed by the permittee upon completion of the project. Temporary signs that have already been approved for this use by the FWC must be used. One sign which reads *Caution: Boaters* must be posted. A second sign measuring at least 8 ½" by 11" explaining the requirements for "Idle Speed/No Wake" and the shut down of in-water operations must be posted in a location prominently visible to all personnel engaged in water-related activities. These signs can be viewed at MyFWC.com/manatee. Questions concerning these signs can be sent to the email address listed above.

CAUTION: MANATEE HABITAT

All project vessels

IDLE SPEED / NO WAKE

When a manatee is within 50 feet of work
all in-water activities must

SHUT DOWN

Report any collision with or injury to a manatee:

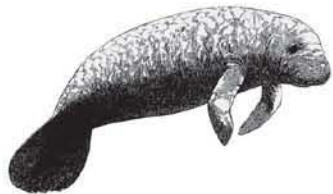

Wildlife Alert:

1-888-404-FWCC(3922)

cell *FWC or #FWC



UNITED STATES DEPARTMENT OF COMMERCE
National Oceanic and Atmospheric Administration
NATIONAL MARINE FISHERIES SERVICE
Southeast Regional Office
263 13th Avenue South
St. Petersburg, FL 33701

SEA TURTLE AND SMALLTOOTH SAWFISH CONSTRUCTION CONDITIONS

The permittee shall comply with the following protected species construction conditions:

- a. The permittee shall instruct all personnel associated with the project of the potential presence of these species and the need to avoid collisions with sea turtles and smalltooth sawfish. All construction personnel are responsible for observing water-related activities for the presence of these species.
- b. The permittee shall advise all construction personnel that there are civil and criminal penalties for harming, harassing, or killing sea turtles or smalltooth sawfish, which are protected under the Endangered Species Act of 1973.
- c. Siltation barriers shall be made of material in which a sea turtle or smalltooth sawfish cannot become entangled, be properly secured, and be regularly monitored to avoid protected species entrapment. Barriers may not block sea turtle or smalltooth sawfish entry to or exit from designated critical habitat without prior agreement from the National Marine Fisheries Service's Protected Resources Division, St. Petersburg, Florida.
- d. All vessels associated with the construction project shall operate at "no wake/idle" speeds at all times while in the construction area and while in water depths where the draft of the vessel provides less than a four-foot clearance from the bottom. All vessels will preferentially follow deep-water routes (e.g., marked channels) whenever possible.
- e. If a sea turtle or smalltooth sawfish is seen within 100 yards of the active daily construction/dredging operation or vessel movement, all appropriate precautions shall be implemented to ensure its protection. These precautions shall include cessation of operation of any moving equipment closer than 50 feet of a sea turtle or smalltooth sawfish. Operation of any mechanical construction equipment shall cease immediately if a sea turtle or smalltooth sawfish is seen within a 50-ft radius of the equipment. Activities may not resume until the protected species has departed the project area of its own volition.
- f. Any collision with and/or injury to a sea turtle or smalltooth sawfish shall be reported immediately to the National Marine Fisheries Service's Protected Resources Division (727-824-5312) and the local authorized sea turtle stranding/rescue organization.
- g. Any special construction conditions, required of your specific project, outside these general conditions, if applicable, will be addressed in the primary consultation.

Revised: March 23, 2006

O:\forms\Sea Turtle and Smalltooth Sawfish Construction Conditions.doc



Project Design Criteria (PDCs) for In-Water Activities

AP.7. Education and Observation: The permittee must ensure that all personnel associated with the project are instructed about the potential presence of species protected under the ESA and the Marine Mammal Protection Act (MMPA). All on-site project personnel are responsible for observing water-related activities for the presence of protected species. All personnel shall be advised that there are civil and criminal penalties for harming, harassing, or killing ESA-listed species or marine mammals. To determine which species may be found in the project area, please review the relevant Protected Species List at:

http://sero.nmfs.noaa.gov/protected_resources/section_7/threatened_endangered/index.html

AP.8. Reporting Interactions with Protected Species:

- a) Any collision(s) with and/or injury to any sea turtle, sawfish, whale, or sturgeon occurring during the construction of a project, shall be reported immediately to NMFS's Protected Resources Division (PRD) at (1-727-824-5312) or by email to: takereport.nmfs@noaa.gov and SAJ-RD-Enforcement@usace.army.mil.
- b) Smalltooth sawfish: Report sightings to 1-844-SAWFISH or email: Sawfish@MyFWC.com
- c) Sturgeon: Report dead sturgeon to 1-844-STURG 91 (1-844-788-7491) or email: nmfs.ser.sturgeonnetwork@noaa.gov
- d) Sea turtles and marine mammals: Report stranded, injured, or dead animals to 1-877-WHALE HELP (1-877-942-5343).
- e) North Atlantic right whale: Report injured, dead, or entangled right whales to the USCG via VHF Channel 16.

AP.9. Vessel Traffic and Construction Equipment: All vessel operators must watch for and avoid collision with species protected under the ESA and MMPA. Vessel operators must avoid potential interactions with protected species and operate in accordance with the following protective measures:

- a) *Construction Equipment*.
 - i) All vessels associated with the construction project shall operate at "Idle Speed/No Wake" at all times while operating in water depths where the draft of the vessel provides less than a 4-foot (ft) clearance from the bottom, and in all depths after a protected species has been observed in and has departed the area.
 - ii) All vessels will follow marked channels and/or routes using the maximum water depth whenever possible.
 - iii) Operation of any mechanical construction equipment, including vessels, shall cease immediately if a listed species is observed within a 50-ft radius of construction equipment and shall not resume until the species has departed the area of its own volition.
 - iv) If the detection of species is not possible during certain weather conditions (e.g., fog, rain, wind), then in-water operations will cease until weather conditions improve and detection is again feasible.

- b) *All Vessels:*
 - i) Sea turtles: Maintain a minimum distance of 150 ft.
 - ii) North Atlantic right whale: Maintain a minimum 1,500-ft distance (500 yards).
 - iii) Vessels 65 ft in length or longer must comply with the Right Whale Ship Strike Reduction Rule (50 CFR 224.105) which includes reducing speeds to 10 knots or less in Seasonal Management Areas (<http://www.fisheries.noaa.gov/pr/shipstrike/>).
 - iv) Mariners shall check various communication media for general information regarding avoiding ship strikes and specific information regarding right whale sightings in the area. These include NOAA weather radio, USCG NAVTEX broadcasts, and Notices to Mariners.
 - v) Marine mammals (i.e., dolphins, whales [other than North Atlantic right whales], and porpoises): Maintain a minimum distance of 300 ft.
 - vi) When these animals are sighted while the vessel is underway (e.g., bow-riding), attempt to remain parallel to the animal's course. Avoid excessive speed or abrupt changes in direction until they have left the area.
 - vii) Reduce speed to 10 knots or less when mother/calf pairs or groups of marine mammals are observed, when safety permits.

- AP.10. Turbidity Control Measures during Construction:** Turbidity must be monitored and controlled. Prior to initiating any of the work covered under this Opinion, the Permittee shall install turbidity curtains as described below. In some instances, the use of turbidity curtains may be waived by the USACE project manager if the project is deemed too minimal to generate turbidity (e.g., certain ATON installation, scientific survey device placement, marine debris removal) or if the current is too strong for the curtains to stay in place. Turbidity curtains specifications:
- a) Install floating turbidity barriers with weighted skirts that extend to within 1 ft of the bottom around all work areas that are in, or adjacent to, surface waters.
 - b) Use these turbidity barriers throughout construction to control erosion and siltation and ensure that turbidity levels within the project area do not exceed background conditions.
 - c) Position turbidity barriers in a way that does not block species' entry to or exit from designated critical habitat.
 - d) Monitor and maintain turbidity barriers in place until the authorized work has been completed and the water quality in the project area has returned to background conditions.
 - e) In the range of ESA-listed corals (St. Lucie Inlet, Martin County south to the Dry Tortugas and the U.S. Caribbean) and Johnson's seagrass (Turkey Creek/Palm Bay south to central Biscayne Bay in the lagoon systems on the east coast of Florida):
 - i. Projects that include upland earth moving (e.g., grading to install a building or parking lot associated with a dock and seawall project), must install sediment control barriers to prevent any upland sediments from reaching estuarine or marine waters.
 - ii. The turbidity curtain requirement cannot be waived for any project that moves or removes sediment (e.g., dredging, auger to create a pile, trenching to install a cable

line). If turbidity curtains are not feasible in an area based on site conditions such as water current, high wave action, or stormy conditions, the project must undergo individual Section 7 consultation and is not covered under this Programmatic Opinion.

AP.11. Entanglement: All turbidity curtains and other in-water equipment must be properly secured with materials that reduce the risk of entanglement of marine species (described below). Turbidity curtains likewise must be made of materials that reduce the risk of entanglement of marine species.

- a) In-water lines (rope, chain, and cable, including the lines to secure turbidity curtains) must be stiff, taut, and non-looping. Examples of such lines are heavy metal chains or heavy cables that do not readily loop and tangle. Flexible in-water lines, such as nylon rope or any lines that could loop or tangle, must be enclosed in a plastic or rubber sleeve/tube to add rigidity and prevent the line from looping and tangling. In all instances, no excess line is allowed in the water.
- b) Turbidity curtains and other in-water equipment must be placed in a manner that does not entrap species within the construction area or block access for them to navigate around the construction area.

Project Design Criteria (PDCs) Specific to Activity 2 for Pile-Supported Structures and Anchored Buoys

A2.1. Activities covered by this Opinion include the installation, repair, replacement, and removal of structures as described below:

- A2.1.1. The pile-supported and anchored structures included in this Opinion are: docks and piers, boatlifts, mooring piles and dolphin piles associated with docks/piers; ATONs and PATONs; floating docks; pile-supported chickees (i.e., small, back-country, over-water, pile-supported, primitive camping shelters); boardwalks (as long as they are designed and clearly marked to prohibit fishing and vessel mooring); mooring fields and buoys; and other minor pile-supported structures. This does not include structures that support large commercial vessels including ferries, tankers, and cargo ships such as ferry terminals and large ports.
- A2.1.2. Pile-supported docks/piers for a single-family residential lot are limited to 4 slips for motorized vessels. Slips for non-motorized vessels (e.g., kayak, canoe, and paddleboard) and associated launching areas do not count toward the total slip number.
- A2.1.3. Pile-supported structures for marinas, multi-family facilities (e.g., condo complexes, trailer parks, subdivisions when the homeowners association owns and controls the in-water structures). Docks and piers for multi-family residential properties (e.g., condos, trailer parks, apartment complexes), and marinas are limited to a maximum of 50 total slips (i.e., combination of wet and dry slips for existing plus proposed slips).
- A2.1.4. Anchored buoys and temporary pile-supported structures associated with marine events. Upon completion of the event, these structures must be removed and, to the maximum extent practical, the site must be restored to pre-construction elevations. Water depths in the area of marine events must be deep enough to support at least 5 ft of water depth under the keel of a vessel and between the keel of a vessel and ESA-listed coral colonies when transiting to the mooring areas. There is no limit on the number of vessel slips allowed for temporary structures associated marine events such as boat shows.
- A2.1.5. Mooring fields are limited to a maximum of 50 motorized vessels (there is no limit on the number of non-motorized vessels).
- A2.1.6. All pile-supported structures constructed must comply with PDC 2.17 for *Docks or Other Minor Structures Constructed in Florida Under this Opinion* (see below).

The following PDCs apply to all the activities described in PDC A2.1 above:

A2.2. For commercial, multi-family, or public facilities, and marine events, signs must be posted in a visible location(s), alerting users of listed species in the area susceptible to vessel strikes and hook-and-line captures. The most current version of the signs that must be downloaded and sign installation guidance are available at:

(http://sero.nmfs.noaa.gov/protected_resources/section_7/protected_species_educational_signs/index.html). The signs required to be posted by area are stated below:

- A2.2.1. All projects in Florida shall use the Save Sea Turtle, Sawfish, and Dolphin sign. These signs shall include contact information to the sea turtle and marine

- mammal stranding networks and smalltooth sawfish encounter database.
- A2.2.2. Projects within the North Atlantic right whale educational sign zone (as defined in Section 2.1.1.4) shall post the Help Protect North Atlantic Right Whales sign.
 - A2.2.3. On the east coast of Florida, projects located within the St. John's River and those occurring north of the St. Johns River to the Florida-Georgia line shall post the Report Sturgeon sign. On the west coast of Florida, projects occurring from the Cedar Key, Florida north to the Florida-Alabama line.
 - A2.2.4. We are still developing the signs to be used in the U.S. Caribbean. Once developed, those signs will be included at the website above.

A2.3. For commercial, multi-family, or public facilities, monofilament recycling bins must be provided at the docking facility to reduce the risk of turtle or sawfish entanglement in, or ingestion of, marine debris. Monofilament recycling bins must:

- A2.3.1. Be constructed and labeled according to the instructions provided at <http://mrrp.myfwc.com>.
- A2.3.2. Be maintained in working order and emptied frequently (according to <http://mrrp.myfwc.com> standards) so that they do not overflow.

A2.4. For any dock project (new construction, repair, or replacement) at a private residence located within 11 nautical miles of North Atlantic right whale critical habitat (as measured in a radius from the center of the nearest inlet to open ocean and described in Section 2.1.1.4), the property owner will be provided a handout with their USACE permit describing the presence of North Atlantic right whales in the area and the Federal regulations governing the approach to North Atlantic right whales (Appendix C).

A2.5. ATONs and PATONs must be approved by and installed in accordance with the requirements of the USCG (see 33 CFR, chapter I, subchapter C, part 66 and RHA Section 10 and any other pertinent requirements).

A2.6. Chickees must be less than 500 ft² and support no more than 2 slips.

A2.7. No activities associated with municipal or commercial fishing piers are covered under this Opinion.

A2.8. Docks installed within visible distance of ocean beaches are required to comply with turtle-friendly lighting, if lighting is necessary to the project. Turtle-friendly lighting is explained and examples are provided on the Florida Fish and Wildlife Conservation Commission website:
<http://myfwc.com/wildlifehabitats/managed/sea-turtles/lighting/>

A2.9. Project construction will take place from uplands or from floating equipment (e.g., barge); prop or wheel-washing is prohibited.

PERMIT APPLICATION FOR:
FOUR MILE CREEK PARK
IMPROVEMENTS

PREPARED FOR:
CITY OF FREEPORT
WALTON COUNTY, FLORIDA

VICINITY MAP



PREPARED BY:



877 CR 393 NORTH, SANTA ROSA BEACH, FL 32459
 (850) 267-0759

OCTOBER 2019



LOCATION MAP

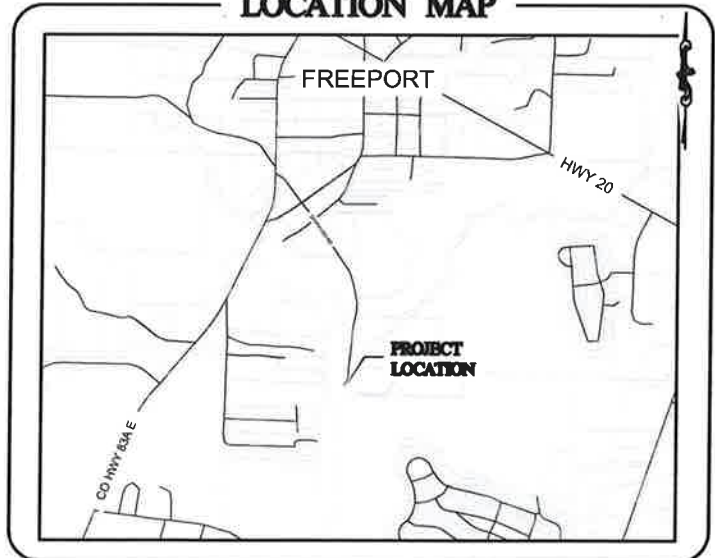

Sheet List Table

Sheet Number	Sheet Title
1	COVER SHEET
2	EXISTING CONDITIONS
3A	PROPOSED SITE PLAN
3B	PROPOSED SITE PLAN
3C	PROPOSED SITE PLAN
4A	WETLAND IMPACTS
4B	WETLAND IMPACTS
4C	WETLAND IMPACTS
5A	TYPICAL DETAILS
5B	TYPICAL DETAILS
5C	PLAN AND PROFILE
5D	PLAN AND PROFILE

CLIFFORD L. KNAUER, P.E. 53930
 EB 0008794

COVER SHEET
FOUR MILE CREEK PARK IMPROVEMENTS



Date: OCTOBER 2019	Revision:	Sketch No.:
Scale:		
Project No.:	Drawing No.:	1



877 CR 393 North
 Santa Rosa Beach, FL 32459
 850.267.0759

October 17, 2019 (Revised 8/17)
 5:\Users\jkn\OneDrive\Documents\Projects\2019\19-0008794\Four Mile Creek Park Improvements\19-0008794-0001.dwg

LEGEND

-  WATERS EDGE
-  OHWL
-  WETLAND LINE

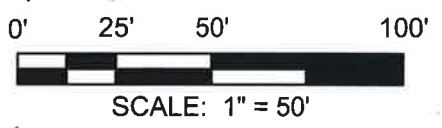
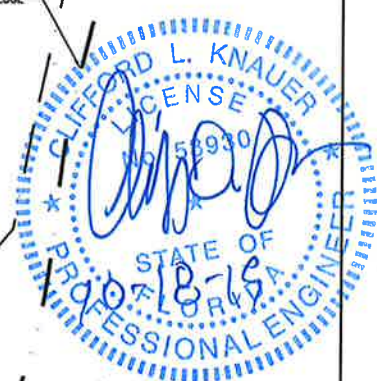
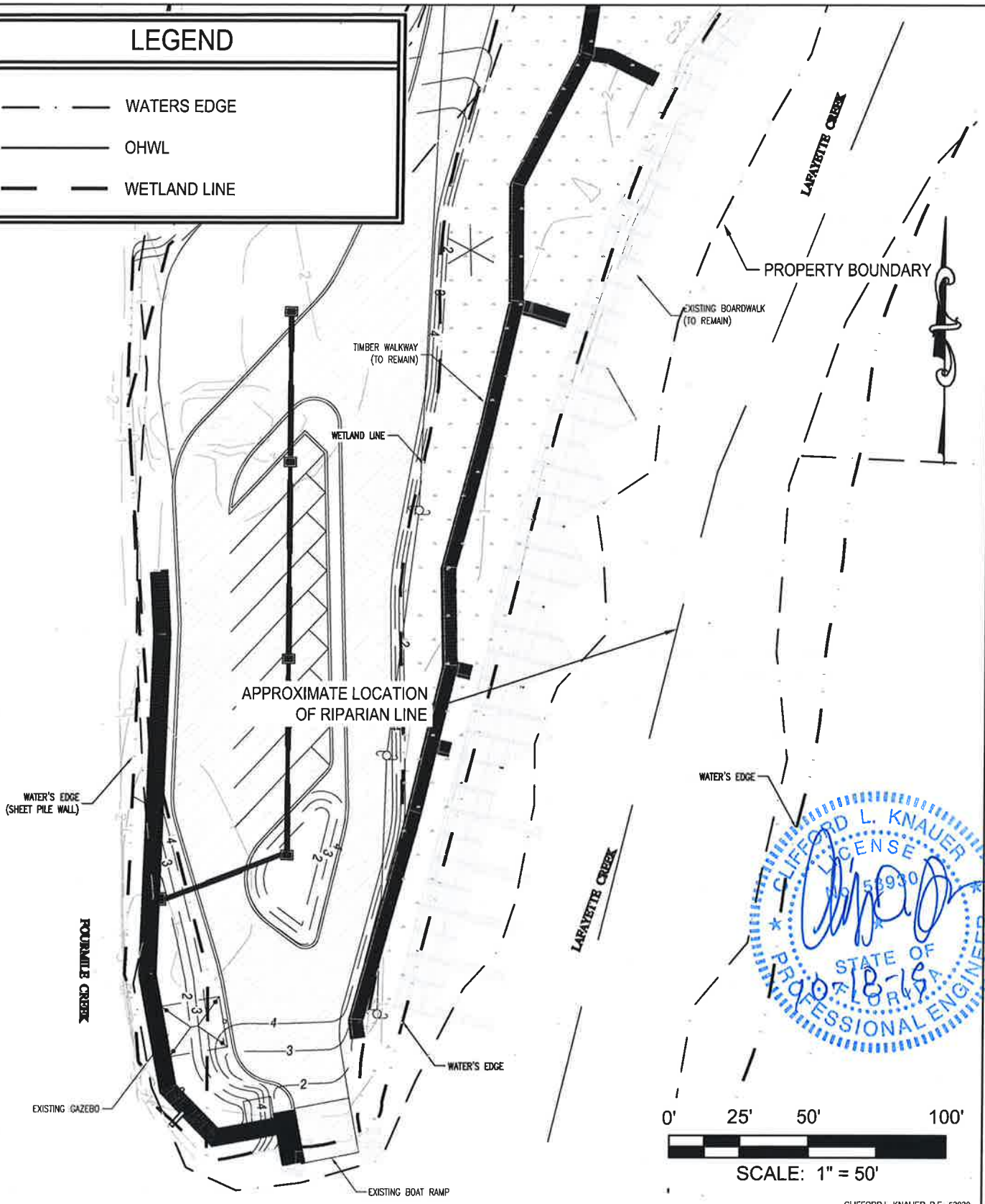

CLIFFORD L. KNAUER, P.E. 53930
EB 0008794

EXISTING CONDITIONS FOUR MILE CREEK PARK IMPROVEMENTS





877 CR 393 North
Santa Rosa Beach, FL 32459
850.267.0759

Date: OCTOBER 2019	Revision:	Sketch No.:
Scale:		
Project No.:	Drawing No.:	2

October 17, 2019 (October 2019)
S:\Projects\2019\20190417_Four Mile Creek Park Improvements\Drawings\2019-10-17_Four Mile Creek-Existing.dwg

LEGEND

-  WATERS EDGE
-  OHWL
-  WETLAND LINE



MATCHLINE - SEE SHEET 3C

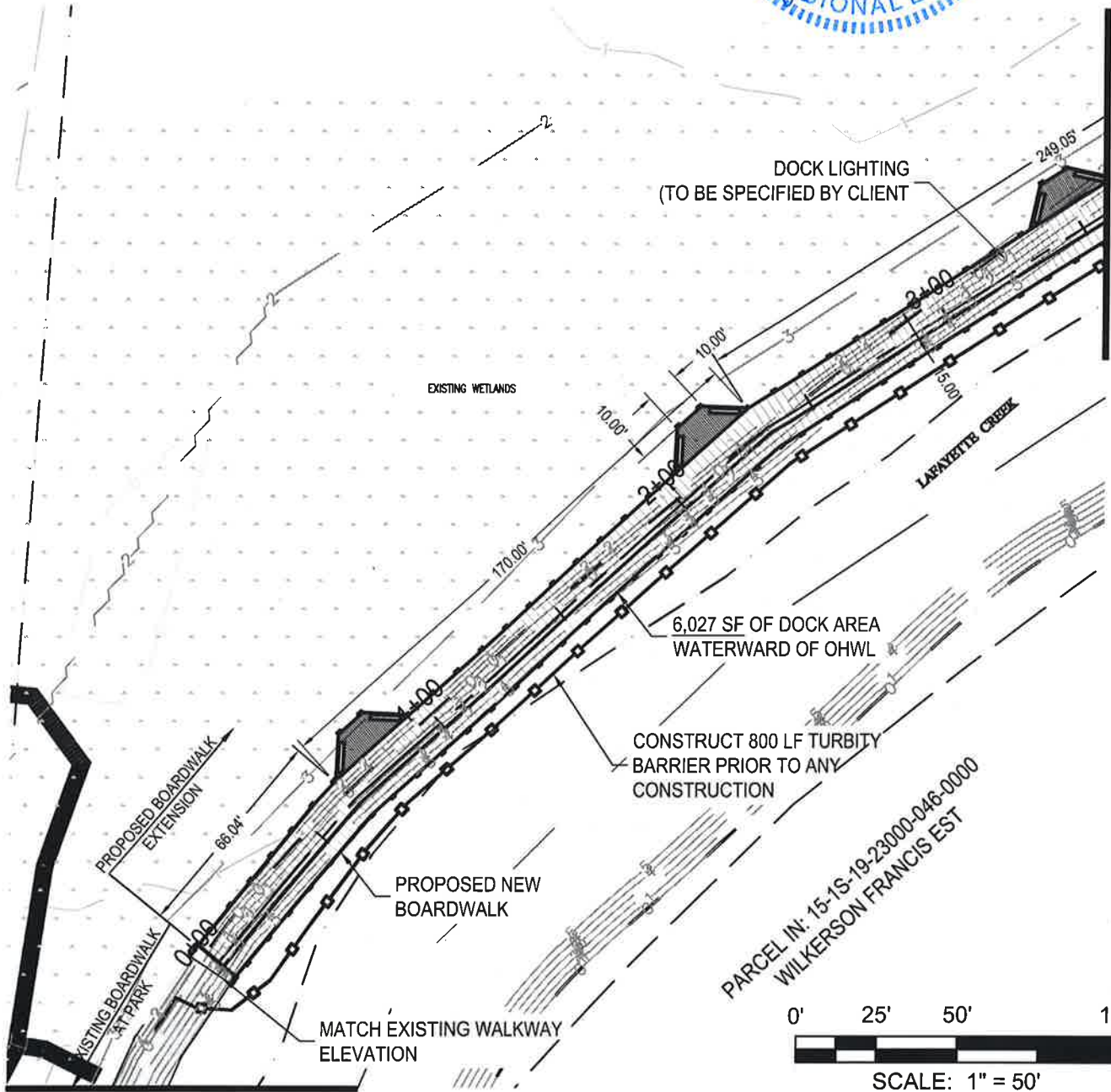

MATCHLINE - SEE SHEET 3A

CLIFFORD L. KNAUER, P.E. 53930
EB 0008794

PROPOSED SITE PLAN FOUR MILE CREEK PARK IMPROVEMENTS





877 CR 393 North
Santa Rosa Beach, FL 32459
850.267.0759

Date: OCTOBER 2019	Revision:	Sketch No.:
Scale:		
Project No.:	Drawing No.:	3B

October 16, 2019 (08:03:54 AM)
C:\Users\cna\OneDrive\Documents\Projects\15-15-19-23000-046-0000\15-15-19-23000-046-0000.dwg

LEGEND

-  WATERS EDGE
-  OHWL
-  WETLAND LINE



PARCEL IN: 15-1S-19-23000-037-0000
REESE LESLIE B

PARCEL IN: 15-1S-19-23000-034-0000
CITY OF FREEPORT

APPROXIMATE LOCATION
OF RIPARIAN LINE

PROPERTY BOUNDARY

DISTANCE TO PROPERTY LINE = 189.74'
(LENGTH OF SHORELINE = 202.45')

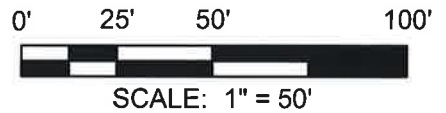
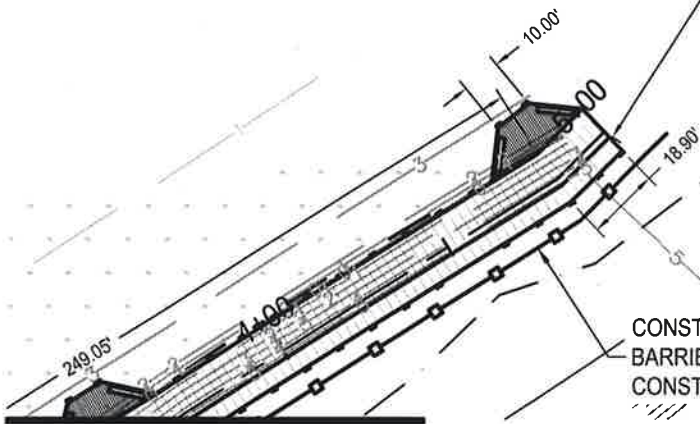

MATCHLINE - SEE SHEET 3B

CLIFFORD L. KNAUER, P.E. 53930
EB 0008794

PROPOSED SITE PLAN FOUR MILE CREEK PARK IMPROVEMENTS







877 CR 393 North
Santa Rosa Beach, FL 32459
850.267.0759

Date: OCTOBER 2019	Revision:	Sketch No.:
Scale:		
Project No.:	Drawing No.:	3C

October 18, 2019 (Revised 10/18/19)
S:\Projects\2019\15-1S-19-23000-034-0000\Four Mile Creek Park Improvements\15-1S-19-23000-034-0000.dwg

LEGEND

-  WATERS EDGE
-  OHWL
-  WETLAND LINE
-  WETLAND IMPACTS

WETLAND IMPACT SUMMARY

WETLAND IMPACT No. 1	151 SF / 0.003 ACRES
WETLAND IMPACT No. 2	5610 SF / 0.13 ACRES
TOTAL:	5761 SF / 0.133 ACRES

MATCHLINE - SEE SHEET 3C

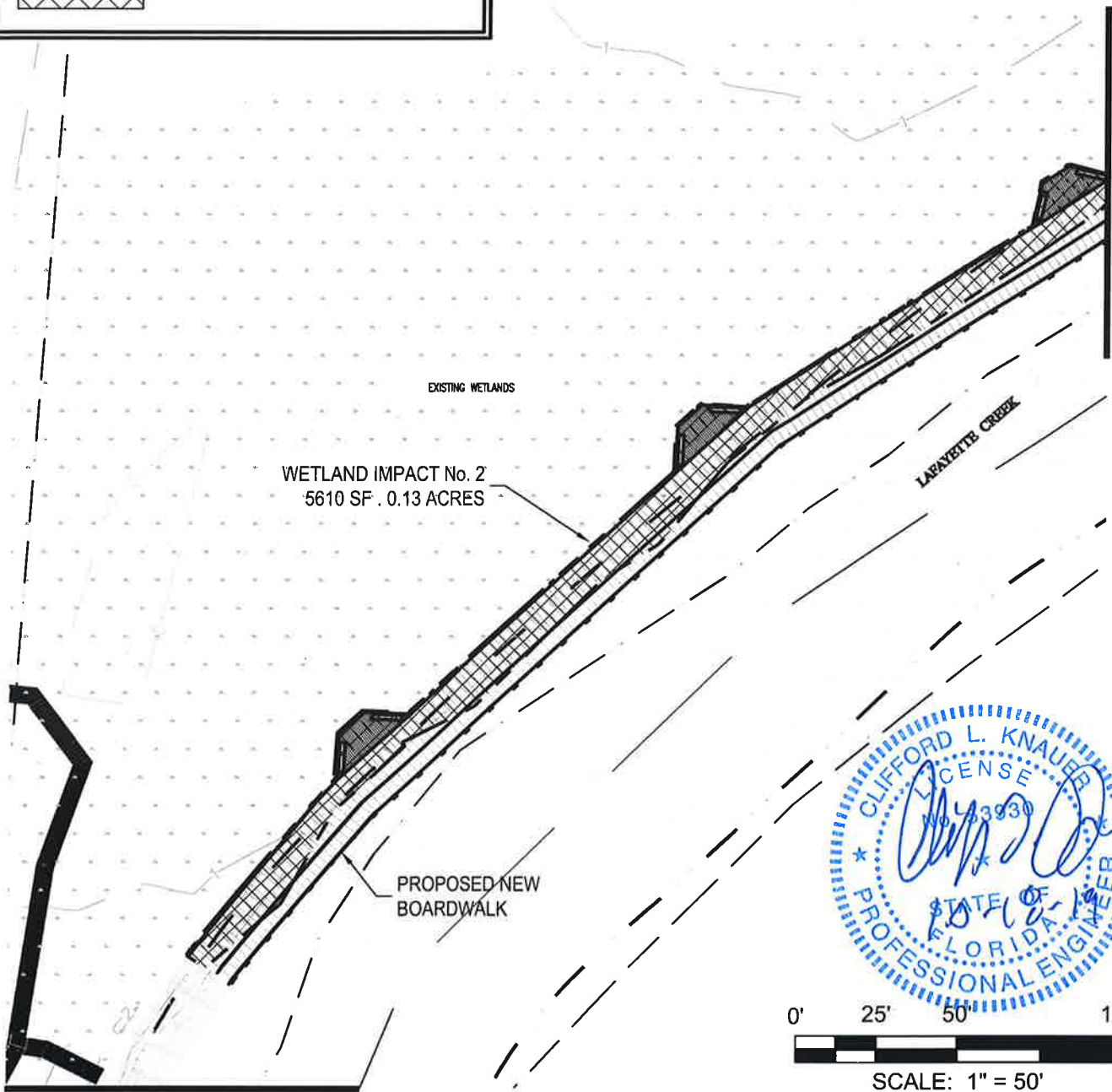

0' 25' 50' 100'

SCALE: 1" = 50'

CLIFFORD L. KNAUER, P.E. 53930
EB 0008794





WETLAND IMPACTS FOUR MILE CREEK PARK IMPROVEMENTS



877 CR 393 North
Santa Rosa Beach, FL 32459
850.267.0759

Date: OCTOBER 2019	Revision:	Sketch No.:
Scale:		
Project No.:	Drawing No.:	
	4B	

LEGEND

-  WATERS EDGE
-  OHWL
-  WETLAND LINE
-  WETLAND IMPACTS

WETLAND IMPACT SUMMARY

WETLAND IMPACT No. 1	151 SF / 0.003 ACRES
WETLAND IMPACT No. 2	5610 SF / 0.13 ACRES
TOTAL:	5761 SF / 0.133 ACRES



PARCEL IN: 15-1S-19-23000-037-0000
REESE LESLIE B

APPROXIMATE LOCATION
OF RIPARIAN LINE

PARCEL IN: 15-1S-19-23000-034-0000
CITY OF FREEPORT

PROPERTY BOUNDARY

WETLAND IMPACT No. 2
5610 SF .0.13 ACRES

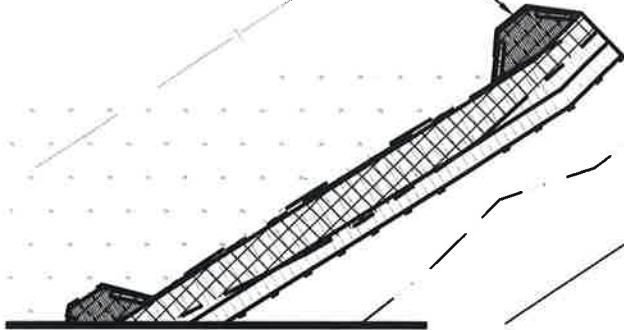

MATCHLINE - SEE SHEET 3B

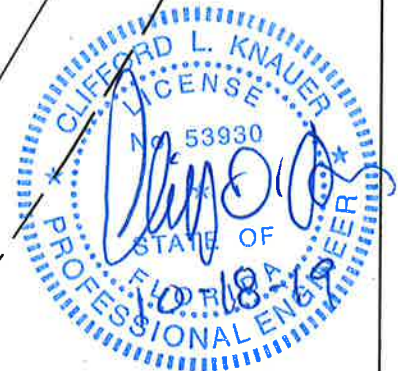

0' 25' 50' 100'



SCALE: 1" = 50'

CLIFFORD L. KNAUER, P.E. 53930
EB 0008794

WETLAND IMPACTS FOUR MILE CREEK PARK IMPROVEMENTS



877 CR 393 North
Santa Rosa Beach, FL 32459
850.267.0759

Date: OCTOBER 2019	Revision:	Sketch No.:
Scale:		
Project No.:	Drawing No.:	
	4C	

October 17, 2019 (Revision 03)
 C:\Users\jknauer\OneDrive\Documents\Projects\2019\15-1S-19-23000-034-0000\Four Mile Creek Park Improvements\Drawings\4C.dwg

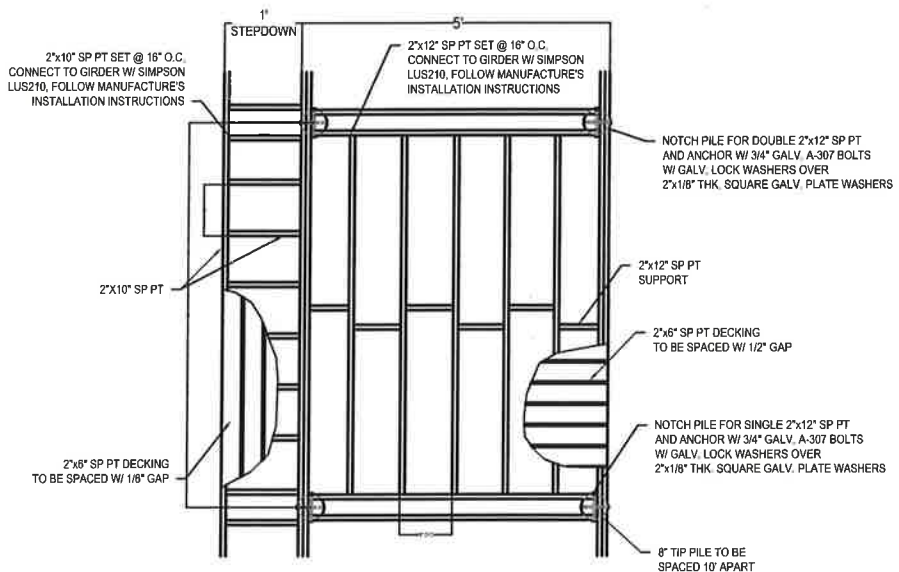

TIMBER DOCK PLAN VIEW

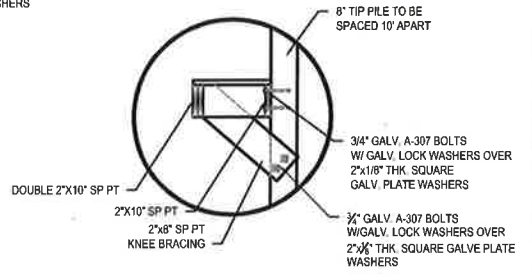

KNEE BRACING DETAIL

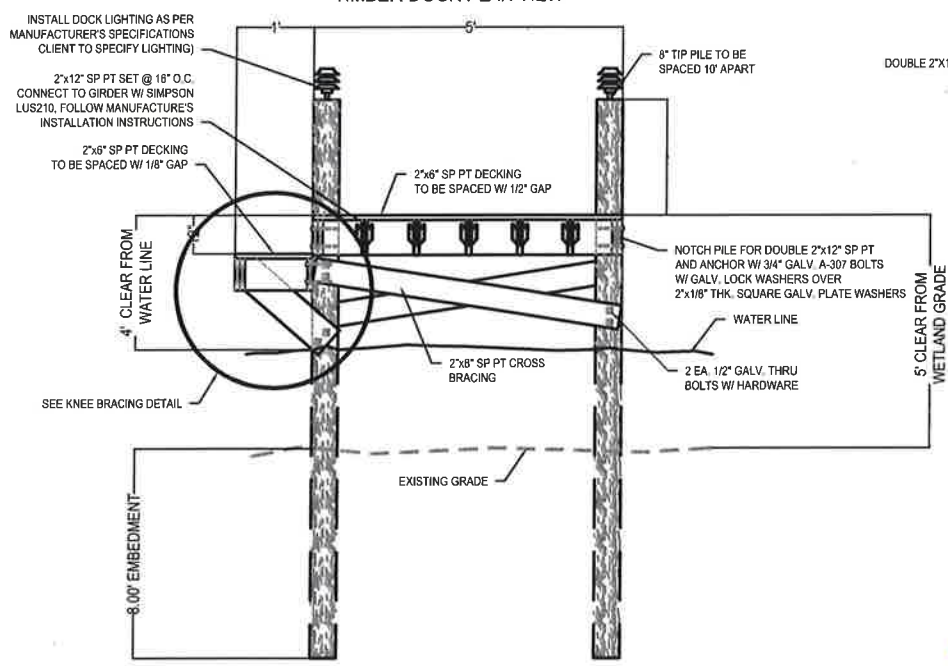

TIMBER DOCK SECTION VIEW



CLIFFORD L. KNAUER, P.E. 53930
EB 0008794

TYPICAL DETAILS
FOUR MILE CREEK PARK IMPROVEMENTS

Date: OCTOBER 2019	Revision:	Sketch No.:
Scale:		
Project No.:	Drawing No.:	
	5A	



877 CR 393 North
Santa Rosa Beach, FL 32459
850.267.0759

October 17, 2019 (October 2019)
S:\PROJECTS\2019\20190417_FOUR MILE CREEK PARK IMPROVEMENTS\DRAWINGS\TYPICAL DETAILS\TYPICAL DETAILS - FOUR MILE CREEK IMPROVEMENTS.dwg

October 17, 2019 (Checked BY) [Signature]
 5:15pm
 5:15pm
 5:15pm

- CONSTRUCTION NOTE:**
1. ALL WOOD FRAMING MEMBERS SHALL BE PRESSURE TREATED WITH A MINIMUM RETENTION LEVEL OF 0.40 LBS./CU. FT.
 2. ALL THRU-BOLTS AND CARRIAGE BOLTS ARE TO HAVE MIN. 2" GALV. WASHER EACH SIDE.

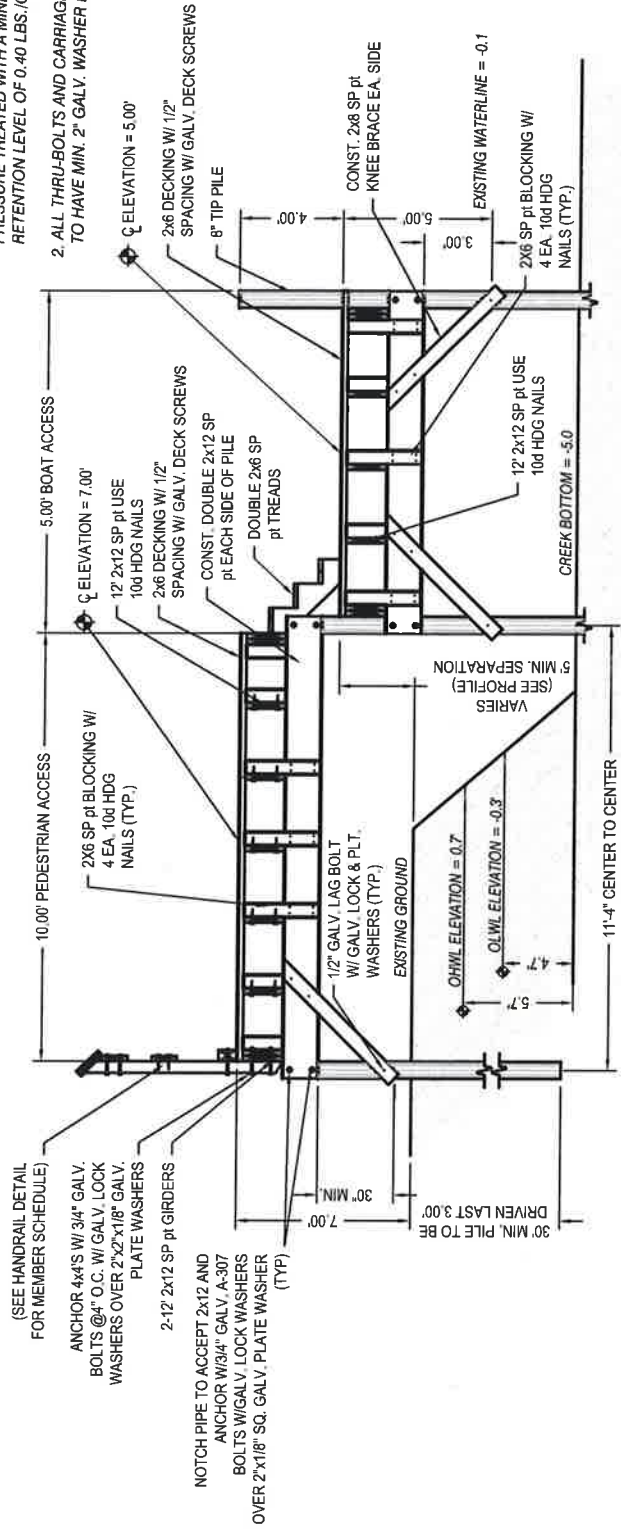

TYPICAL BOARDWALK SECTION
N.T.S.



CLIFFORD L. KNAUER, P.E. 53930
EB 0008794

TYPICAL DETAILS
FOUR MILE CREEK PARK IMPROVEMENTS



877 CR 393 North
Santa Rosa Beach, FL 32459
850.267.0759

Date: OCTOBER 2019	Revision:	Sketch No.:
Scale:		
Project No.:	Drawing No.:	
	5B	



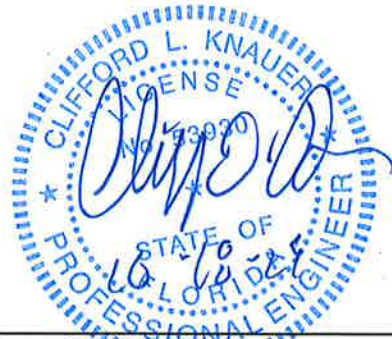
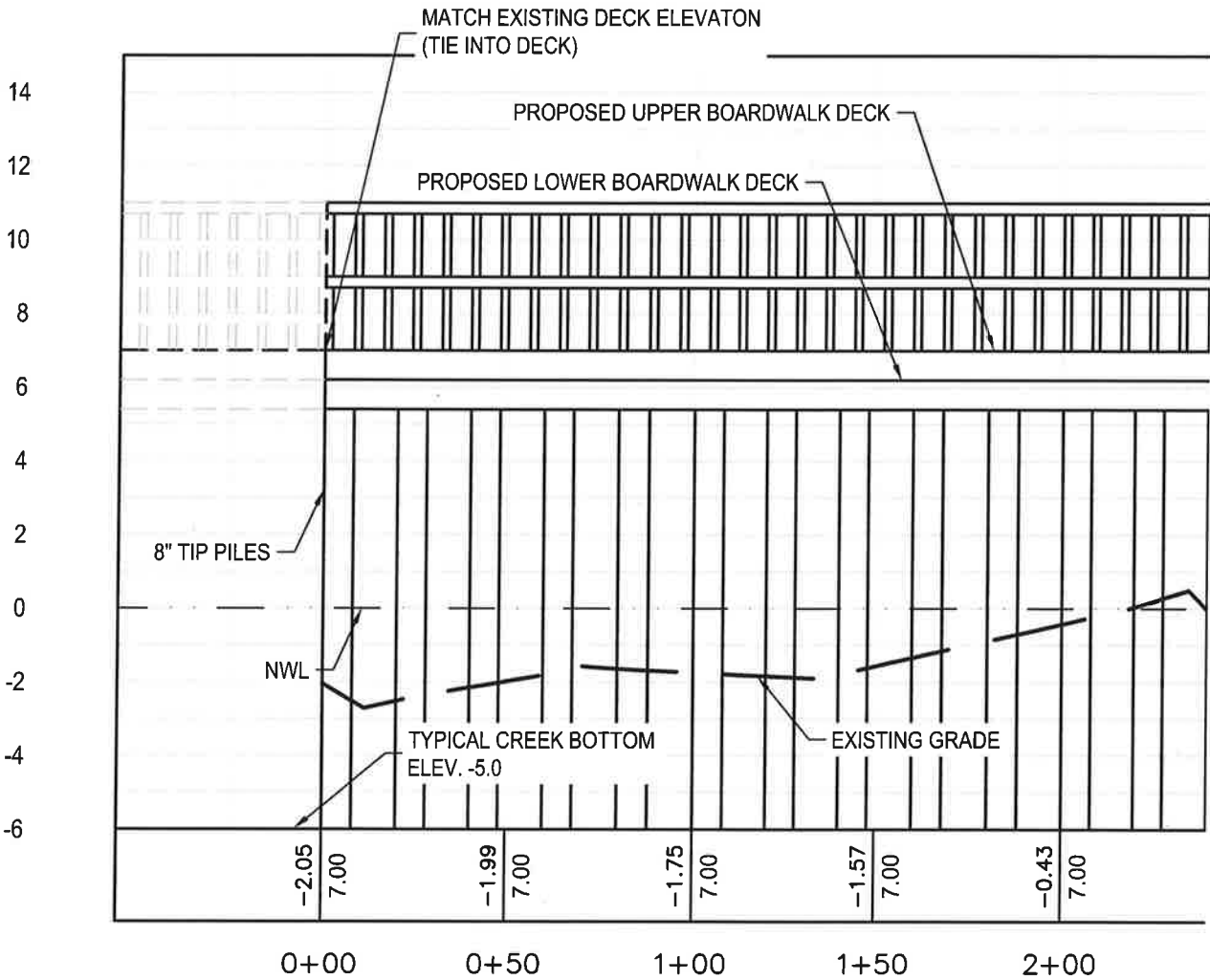

0' 25' 50' 100'



SCALE: 1" = 50'

CLIFFORD L. KNAUER, P.E. 53930
EB 0008794

PLAN AND PROFILE
FOUR MILE CREEK PARK IMPROVEMENTS

Date: OCTOBER 2019	Revision:	Sketch No.:
Scale:		
Project No.:	Drawing No.:	
	5C	



877 CR 393 North
Santa Rosa Beach, FL 32459
850.267.0759

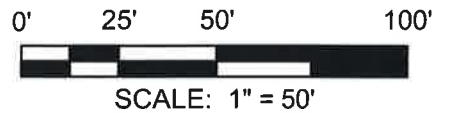
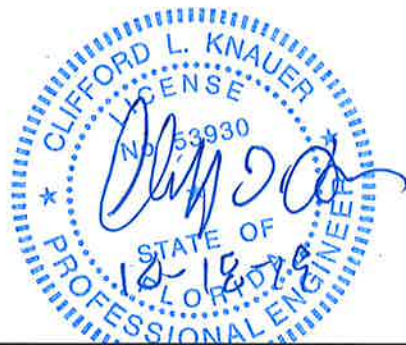
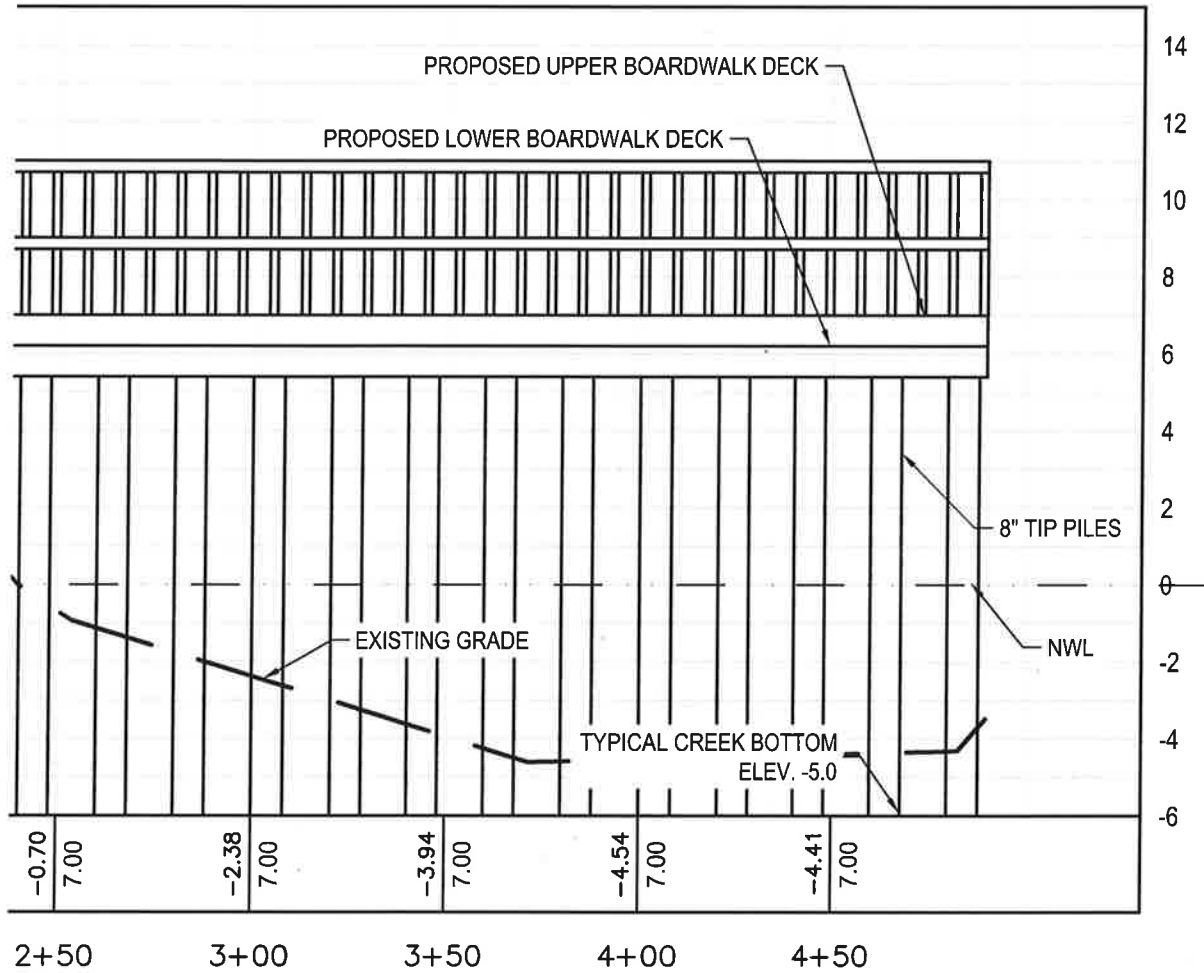

CLIFFORD L. KNAUER, P.E. 53930
EB 0008794

PLAN AND PROFILE
FOUR MILE CREEK PARK IMPROVEMENTS

Date: OCTOBER 2019	Revision:	Sketch No.:
Scale:		
Project No.:	Drawing No.:	5D



877 CR 393 North
Santa Rosa Beach, FL 32459
850.267.0759